

T.6S., R.2W., W.M

Tax Lot 2200

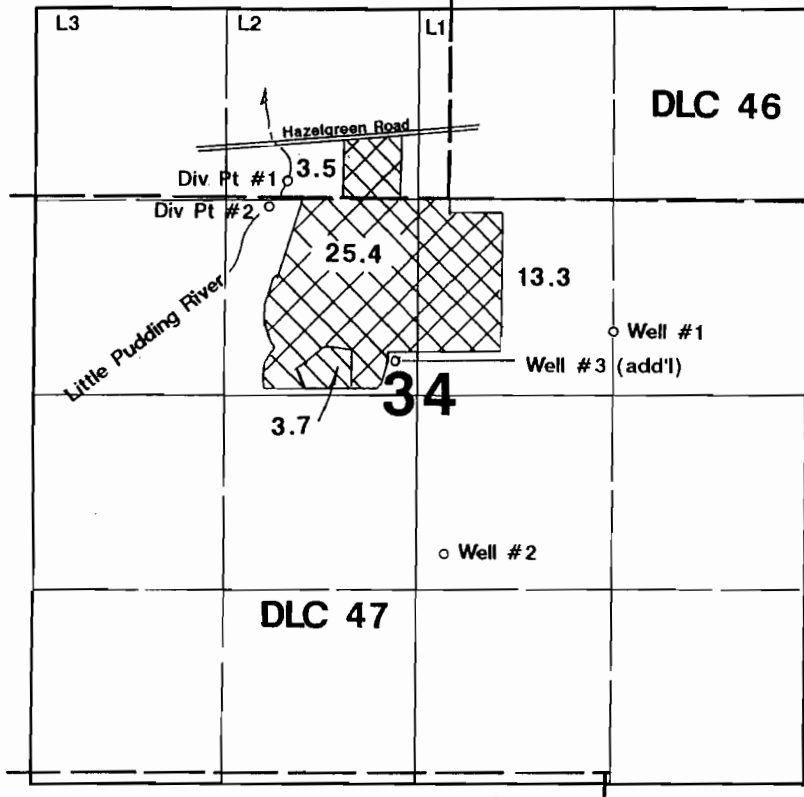

RECEIVED

JUN 29 2007

WATER RESOURCES DEPT
SALEM, OREGON

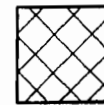

Div. Pt.-Primary
Wells-Supplemental



Wells-Primary

Div. Pt. #1: Permit #18593; Div. Pt. #2: Permits #24613 & #32544

Well #1 is located 420°N & 1320°E

Well #2 is located 1070°S & 200°E

Well #3 (add'l) is located 250°N & 150°W—all from the center of Section 34.

Application Map

Wilbur A. Klopfenstein

Application #: G-14795 Permit #: G-13696

Permit Amendment

This Map Was Prepared For The Purpose Of Identifying The Location Of A Water Right Only And Is Not Intended To Provide Legal Dimensions Or Location Of Property Ownership Lines.

