

T 5N & T 6N R 35 W.M.

Application No. G-14878

Permit No. G-13727

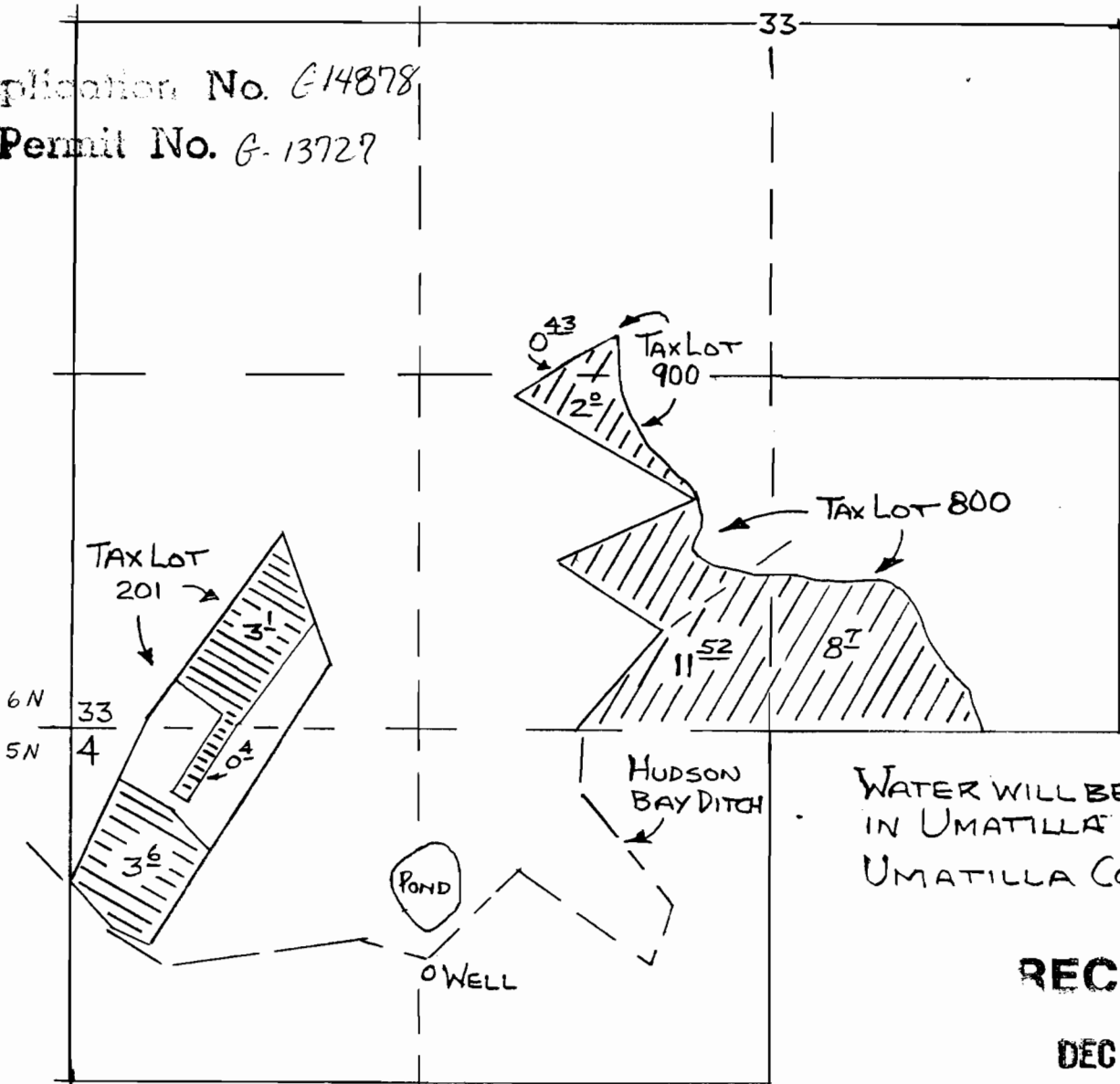

WATER WILL BE USED
IN UMATILLA BASIN
UMATILLA COUNTY

RECEIVED

DEC 15 1998

WATER RESOURCES DEPT.
SALEM, OREGON

WELL LOCATION: 930' SO. AND 1355' E OF NW COR. SEC 4

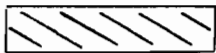

PRIMARY (7.1A)

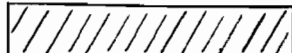

SUPPLEMENTAL (22.65A)

APPLICATION MAP
APPLICATION G 14878
PEPPER BRIDGE LAND CO.

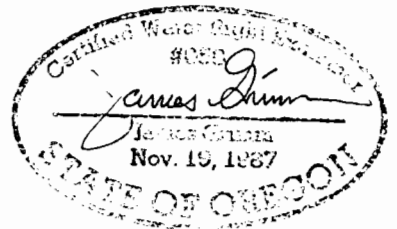

DEC 14, 1998

SCALE: 1 IN: 660 FT.

THIS MAP WAS PREPARED FOR THE PURPOSE OF IDENTIFYING THE LOCATION OF A WATER RIGHT ONLY AND IS NOT INTENDED TO PROVIDE LEGAL DIMENSIONS OR LOCATION OF PROPERTY OWNERSHIP LINES.