

T.7S. R.1E. Section 10, W.M.

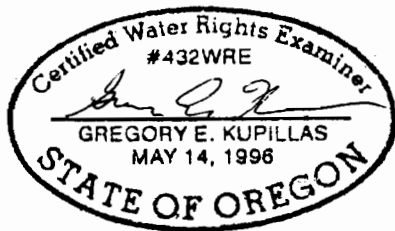

EXPIRATION DATE: 6/20/07

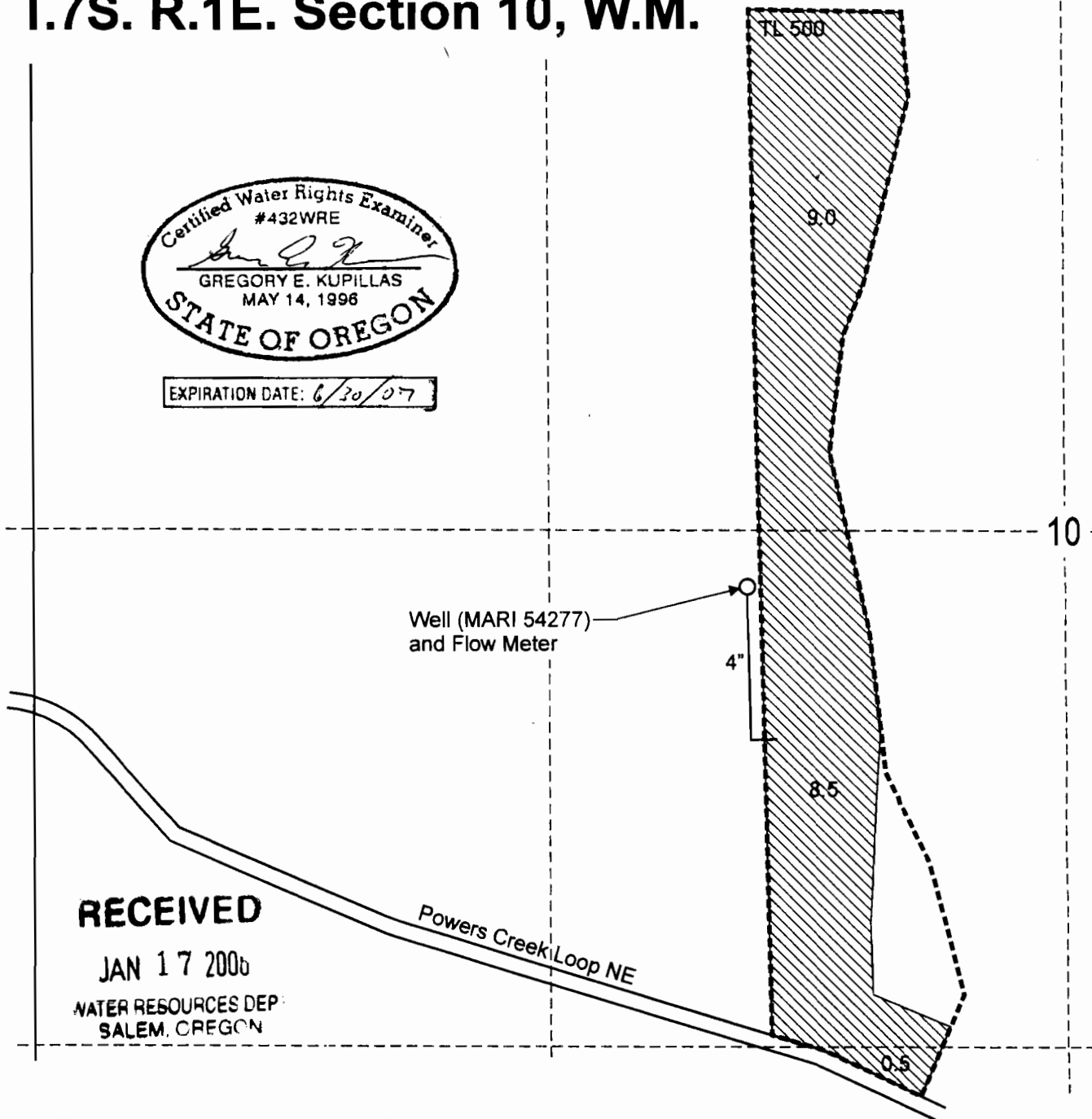

Well (MARI 54277) is located 140 feet south and 810 feet west from the C 1/4 corner, Section 10.

 Area (18.0 Acres) irrigated under Application G-15025, Permit G-13851.

 Tax lot boundary

Scale: 1" = 400'



This map was prepared for the purpose of identifying the location of a water right only and is not intended to provide legal dimensions or location of property ownership lines.



Claim of Beneficial Use Map
Application G-15025, Permit G-13851

Pacific Hydro-Geology Inc.

Jan Hupp

10/2005