

SECTION 14 T. 26 R. E. W/4

QUARTER QUARTER SECTIONS:

- NU NW 0.65 ACRES ✓
- NE NW 13.68 ACRES ✓
- SE NW 13.11 ACRES
- NU NE 9.61 ACRES ✓
- SU NE 1232 ACRES ✓
- TOTAL: 4931 ACRES

- SHADING KEY
- EXISTING WATER RIGHTS
 - PROPOSED WATER RIGHTS

WELL DATA:

WELL #1
 APPLICATION # GR-2356
 CERTIFICATE # GR-2340
 990' SOUTH
 3070' WEST
 OF NE CORNER OF
 SECTION 14 T. 26 R. E. W/4

WELL #2
 APPLICATION # GR-2357
 CERTIFICATE # GR-2339
 1310' SOUTH
 2630' WEST
 OF NE CORNER OF
 SECTION 14 T. 26 R. E. W/4

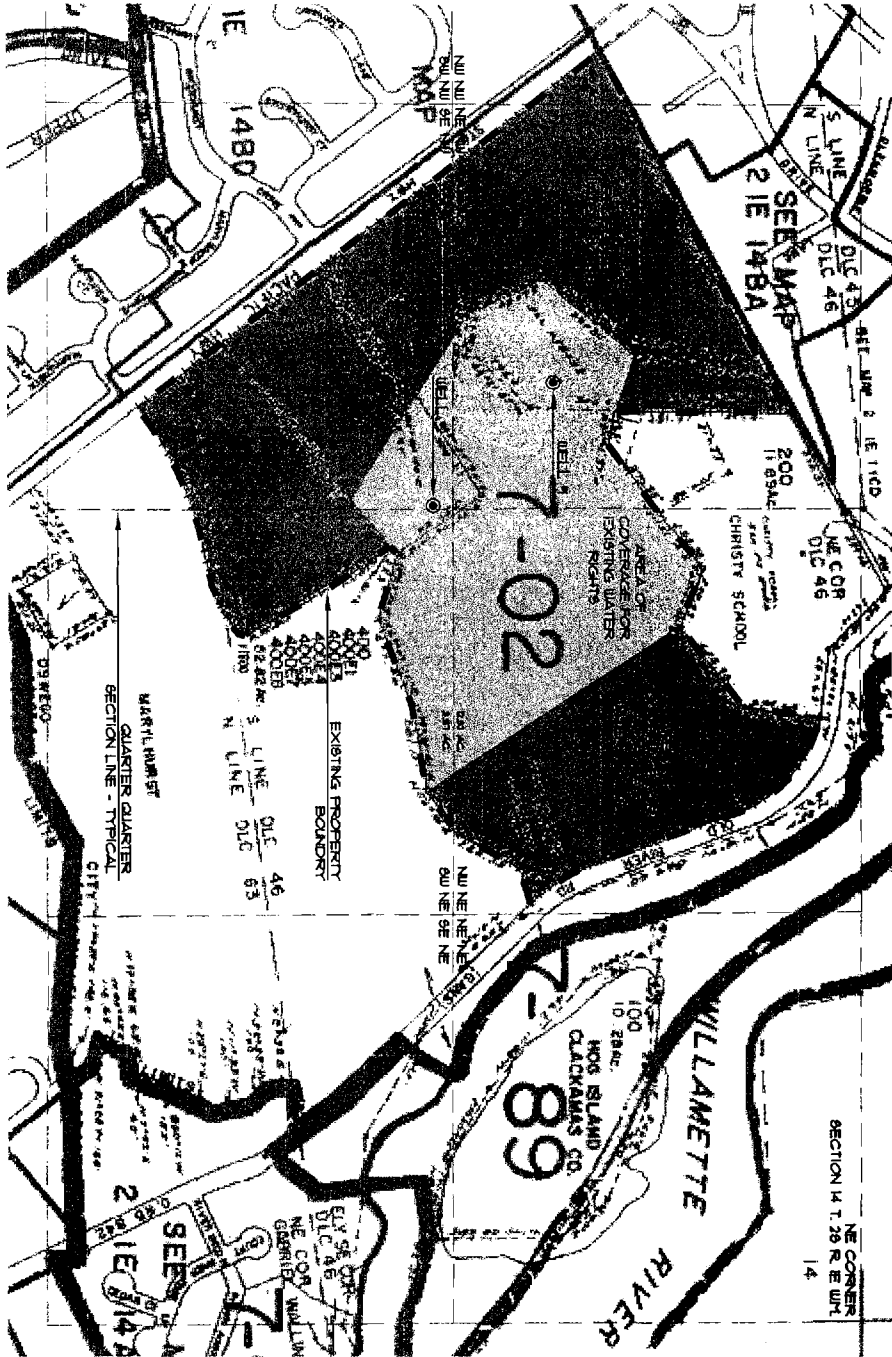

RECEIVED
 SEP 23 1983

WATER RESOURCES DIVISION
 SALEM, OREGON

Application No. G-15039
 Permit No. 9-13876

MARY'S WOODS
 GROUND WATER USE APPLICATION

LAKE OSWEGO, OREGON

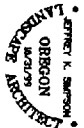

REGISTERED
 349



10450 SW Nimbus Ave., Portland, Oregon 97223
 503 863-9835 FAX: 503 863-9944

PLANNERS • ENGINEERS • LANDSCAPE ARCHITECTS • SURVEYORS

PROJECT NO.
 84N001

DATE 1.9.72/78
 DESIGNED G. FLACK
 DRAWING A. J. SAMPSON
 CHECKED J. J. SAMPSON

SHEET TITLE
 WELL LOCATION PLAN
 SHEET NUMBER

EX 1