

RSC

1303
2.20 Ac.

RECEIVED
MAR 24 1999
WATER RESOURCES DEPT.
SALEM, OREGON

RECEIVED

MAY 18 1999

WATER RESOURCES DEPT.
SALEM, OREGON

EFU-10

Application No. G-14979
Permit No. G 13854

1" = 200'
6N 35E W.M. Sec 25B
NW 1/4, NW 1/4
Twp 40T, 600, 502, 500
Service Boundary

STATE
NO. 11

RR-4

MOBILE PART

RSC

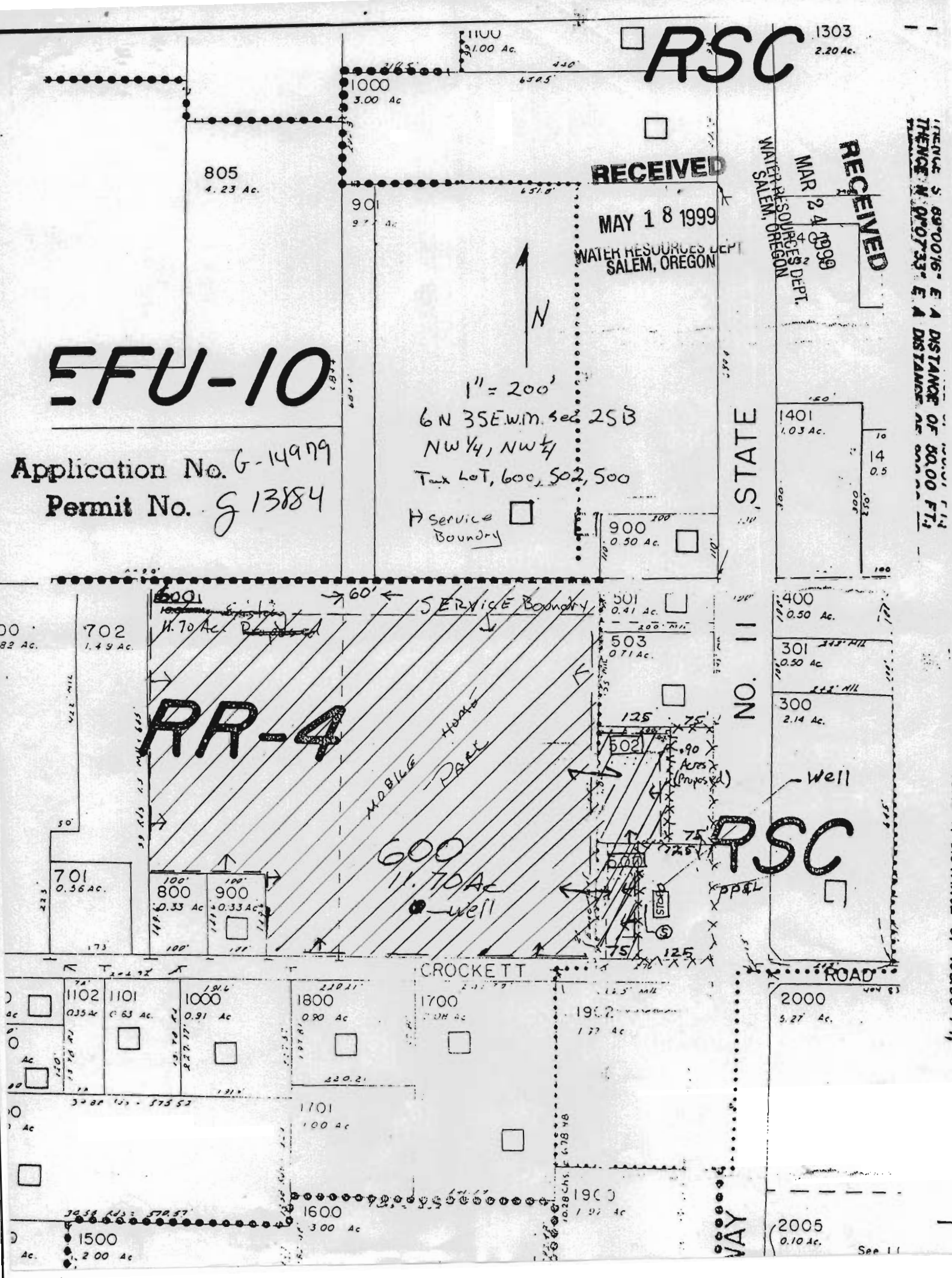

THENCE S 89°00'16" E A DISTANCE OF 80.00 FT.
THENCE N 0°07'33" E A DISTANCE OF 80.00 FT.