

Application No
Permit No.

G15146
g 13982

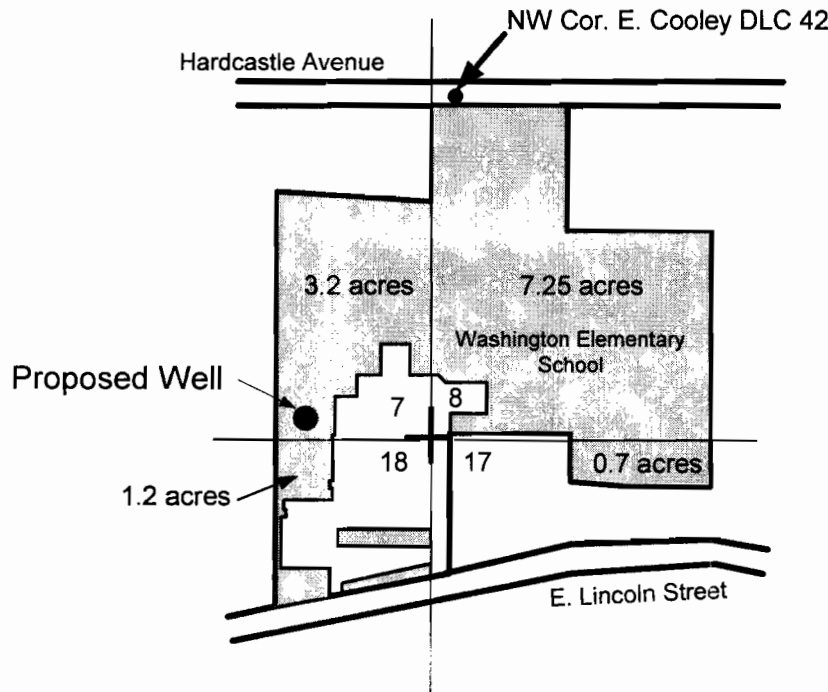
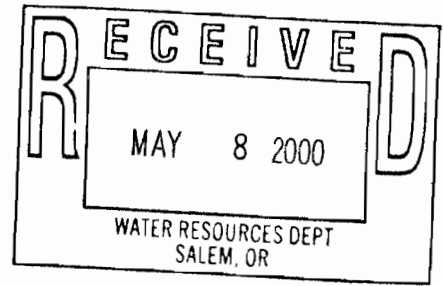

Proposed Well is 670 feet south
and 300 feet west of the NW Cor
E. Cooley DLC 42.

Scale: 1" = 400'



0 400
Feet

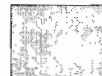

Area to be irrigated
12.35 acres

Permit Application Map

Woodburn School District No. 103
T.5S. R.1 W. Sec. 18AA, Tax Lot 100, Washington
Elementary School