

Momtazi Family, L.L.C.
T.5S. R.5W Sec. 4, 9, 10, and 16

JAN 28 2000

8 WATER RESOURCES DEPT.
 SALEM, OREGON

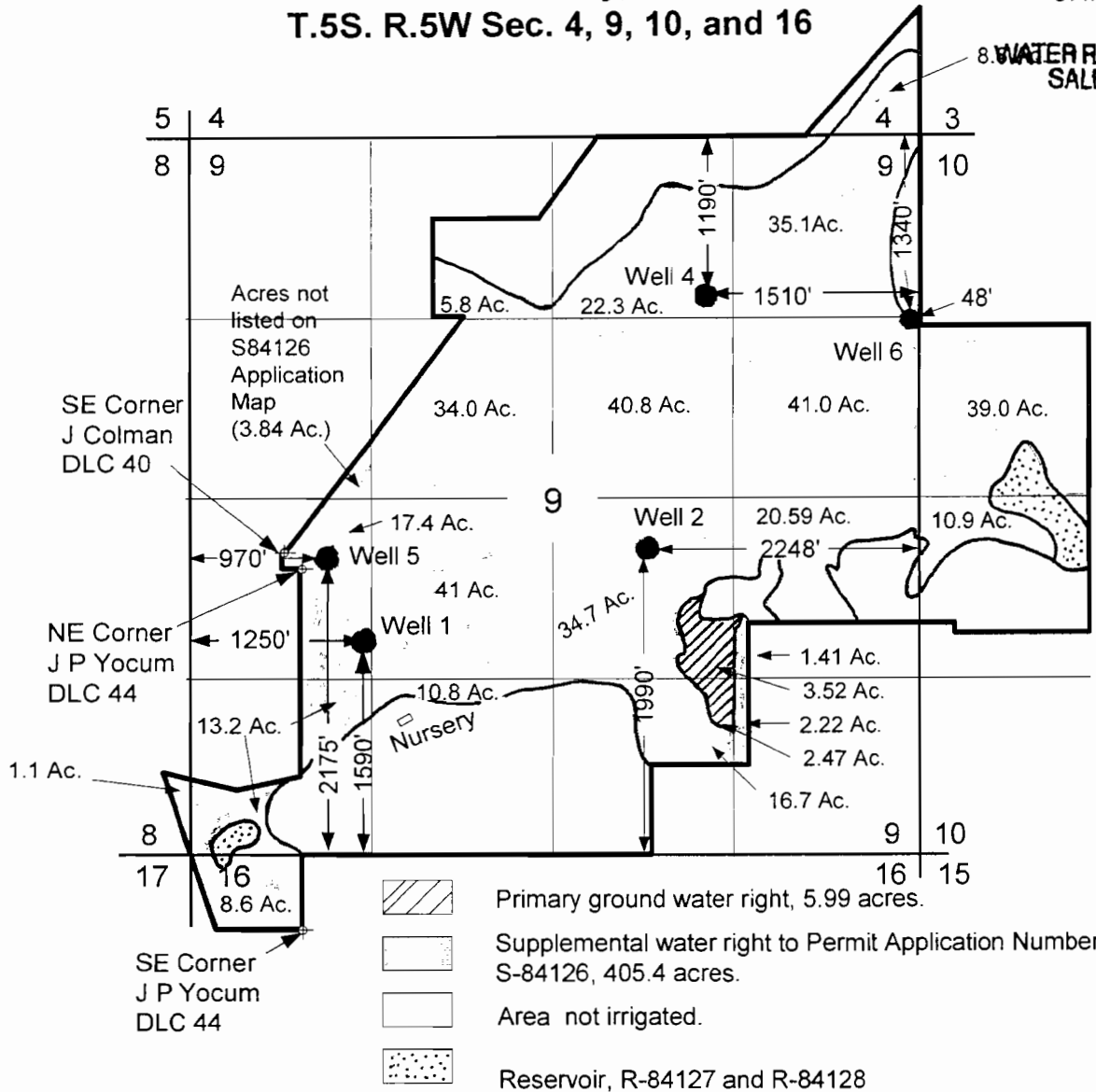

Well 1 is located 1,250 feet east and 1,590 feet north of the SW corner of Section 9.
 Well 2 is located 2,248 feet west and 1,990 feet north of the SE corner of Section 9.
 Well 3 is not a part of the supplemental water right (Well not shown on map).
 Well 4 is located 1,510 feet west and 1,190 feet south of the NE corner of Section 9.
 Well 5 is located 970 feet east and 2,175 feet north of the SW corner of Section 9.
 Well 6 is located 48 feet west and 1,340 feet south of the NE corner of Section 9.

This map was prepared for the purpose of identifying the location of a water right only and is not intended to provide legal dimensions or location of property ownership lines.

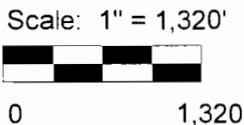

App. No. G-1508
 Permit No.

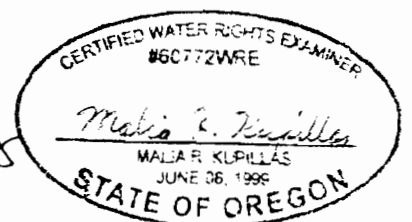

EXPIRATION DATE 12/31/2000