

1" = 400'

12 3W

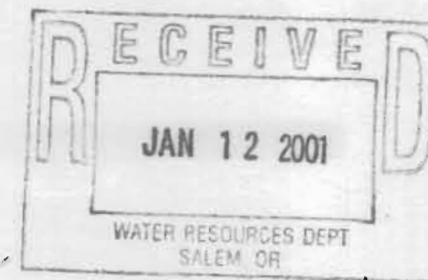

LINN



#1 well
3,071' West, 50' South
from NE Corner Sec. 27
T 12 S R 3 W

#2 well
2170' west, 45' South
of NE corner Sec. 27
T 12 S R 3 W

Kerry - I
made revision
on the same
map - 5-5-01
Thanks - RR

R.R.
note change
in coordinate
& location.

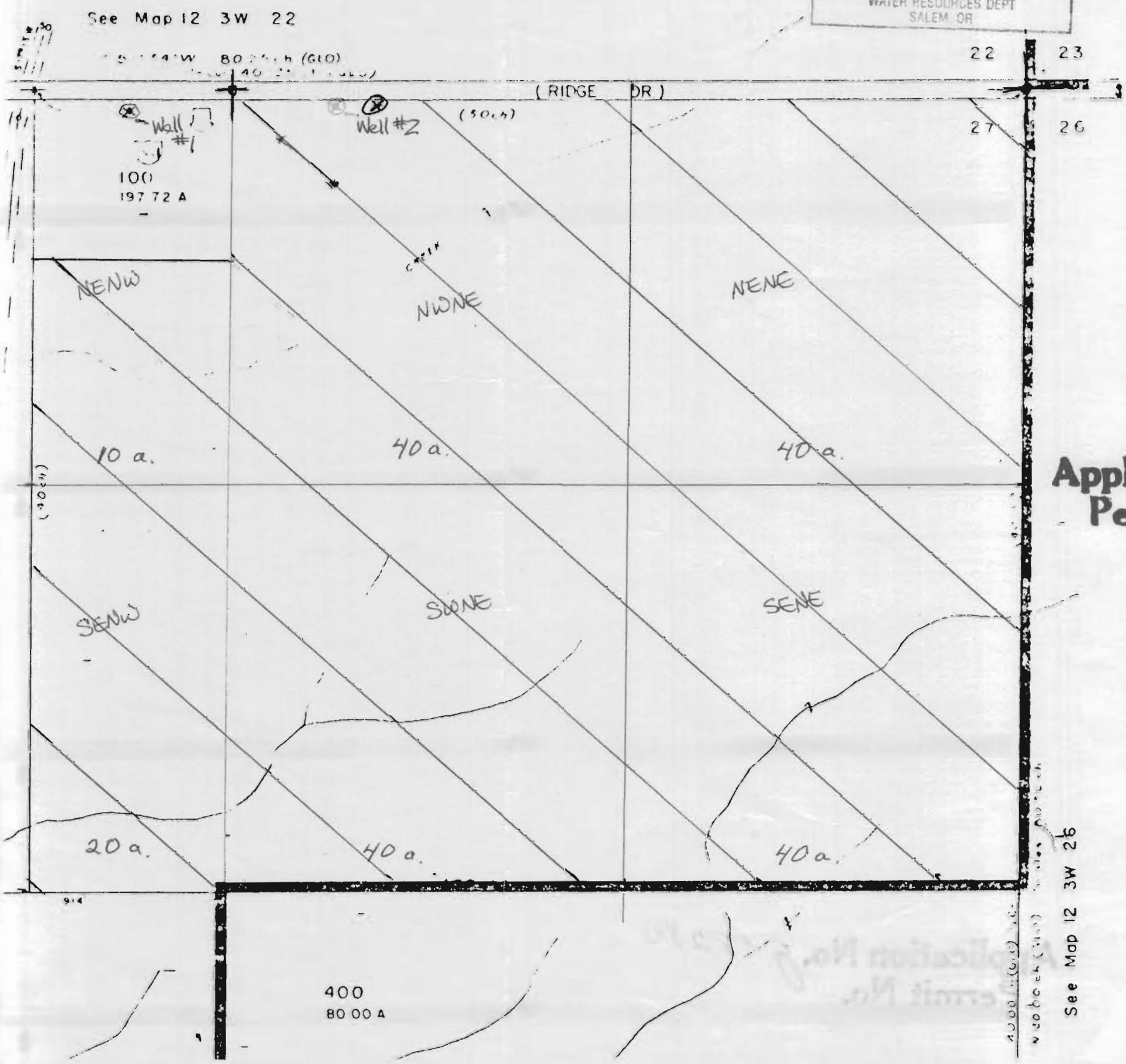

Roger Ruckent
Grd. water
Application

Application No. *915280*
Permit No.

See Map 12 3W 26