

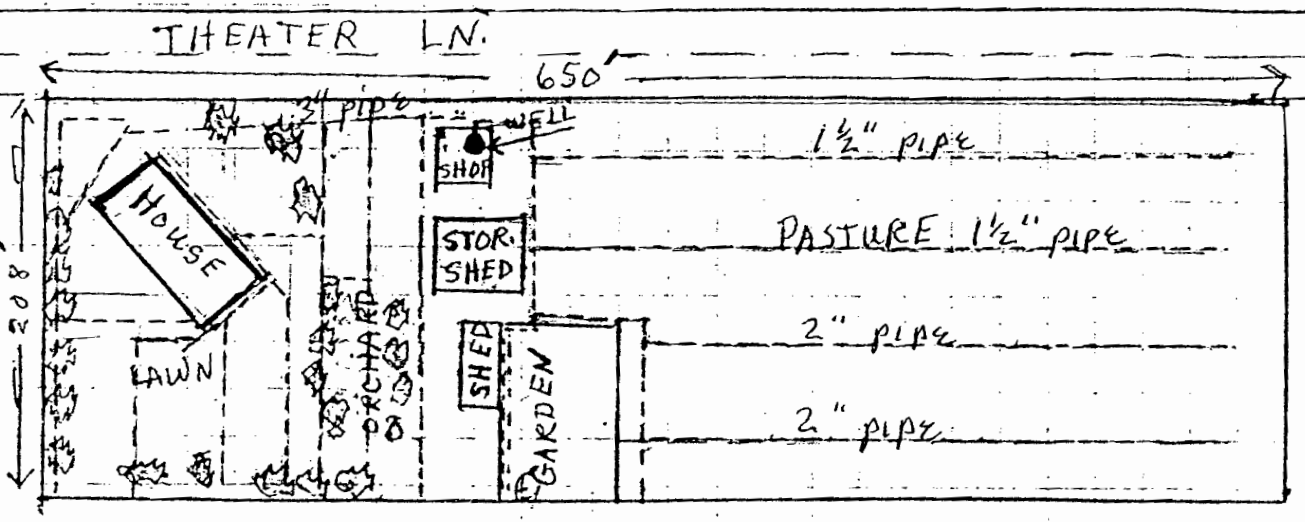

THE NORTH 208 FEET OF THE NORTHWEST QUARTER OF THE
 NORTHEAST QUARTER OF THE SOUTHEAST QUARTER OF
 SECTION 1, TOWNSHIP 4 NORTH, RANGE 28 ALL BEING
 EAST OF THE WILLAMETTE MERIDIAN IN COUNTY OF UMATILLA.
 TAX LOT 00200 2.85 ACRES

E 1/4
 CORNER



NE 1/4
 SE 1/4
 SECTION 1
 T4N R28E W.M.

WATER / SPRINKLER LINES - - - - -
 1600' MAINLINE IN PASTURE

WELL LOCATED 1150 FEET WEST AND 60 FEET SOUTH
 FROM THE EAST QUARTER CORNER OF TOWNSHIP 4 N. 28 E.
 Sec. 1.

RECEIVED

AUG 18 2000

WATER RESOURCES DEPT.
 SALEM, OREGON

Application No. 9-15274
 Permit No.

COMPILED FROM
 INFO IN THE
 FILE 9/20/00 PAK