

T 36 S, R 21 E, W.M.
SECTION 5

REVISED MAP
January 8, 2002
Feb 20, 2002 DLB

WELLS WILL BE LOCATED AS FOLLOWS:

WELL 1 - 2400 FEET SOUTH AND 3840 FEET EAST FROM THE
NW CORNER, SECTION 5.

WELL 2 - 950 FEET SOUTH AND 3840 FEET EAST FROM THE
NW CORNER, SECTION 5.

WELL 3 - IF NEEDED, 750 FEET NORTH AND 3840 FEET EAST
FROM THE SW CORNER, SECTION 5.

WELL 1A - ALTERNATE LOCATION FOR WELL 1
1940 FEET SOUTH AND 2640 FEET EAST
FROM THE NW CORNER, SECTION 5.

WELL 3A - ALTERNATE LOCATION FOR WELL 3
2000 FEET NORTH AND 2640 FEET EAST
FROM THE SW CORNER, SECTION 5.

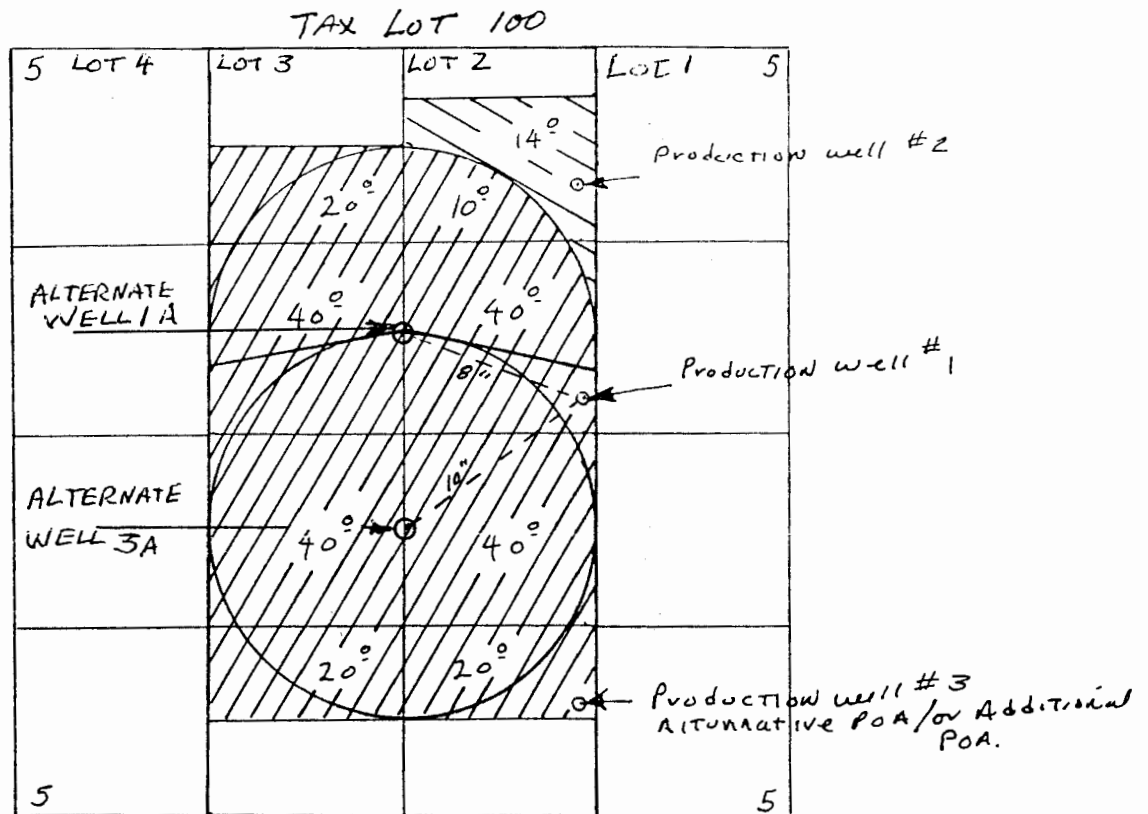

Scale - 1" = 1320'

RECEIVED

FEB 21 2002

WATER RESOURCES DEPT.
SALEM, OREGON

RECEIVED

JAN 09 2002

WATER RESOURCES DEPT.
SALEM, OREGON