

Application No. 6-15594

Permit No.

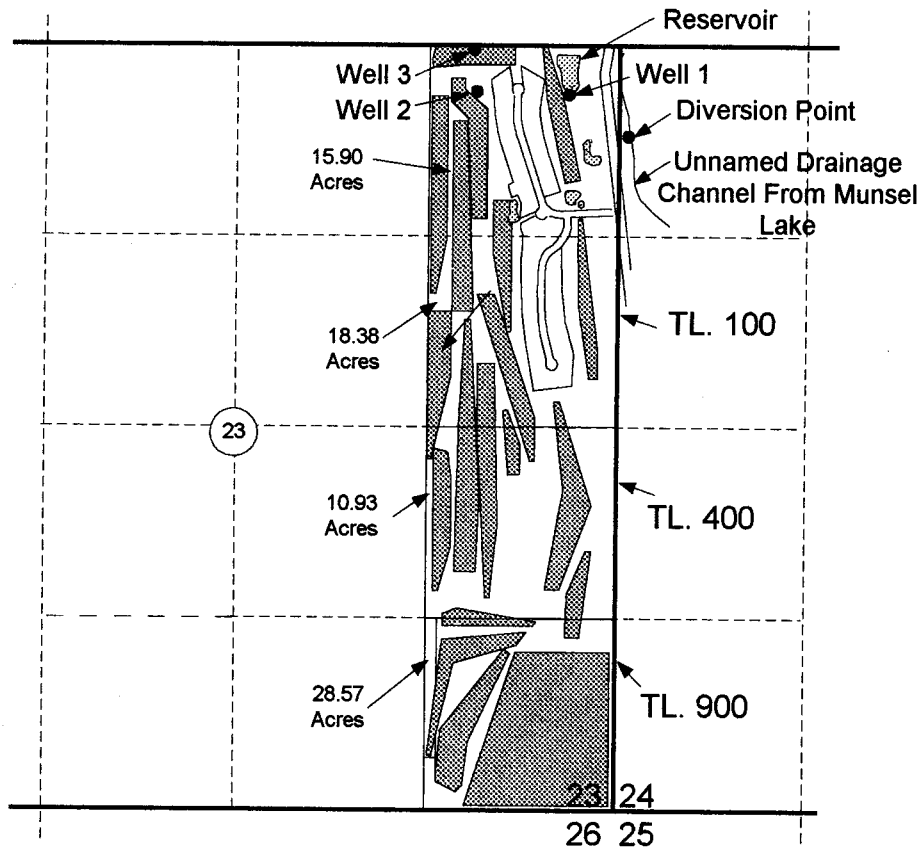

T.18S. R.12W. Sec. 23

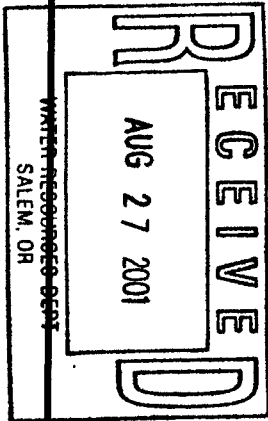

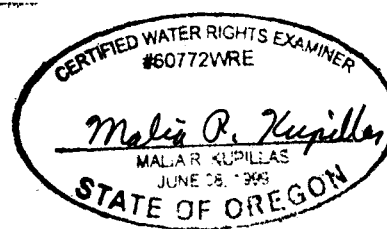
Diversion Point is located 625 feet south and 50 feet east of the northeast corner of Section 23
 Proposed Well 1 is located 325 feet south and 350 feet west of the northeast corner of Section 23.
 Proposed Well 2 is located 300 feet south and 970 feet west of the northeast corner of Section 23.
 Proposed Well 3 is located 30 feet south and 1,010 feet west of the northeast corner of Section 23



EXPIRATION: 12/31/02

-  Area (73.78 Acres) to be irrigated.
-  Pond or Reservoir

Scale: 1" = 1,320'

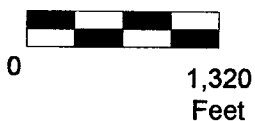

This map was prepared for the purpose of identifying the location of a water right only and is not intended to provide legal dimensions or location of property ownership lines.



Water Right Application Map

Pacific Hydro-Geology Inc.

Ocean Dunes Golf Links
T.18 S. R.12W. Sec. 23 Tax Lots 100, 400, and 900