

RECEIVED

JAN 10 2002

WATER RESOURCES DEPT.  
SALEM, OREGON

New well and all connections  
are on my  
property M

Existing 8" buried line

Existing open ditch

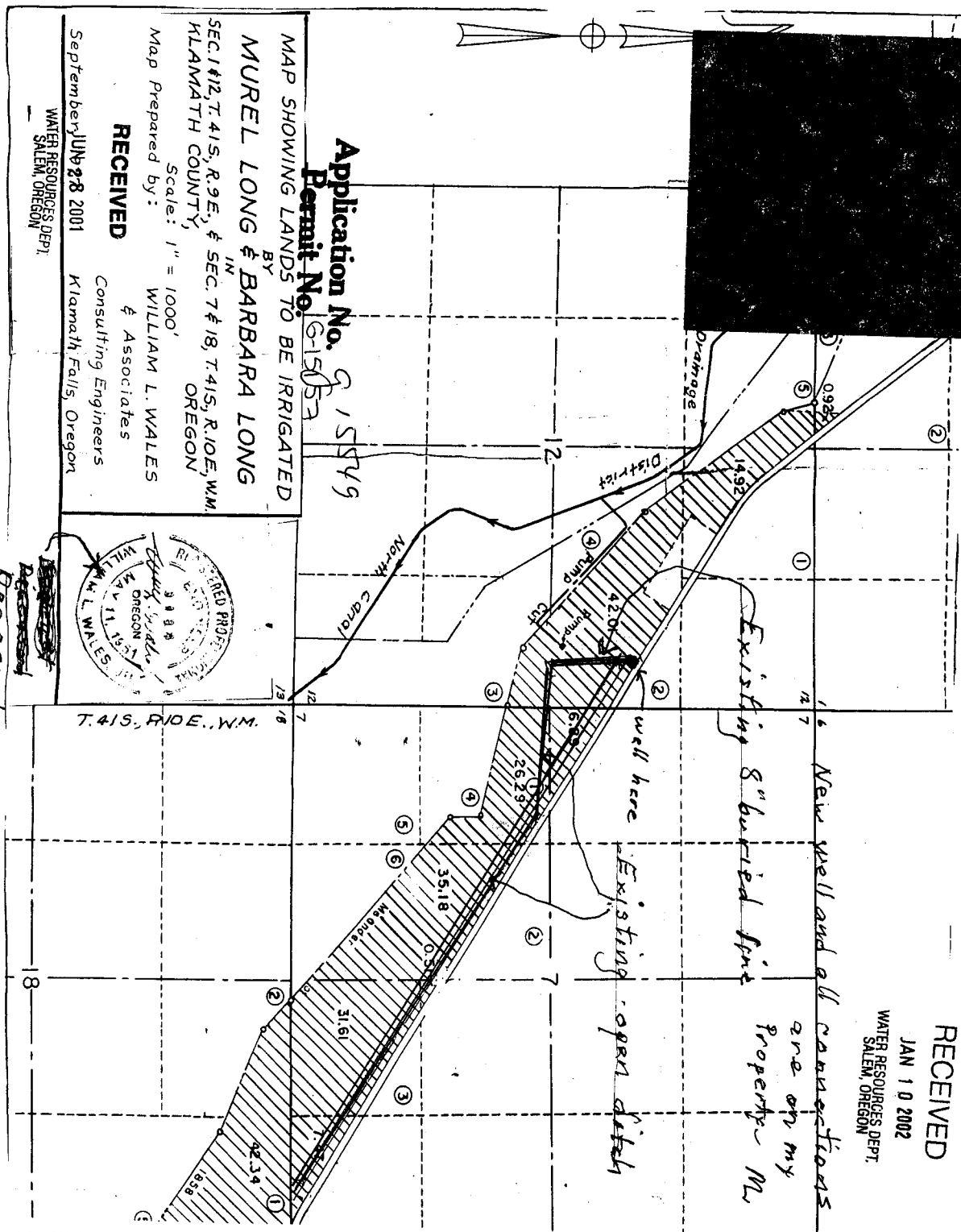

Application No. 915749  
Permit No. 61505

MAP SHOWING LANDS TO BE IRRIGATED  
BY  
**MUREL LONG & BARBARA LONG**  
IN  
SEC. 12, T. 41S, R. 9E, & SEC. 7 & 18, T. 41S, R. 10E, W.M.  
KLANATH COUNTY,  
OREGON  
Scale: 1" = 1000'  
Map Prepared by:  
**WILLIAM L. WALES**  
& Associates  
Consulting Engineers  
Klamath Falls, Oregon

September 28 2001  
WATER RESOURCES DEPT.  
SALEM, OREGON

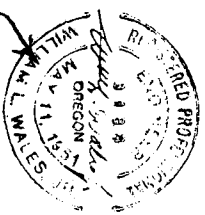

~~RECEIVED~~  
Dec 29 2001  
i.e. Dead

Well location  
490' Feet West and  
150 Feet South of  
NE cor Sec 12