

NE1/4 SE1/4 SEC.34, T.38S.,R.5 W., W.M.

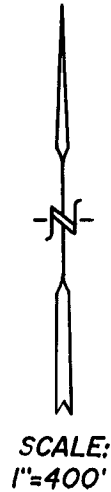

Application No. 915336
 Permit No. G-95165

LEGEND:

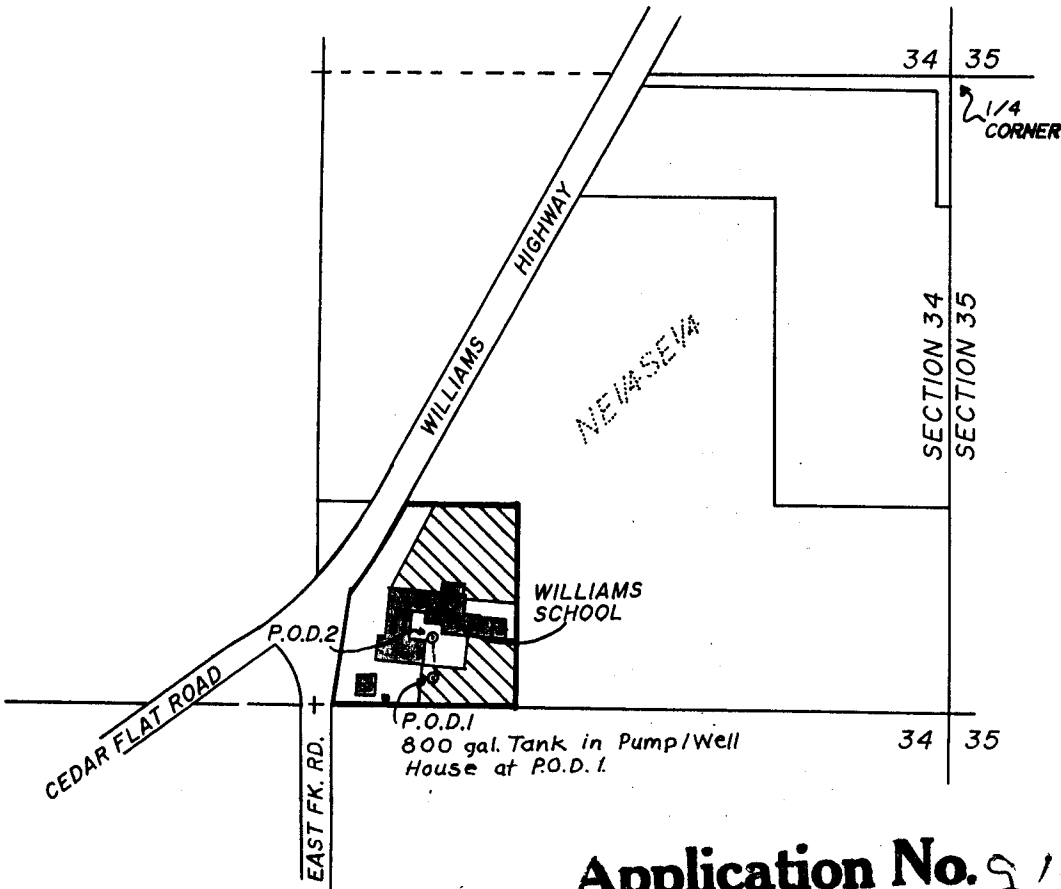

Proposed Place of Use per this Application
 1.8 Acres in NE1/4 SE1/4 Section 34.

- P.O.D.1 Existing Well = Point of Diversion
 1260'S & 1085'W of the 1/4 Corner of Section 34
- P.O.D.2 Existing Well = Point of Diversion
 1175'S & 1085'W of the 1/4 Corner of Section 34

Purpose of this Application: Appropriate ground water for Irrigation and Domestic Use
 Subject Property: T.L. 2100, Map No. 38-5-34. (WILLIAMS SCHOOL)

NOTE: Location of Buildings are Approximate only. Area of use has been determined by Planimeter from an Aerial Photo dated 6-22-86.

This plat was prepared for the purpose of identifying the location of the water right only. There is no intent to provide dimensions or locations of property ownership lines.

RECEIVED

MAR 05 2001

WATER RESOURCES DEPT.
 SALEM, OREGON

PROJECT NO.
 420-95-304

DRAWING NO.
 62-8.5.11

DATE
 Dec. 19, 2000

SCALE
 1"=400'

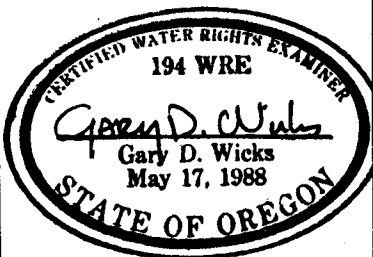

PLAT OF WATER RIGHT APPLICATION
 LOCATED IN
 NE1/4 SE1/4 SEC.34, T.38S.,R.5W., W.M.
 JOSEPHINE COUNTY, OREGON

PREPARED FOR:
 THREE RIVERS SCHOOL DIST.
 8550 New Hope Rd.
 Grants Pass, OR 97527
 Tel. 862-3111

PREPARED BY:
 WICKS ENGINEERING & SURVEYING
 311 NE. "D" Street
 Grants Pass, OR 97526
 Tel. 479-3436