

T 39 S, R 19 E, W.M.
SECTION 13
SE¹/₄



RECEIVED

JUN 18 2001

WATER RESOURCES DEPT.
SALEM, OREGON

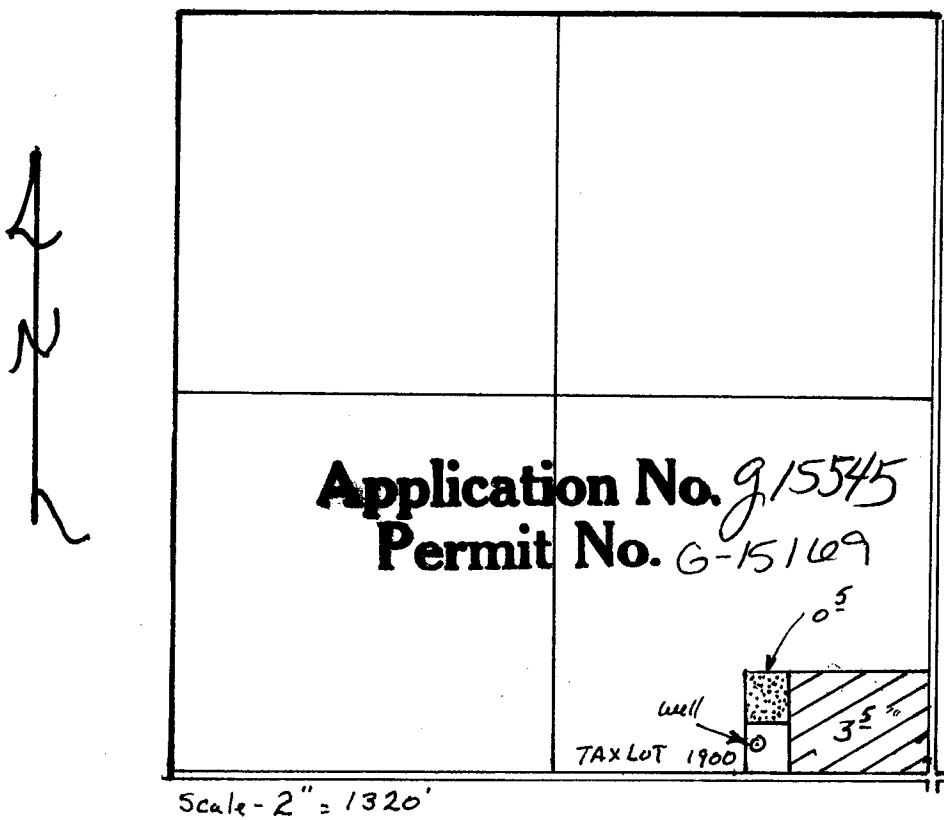
WELL LOCATED - 100 FEET NORTH AND 600 FEET WEST
FROM THE SE CORNER, SECTION 13
TOWNSHIP 39 SOUTH, RANGE 19 EAST, W.M.



-  Primary
-  Supplemental