

Application No. G-K723

Permit No. G-15242T6N, R34E and R35E, WM

RECEIVED

MAR 11 2002

WATER RESOURCES DEPT.
SALEM, OREGON

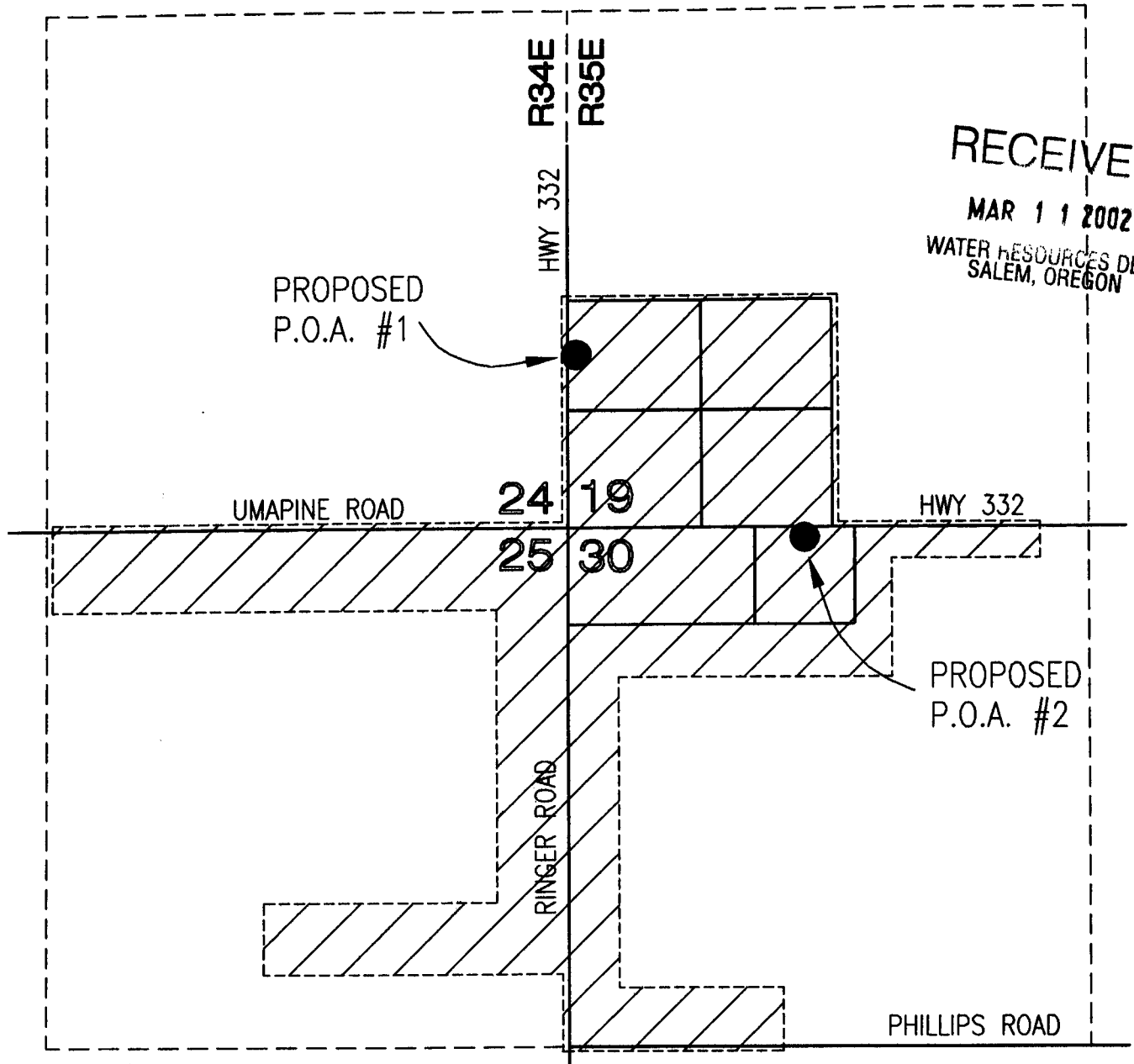

SCALE: 1" = 400'



POINT OF APPROPRIATION

Proposed POA #1 is well located 450 feet north and 40 feet east from the SE corner of Section 19, T6N, R35E, WM.

Proposed POA #2 is well located 50 feet south and 600 feet east from the SE corner of Section 19, T6N, R35E, WM.

LEGEND



Approximate, unofficial service area for municipal use of groundwater.

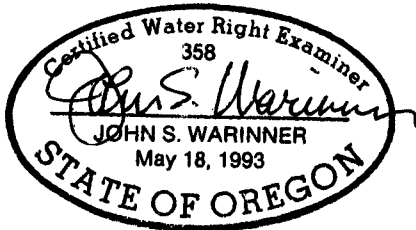

Fountainhead Irrigation, Inc.

PO Box 2197 Walla Walla, WA 99362
Phone (509) 529-2646 Fax (509) 522-5251

APPLICATION MAP

Application to Appropriate Groundwater

In The Name Of:
Vincent Water Company
51595 Highway 332
Milton-Freewater, OR
97862

Mapped By John Warinner, PE, CWRE
20 NOV 2001