

TOWNSHIP 3 SOUTH, RANGE 4 WEST, W.M.

Section 36

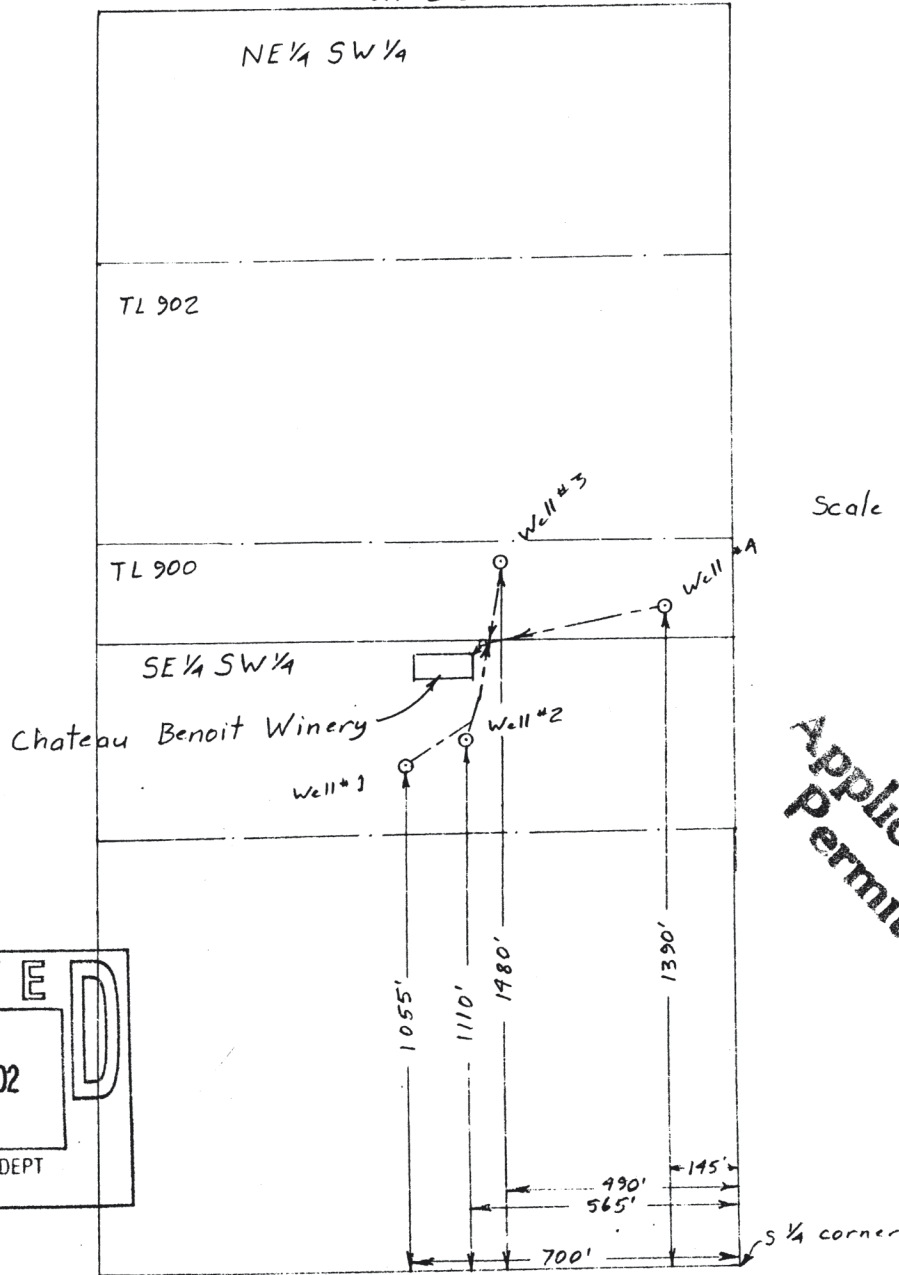

**RECEIVED**

APR 18 2002

WATER RESOURCES DEPT  
SALEM, OR

Application No. 915747  
Permit No. G15271

Application Map  
for  
Chateau Benoit Winery

Certified Water Right Examiner  
#1  
*Bruce A. Estes*  
Bruce A. Estes  
Nov. 19, 1987  
STATE OF OREGON  
Renewal Dec 31, 2003

This map is for the purpose of  
locating a water right only  
and has no intent to provide  
legal dimensions or the location  
of property lines.

**ESTES SURVEYS**

PO Box 17519  
Salem, OR 97305-7519  
(503) 585-7593

60382 Arnold Rd  
Bend, OR 97702  
(541) 382-7391