

T.3S. R.3W. Sec. 32 & 33

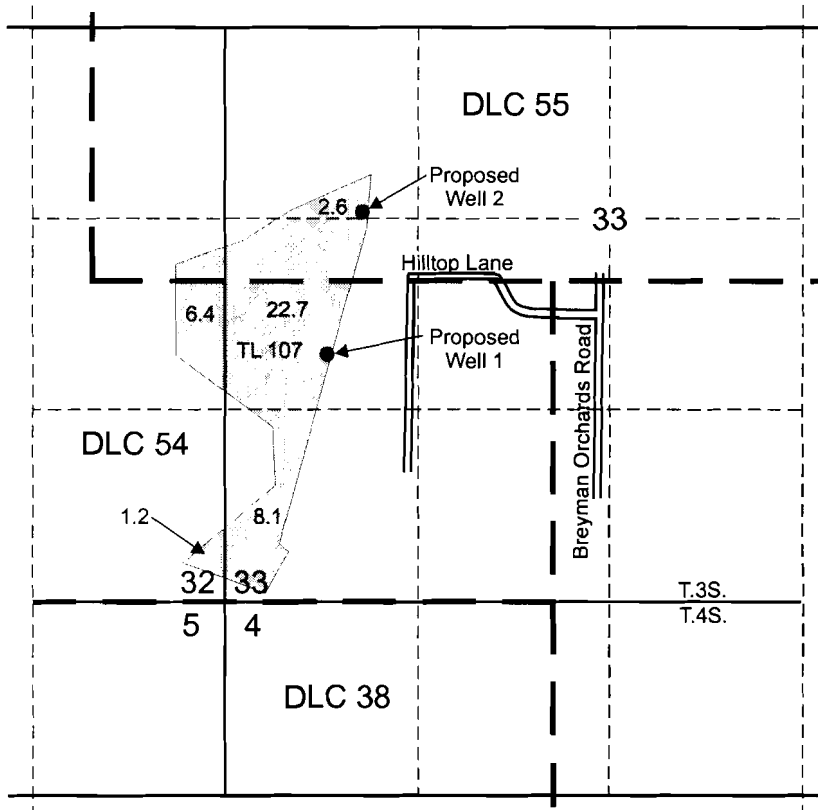

Proposed Well 1 is located 1,670 feet north and 700 feet east of the southwest corner of Section 33.

Proposed Well 2 is located 2,680 feet north and 950 feet east of the southwest corner of Section 33.

 Area (41 Acres) to be irrigated.

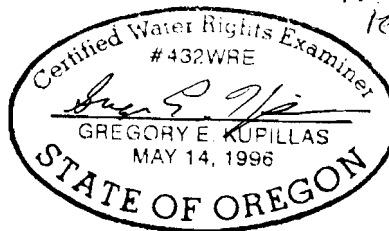
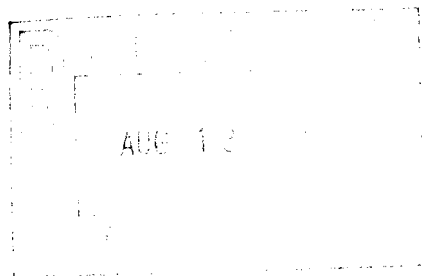

EXPIRATION DATE: 6/30/03

APP # G-15759
Result #
G-15370

Scale: 1" = 1,320'

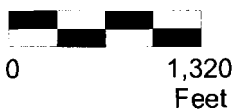

This map was prepared for the purpose of identifying the location of a water right only and is not intended to provide legal dimensions or location of property ownership lines.



Water Right Application Map

John McClintock
T.3S. R.3W. Sec. 32 and 33

Pacific Hydro-Geology Inc.

Revised 8/2/02