

# TGS RITE W.M.

Sec. 21

Application No. G-15795  
 Permit No. G-15343

RECEIVED

JUL 03 2002

WATER RESOURCES DEPT.  
 SALEM, OREGON

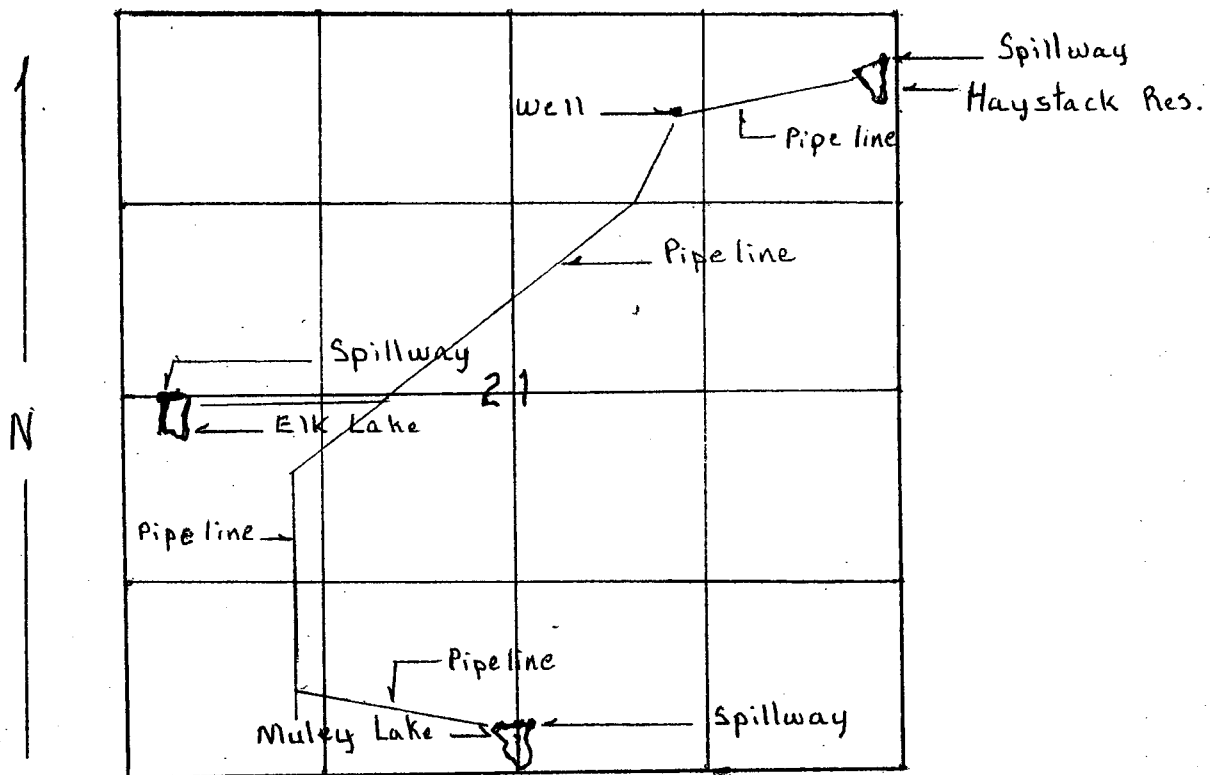

Scale — 1" = 1320'

Tax lot 2400

Well — 1600' w and 620' S of the NE corner of sec. 21

① Haystack spill w. — 120' w and 330' S of the NE corner of sec. 21

② Elk Lake spill w. — 4900' w and 2600' S of the NE corner of sec. 21

③ Muley lake spill w. — 4950' S and 2600' W of the NE corner of sec. 21