

# T.6S., R.2W., W.M

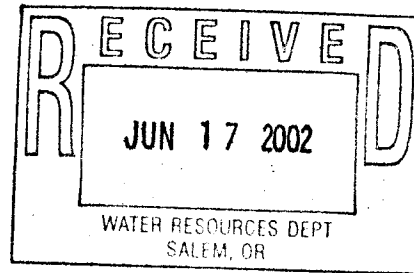

Application No. 915714  
Permit No. G-75366

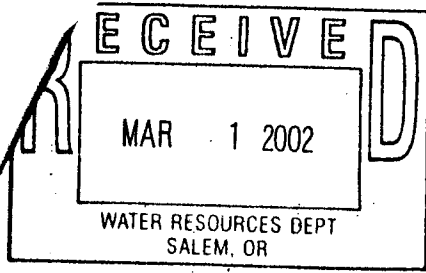
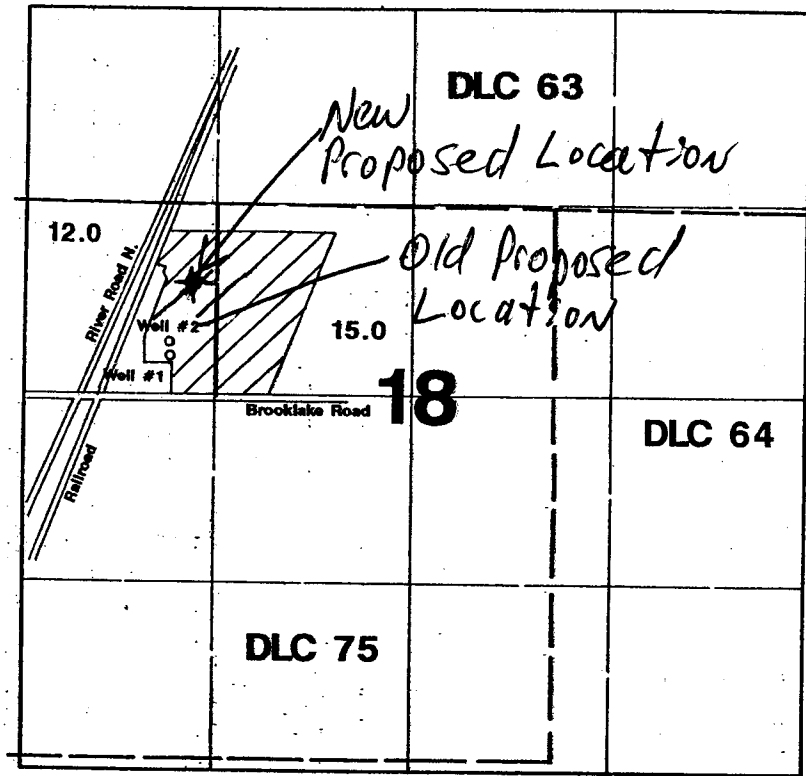

1" = 1320'



Well #1 is located 330'N & 1000'E from the W1/4 corner of Section 18.  
Well #2 is located 370'N & 1000'E from the W1/4 corner of Section 18.

**NEW PROPOSED WELL IS 730' N & 1100' E FROM**  
**Application Map** *The W 1/4 Corner of*  
*Section 18.*

## Van's Nursery

Application #:

Permit #:

This Map Was Prepared For The Purpose Of Identifying The Location Of A Water Right Only And Is Not Intended To Provide Legal Dimensions Or Location Of Property Ownership Lines.

