

T.4S. R.3W. Section 17

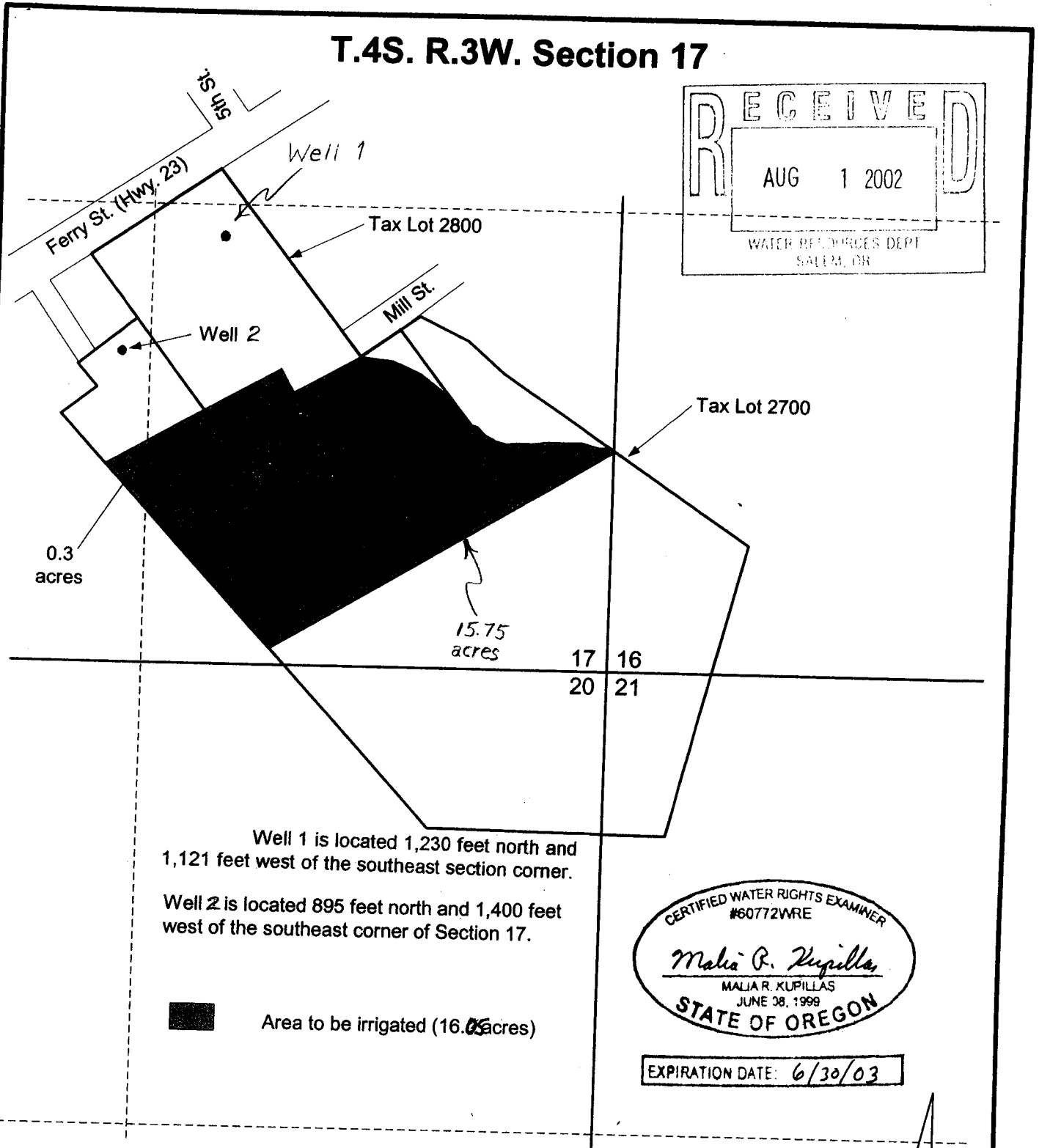
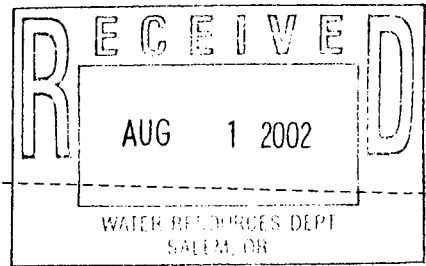

Well 1 is located 1,230 feet north and 1,121 feet west of the southeast section corner.

Well 2 is located 895 feet north and 1,400 feet west of the southeast corner of Section 17.

Area to be irrigated (16.05 acres)

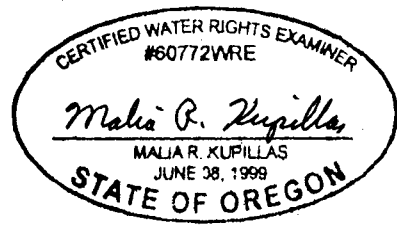

EXPIRATION DATE: 6/30/03

Scale: 1" = 400'

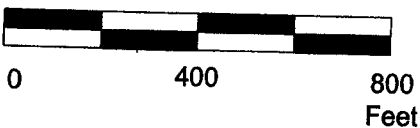

Application No. G-15263

This map was prepared for the purpose of identifying the location of a water right only and is not intended to provide legal dimensions or location of property ownership lines.



Pacific Hydro-Geology Inc.

Revised Permit Application Map for Groundwater Rights

Dayton School District
T.4S. R.3W Sec. 17, TL 2700 and 2800