

Arndt Road 31 32

6 5

# T.4S. R.1E. Section 6

NOV 27 2002

Barlow Road

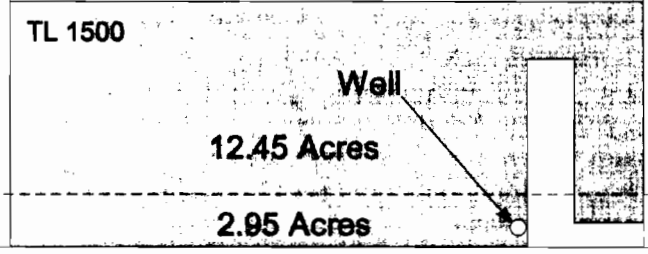
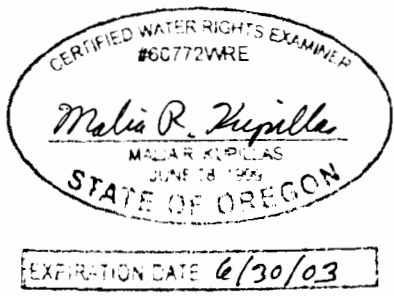

Well (proposed) is located 1,580 feet west and 2,710 feet south of the NE corner Section 6.

Area to be irrigated

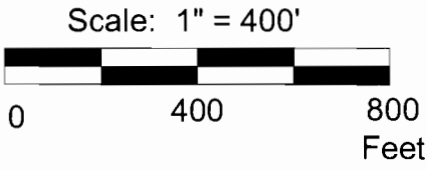

Application No. G-15256  
Permit # G-15433

This map was prepared for the purpose of identifying the location of a water right only and is not intended to provide legal dimensions or location of property ownership lines.



## Permit Application Map for Groundwater Rights

Jose and Maria Sanchez  
T.4S. R.1E Sec. 6, TL 1500

Pacific Hydro-Geology Inc.

Revised 11/19/02