

IAH COUNTY

= 200'

31

32

6

5

- #1 = Pond 1
- #2 = Pond 2
- #3 = Pond 3 (PROPOSED)
- ⊗ = P.O.D.

APP # G-15830
 Permit # G-15439



SEE MAP 3N IW
 1981 2828
 1374.4

RECEIVED

APR 28 2002

WATER RESOURCES DEPT.
SALEM, OREGON

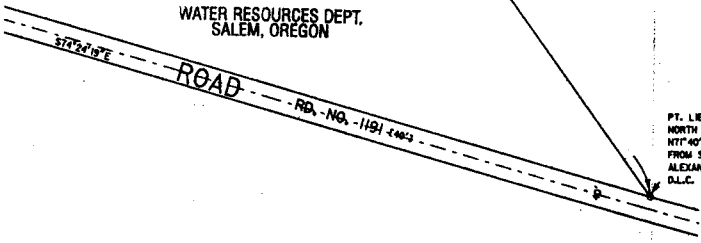

SEE MAP 2N IW 6

1/4 COR.

N.D.L.C.
WIS

