

T. 8 S., R. 16 E., W. M.

App # 6-15927
Permit # 6-15521

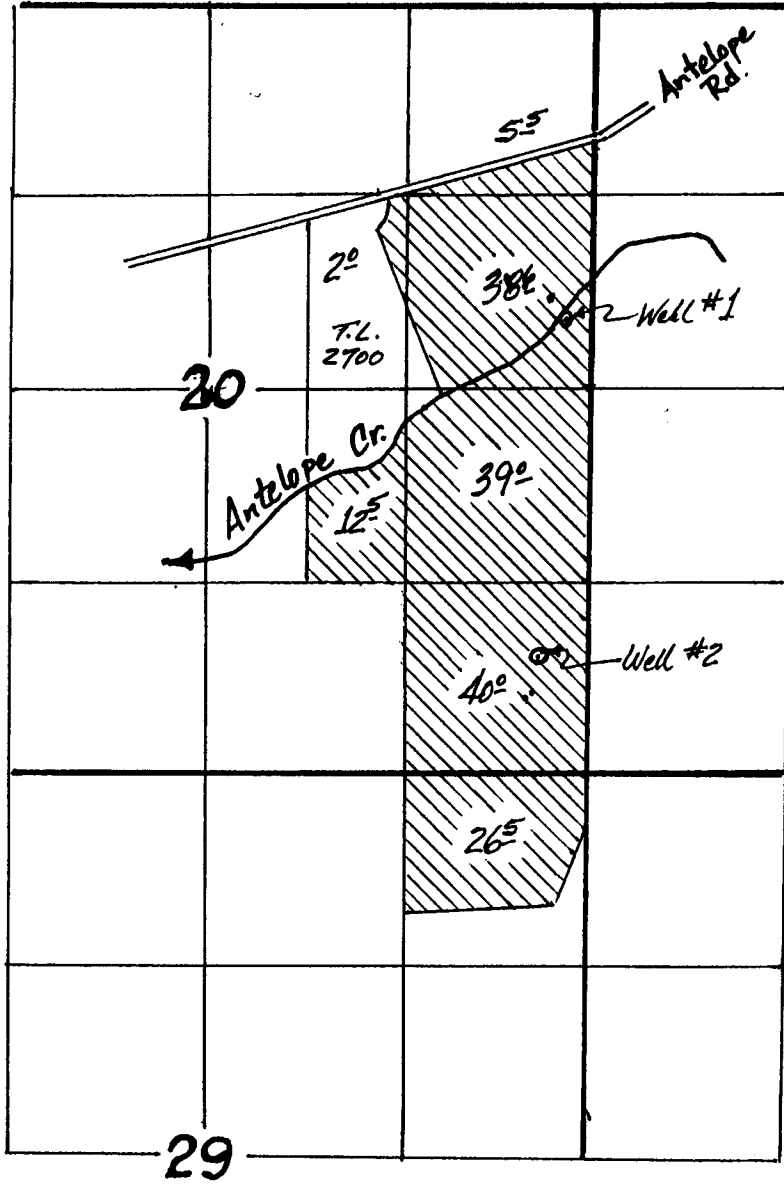

1" = 1320'

WELL LOCATIONS: #1 - 3160' N. & 180' W. ;
#2 - 820' N. & 360' W. ; both from SE Cor. Section 20.

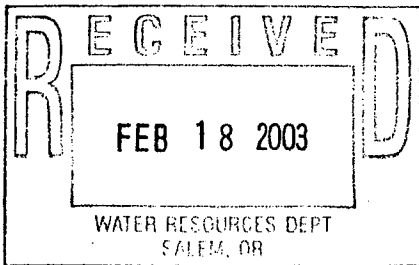

APPLICATION MAP
FRANK L. NEWELL

FEB 2003 *AK*