

**GROUND WATER APPLICATION MAP
FOR
KENT & SHANNON MADISON
(BAR "M" RANCH)
NE 1/4 SEC 18
&
NW 1/4, NW 1/4 SEC 17
T3N, R37E WM**

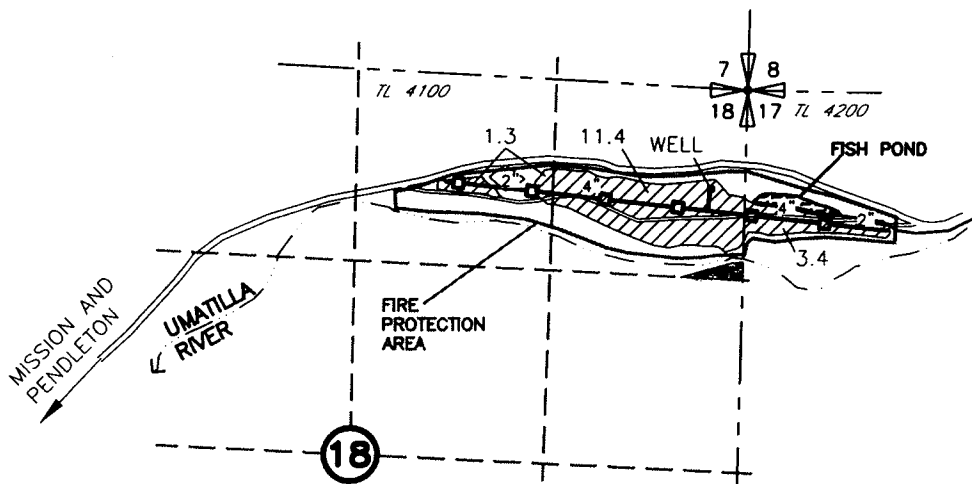

AUTHORIZED POINT OF APPROPRIATION
WELL LOCATED 700' S AND 230' W FROM THE
NE CORNER OF SEC 18

- AREA BEING IRRIGATED 16.1 ACRES
- AREA OF RECREATION
- 4" IRRIGATION PIPE

*app# 6-15847
Permit # 6-15526*

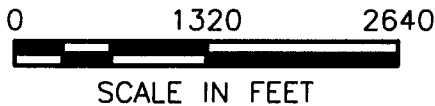

RECEIVED
OCT 07 2002

WATER RESOURCES DEPT.
SALEM, OREGON

NOTE:
THE PURPOSE OF THIS MAP IS TO IDENTIFY THE APPROXIMATE LOCATION
OF THE WATER RIGHT. IT IS NOT INTENDED TO PROVIDE INFORMATION
RELATIVE TO THE LOCATION OF PROPERTY OWNERSHIP BOUNDARY LINES.