

TOWNSHIP 9 SOUTH,  
 RANGE 2 EAST, SECTION 25 & 36  
 RANGE 3 EAST, SECTIONS 29, 30, 31 & 32

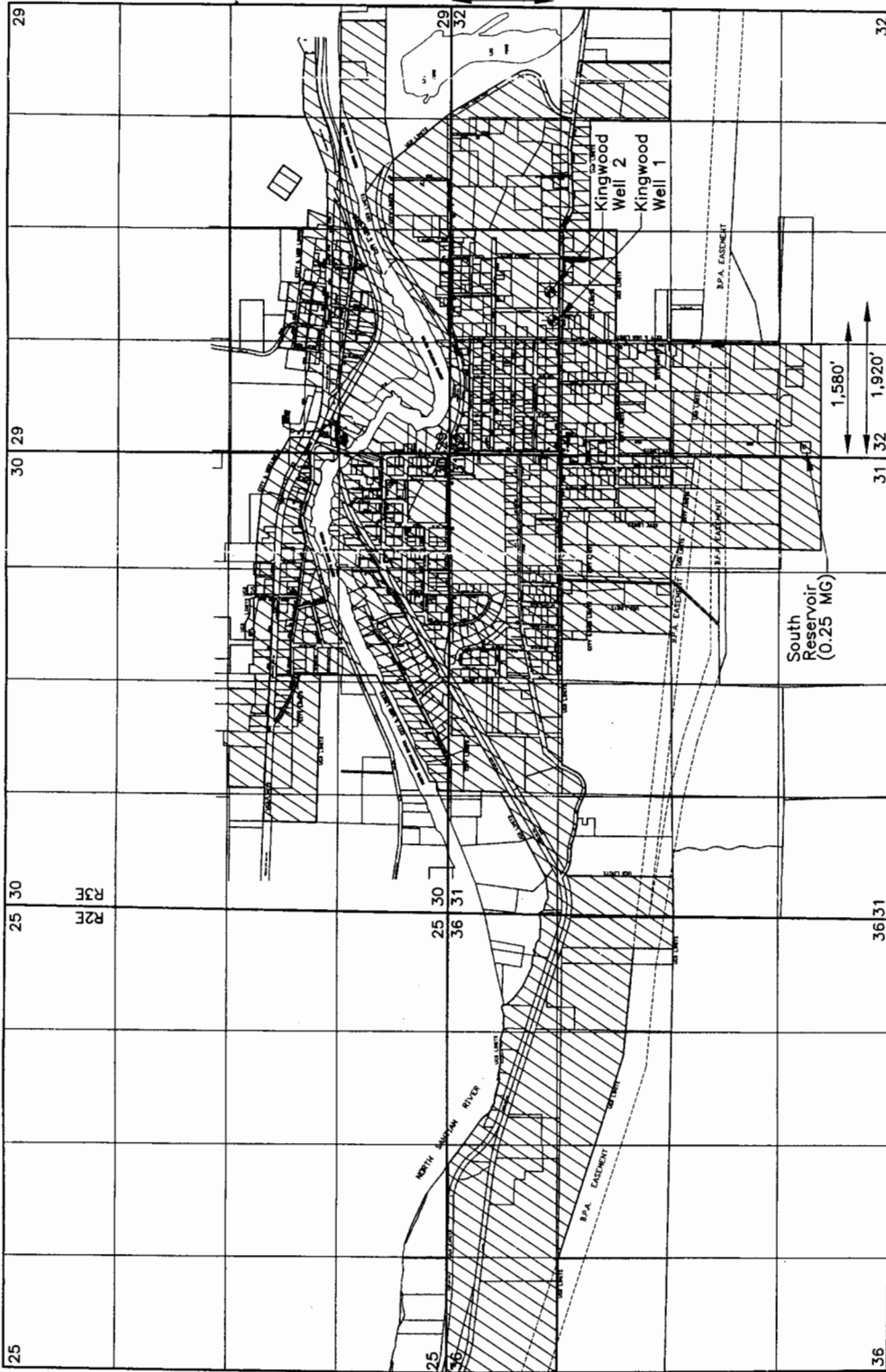

SCALE 1" = 1320'

**RECEIVED**  
 SEP 30 2003  
 WATER RESOURCES DEPT.  
 S.W. KING

App. No. G-16101  
 Permit No. G-15608

EXPLANATION:

- ⊕ PROPOSED POINT OF APPROPRIATION (WELL)
- ▨ PROPOSED PLACE OF USE (SERVICE AREA BOUNDARY)

THE PURPOSE OF THIS MAP IS TO IDENTIFY THE LOCATION OF THE WATER RIGHT. IT IS NOT INTENDED TO PROVIDE INFORMATION RELATIVE TO THE LOCATION OF PROPERTY OWNERSHIP BOUNDARY LINES.

- Notes:
1. Proposed Kingwood Well 1 POA located 1,240 feet south and 1,580 feet east of NW corner of Section 32.
  2. Proposed Kingwood Well 2 POA located 1,200 feet south and 1,920 feet east of NW corner of Section 32.



APPLICATION MAP  
 CITY OF MILL CITY, OREGON

FIGURE 1