

MAP Revised

T 23 South R 32 East Section 7

Tax Lot 1300 Harney County Oregon USA

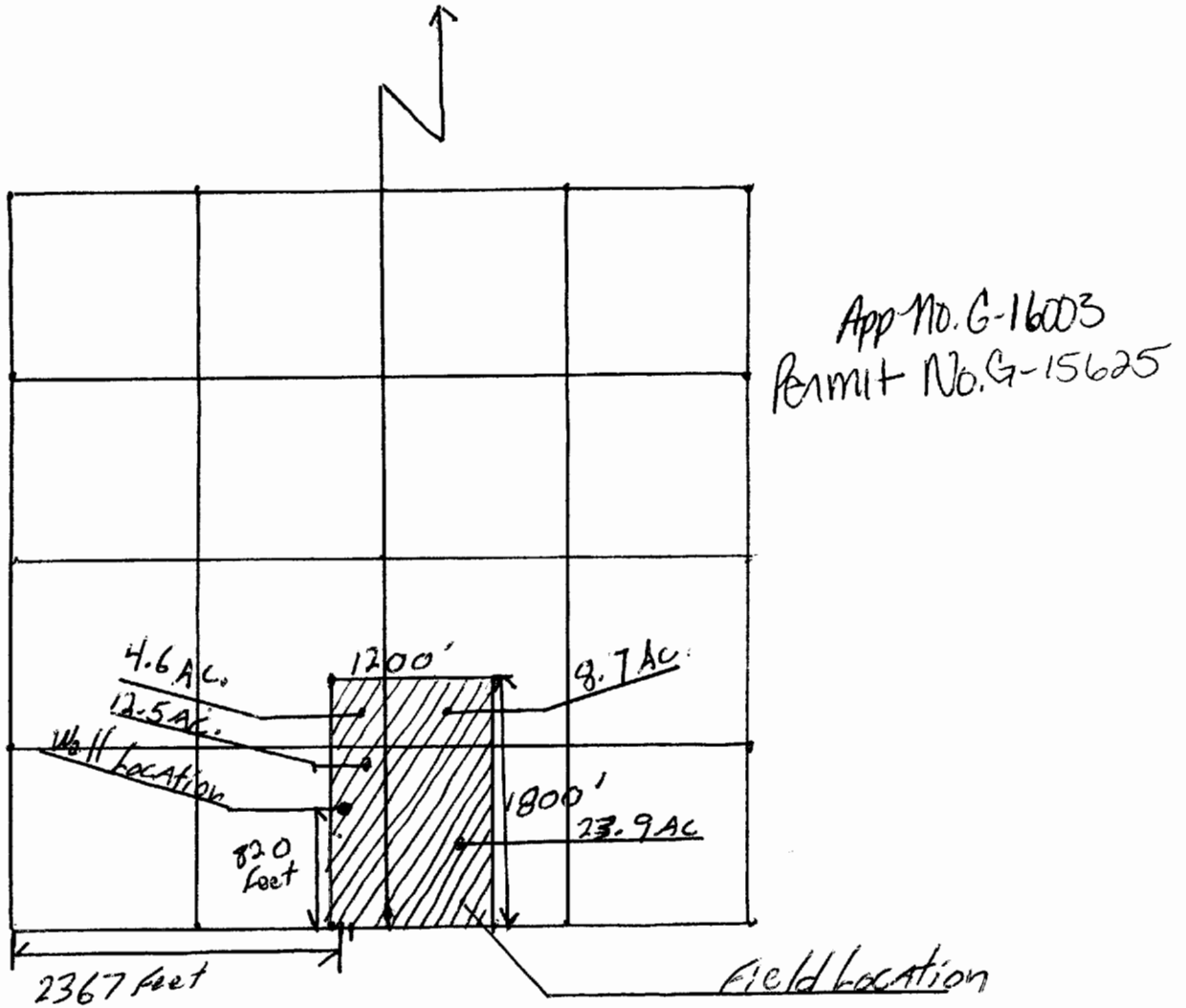

Scale 4" = 1 mile  
1/8" = 165 feet

Malheur Lake Basin

Property Owner: JOSEPH Williams

**RECEIVED**

MAY 05 2003

WATER RESOURCES DEPT.  
SALEM, OREGON