

Walla Walla River Irrigation District

6N 35E Sec 33

App # G-16102

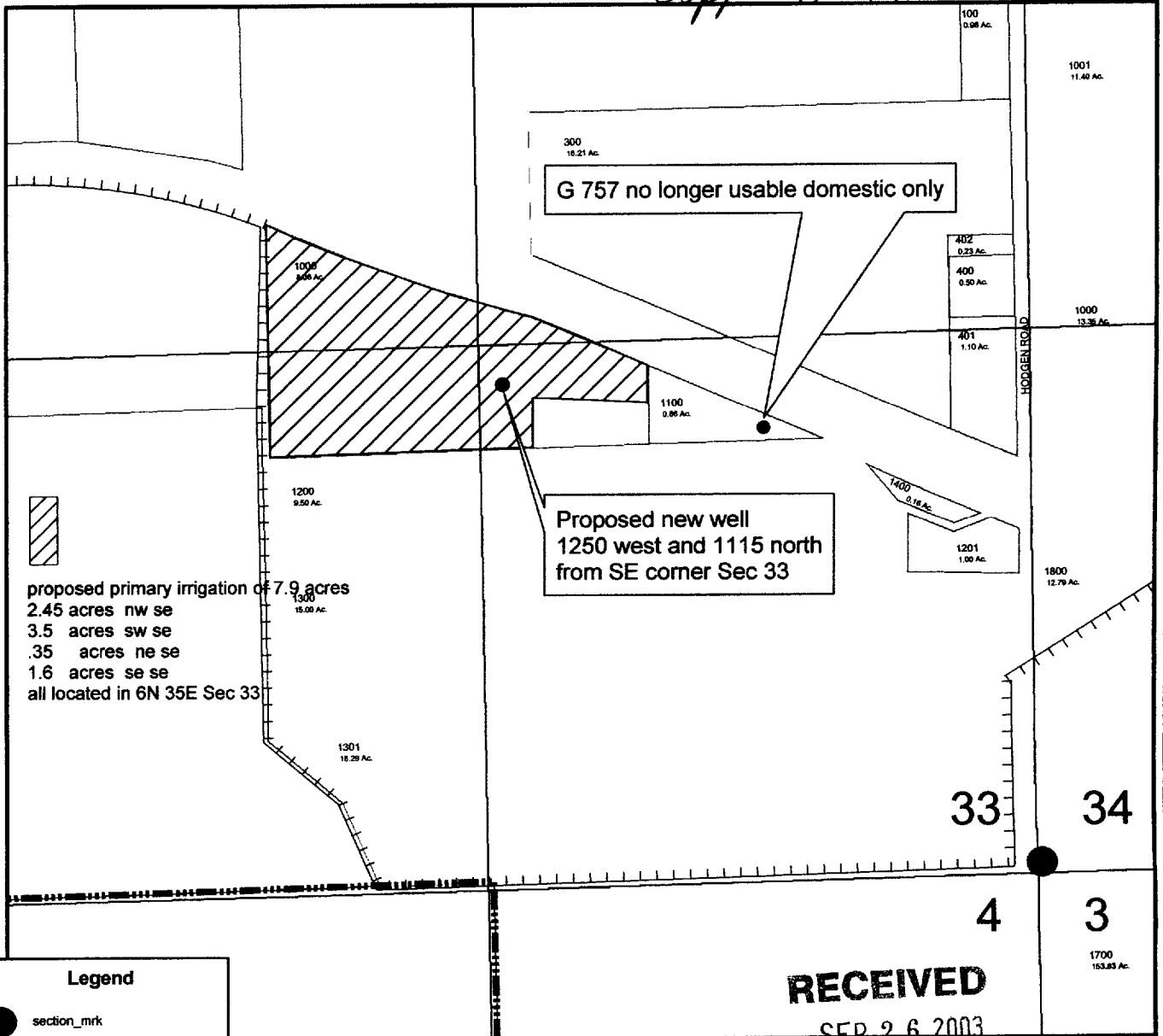

proposed primary irrigation of 7.9 acres
 2.45 acres nw se
 3.5 acres sw se
 .35 acres ne se
 1.6 acres se se
 all located in 6N 35E Sec 33

Proposed new well
 1250 west and 1115 north
 from SE corner Sec 33

G 757 no longer usable domestic only

RECEIVED
SEP 26 2003

Legend

- section_mrk
- ▤▤▤ Powell_PV
- ▬ LWWR ditches
- wwPods

Layer

- ▬ CANAL1 HB
- ▬ FROST
- ▬ WALLA-PIPE1
- ▬ WALLA-WALLA-RIVER
- ▤▤▤ Milton_ditch
- ▤▤▤ Lydell_ditch
- ▤▤▤ Eastside_ditch
- ▤▤▤ Powell_PV
- ▬▬▬ wwrid_boundary

LAYER

- ▭ Future Irrigation
- ▤▤▤ Irigated Lands Irigated Lands
- section_mrk
- ▤▤▤ Powell_PV

**Walla Walla River
Irrigation District**
 605 Lamb St. Milton-Freewater OR 97862
 Office: 541-938-0144
 E-Mail: wwrid@hscis.net

WATER RESOURCES DEPT.
SALEM, OREGON

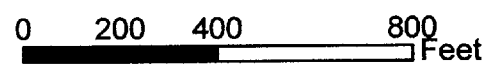

1 inch equals 400 feet

The water rights shown on this map have been interpreted by the District's staff from information in the District's files and are intended to represent that interpretation graphically. Locations shown are only approximate and should not be used in legal, financial, or real estate decisions. For more accurate legal location information, please contact the Water Resources Department.

Created in ArcGIS 8 using ArcMap

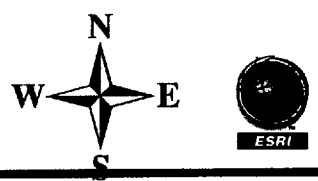

Permit no. G 15660