

Walla Walla River Irrigation District 6N 35E Umatilla Co.

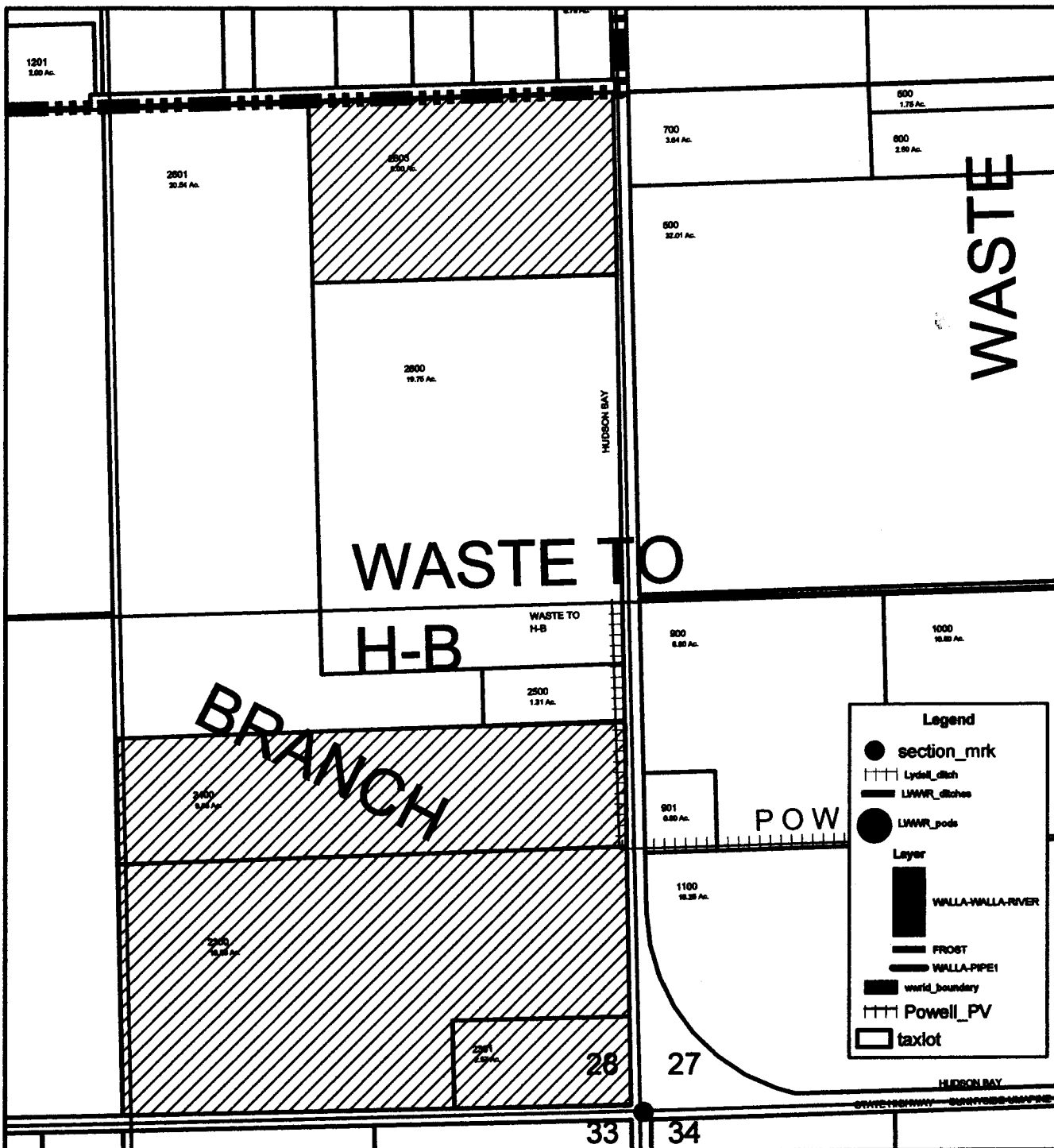

New Supplemental rights from wells 1 & 2
 28.9 acres SE1/4 SE1/4 Sec 28
 3.9 acres NE1/4 SW1/4 Sec 34
 9 acres NE1/4 SE1/4 Sec 28
 18 acres NE1/4 SE1/4 Sec 34

1 inch equals 400 feet

The water rights shown on this map have been interpreted by the District's staff from information in the District's files and are intended to represent that interpretation graphically. Locations shown are only approximate and should not be used in legal, financial, or real estate decisions. For more accurate legal location information, please contact the Water Resources Department.

Created in ArcGIS 8 using ArcMap



RECEIVED



JAN 23 2004

WATER RESOURCES D
 SALEM, OREGON

Permit # 15715

App No G-16174

Walla Walla River Irrigation District 6N 35E Umatilla Co.

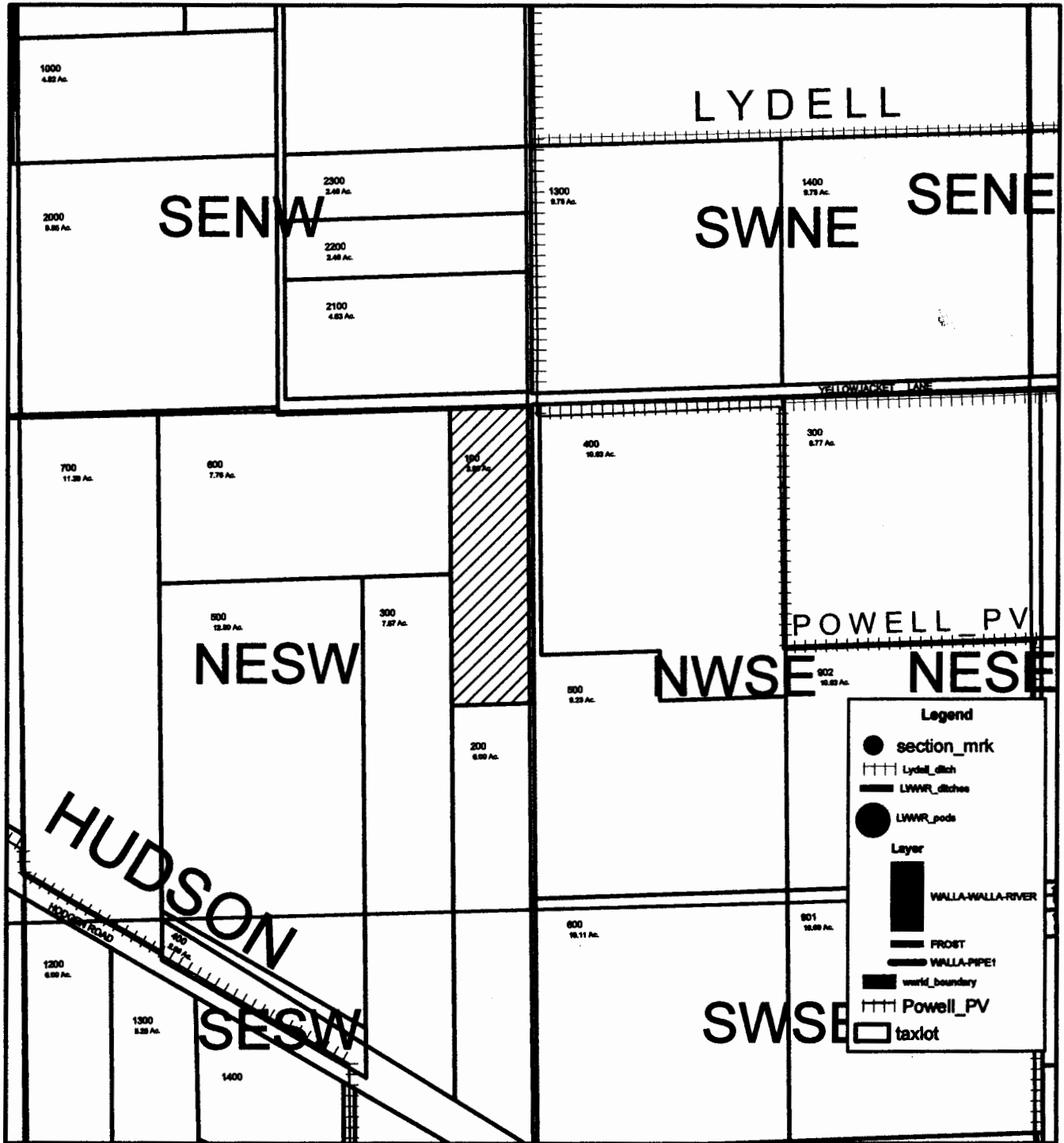

Legend

- section_mrk
- |||| Lydell_ditch
- LWWR_ditches
- LWWR_pods
- Layer
- WALLA-WALLA-RIVER
- PROET
- WALLA-PIPE#1
- world_boundary
- |||| Powell_PV
- taxlot

New Supplemental rights from wells 1 & 2
 28.9 acres SE1/4 SE1/4 Sec 28
 3.9 acres NE1/4 SW1/4 Sec 34
 9 acres NE1/4 SE1/4 Sec 28
 18 acres NE1/4 SE1/4 Sec 34

1 inch equals 400 feet

The water rights shown on this map have been interpreted by the District's staff from information in the District's files and are intended to represent that interpretation graphically. Locations shown are only approximate and should not be used in legal, financial, or real estate decisions. For more accurate legal location information, please contact the Water Resources Department.

Created in ArcGIS 8 using ArcMap



RECEIVED

IAN 23 2004

WATER RESOURCES
SALEM, OREGO

Permit # G-15717

APP No G.16174

Walla Walla River Irrigation District 6N 35E Umatilla Co.

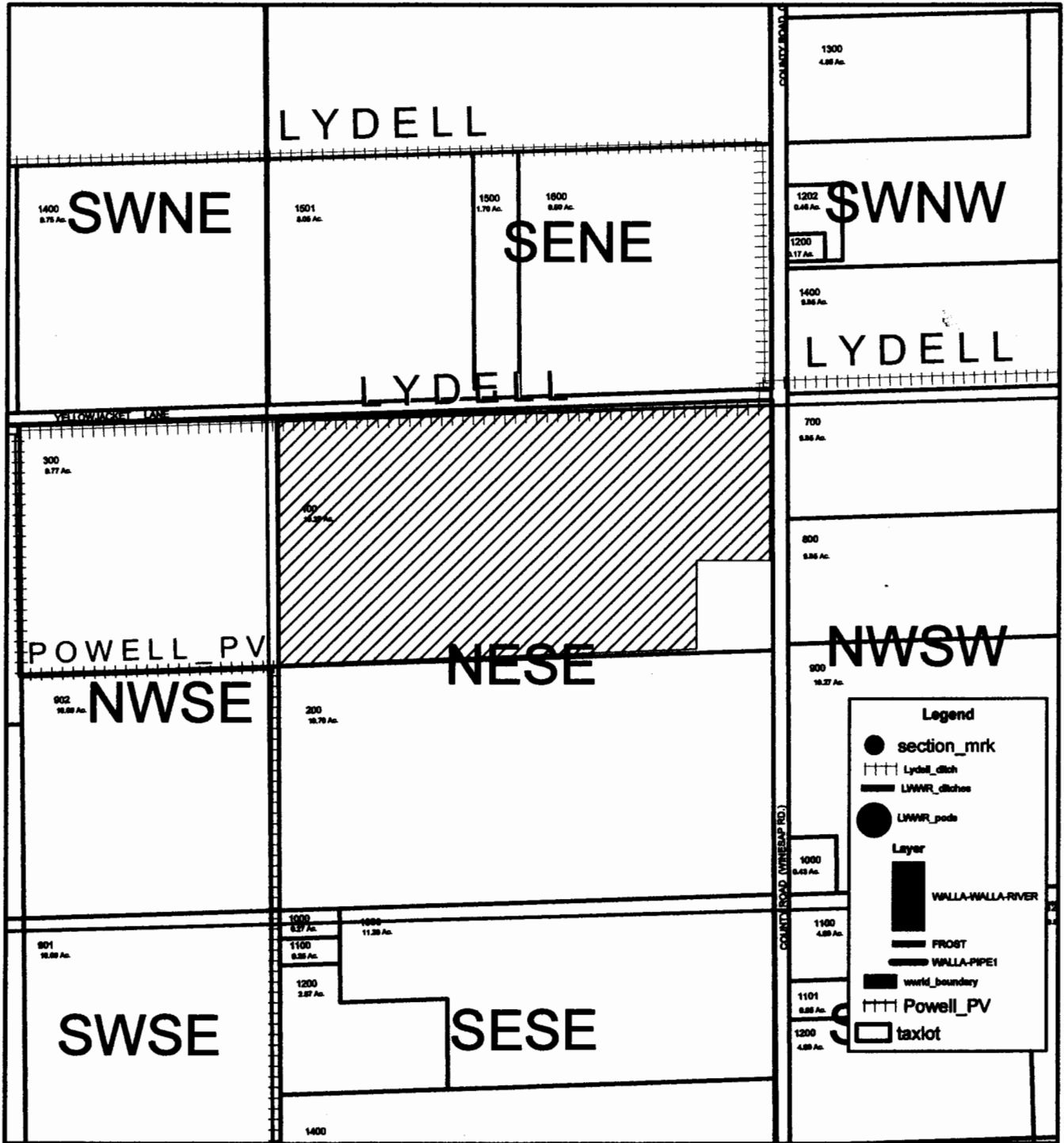

New Supplemental rights from wells 1 & 2
 28.9 acres SE1/4 SE1/4 Sec 28
 3.9 acres NE1/4 SW1/4 Sec 34
 9 acres NE1/4 SE1/4 Sec 28
 18 acres NE1/4 SE1/4 Sec 34

1 inch equals 400 feet

The water rights shown on this map have been interpreted by the District's staff from information in the District's files and are intended to represent that interpretation graphically. Locations shown are only approximate and should not be used in legal, financial, or real estate decisions. For more accurate legal location information, please contact the Water Resources Department.

Created in ArcGIS 8 using ArcMap

Legend

- section_mrk
- Lydell_ditch
- LWWR_ditches
- LWWR_peds

Layer

- WALLA-WALLA-RIVER
- FROST
- WALLA-PIPE1
- world_boundary
- Powell_PV
- taxlot



RECEIVED

ESRI

JAN 23 2004

Permit # G-15717

App No G-16174

WATER RESOURCES D
SALEM, OREGON

Walla Walla River Irrigation District 6N 35E Umatilla Co.

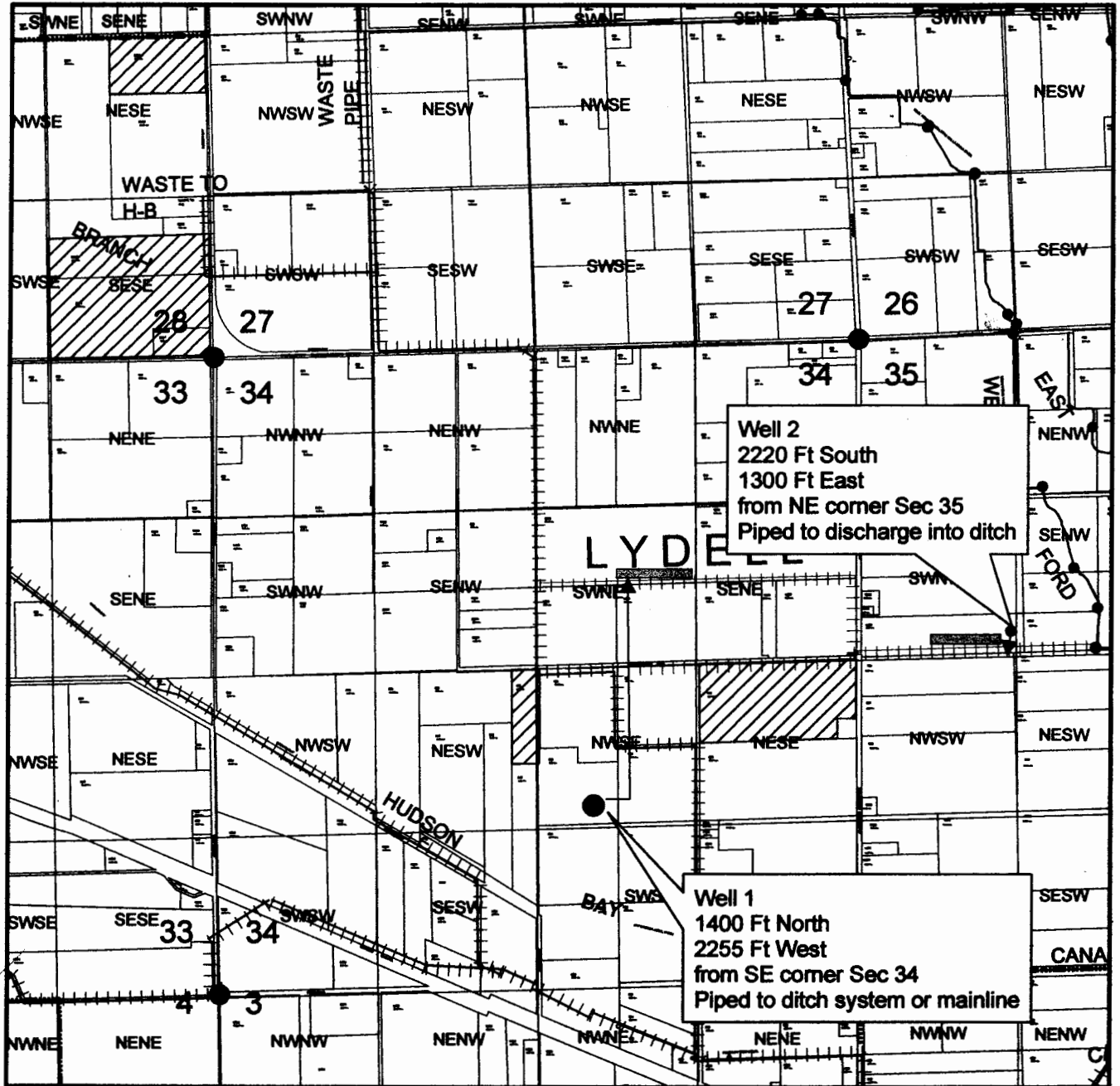

Well 2
2220 Ft South
1300 Ft East
from NE corner Sec 35
Piped to discharge into ditch

Well 1
1400 Ft North
2255 Ft West
from SE corner Sec 34
Piped to ditch system or mainline

Legend

- section_mrk
- Lydell_ditch
- LWWR_ditches
- LWWR_pods
- Layer**
- WALLA-WALLA-RIVER
- FROST
- WALLA-PIPE1
- wrwid_boundary
- Powell_PV
- taxlot

New Supplemental rights from wells 1 & 2
28.9 acres SE1/4 SE1/4 Sec 28
3.9 acres NE1/4 SW1/4 Sec 34
9 acres NE1/4 SE1/4 Sec 28
18 acres NE1/4 SE1/4 Sec 34

1 inch equals 1,320 feet

The water rights shown on this map have been interpreted by the District's staff from information in the District's files and are intended to represent that interpretation graphically. Locations shown are only approximate and should not be used in legal, financial, or real estate decisions. For more accurate legal location information, please contact the Water Resources Department.

Created in ArcGIS 8 using ArcMap

N
W —+— E
S

RECEIVED
JAN 23 2004
WATER RESOURCES DEPT
SALEM, OREGON

Permit # G-15717

App No G-16174