

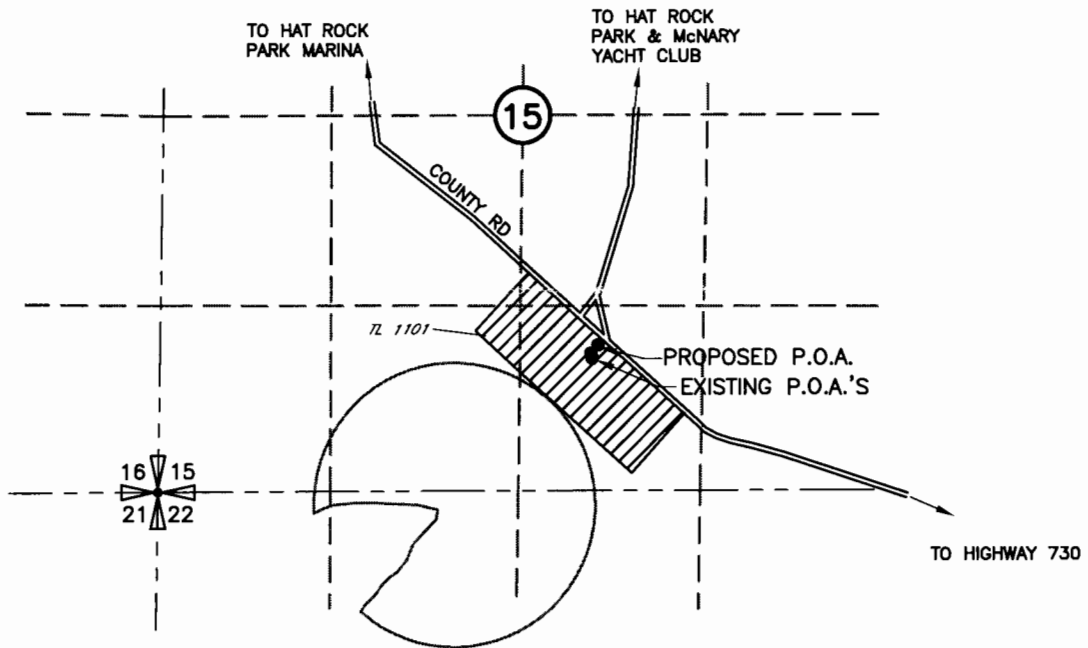

AMENDED 5-28-2004
HAT ROCK MOBILE HOME / R.V. PARK
% MIKE JEWETT
GROUND WATER APPLICATION MAP
APPLICATION NO G-16006
T5N, R29E WM



PROPOSED POINTS OF APPROPRIATION
NEW WELL LOCATED 1000'N AND 3030'E FROM THE
SW CORNER OF SEC 15

EXISTING WELLS (2) TO BE USED AS BACKUP
S WELL LOCATED 910'N AND 3000'E FROM THE SW
CORNER OF SEC 15
N WELL LOCATED 930'N AND 3000' E FROM THE SW
CORNER SEC 15

 HAT ROCK MOBILE HOME PARK / R.V. PARK
26 MOBILE HOMES, 08 RV SITES, 1 STORE AND
1 HOME

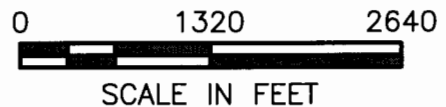

RECEIVED
JUN 01 2004
WATER RESOURCES DEPT
SALEM, OREGON

NOTE:
THE PURPOSE OF THIS MAP IS TO IDENTIFY THE APPROXIMATE LOCATION
OF THE WATER RIGHT. IT IS NOT INTENDED TO PROVIDE INFORMATION
RELATIVE TO THE LOCATION OF PROPERTY OWNERSHIP BOUNDARY LINES.

DRAWING: H:\CAD\AG\3522\166\352216604am.DWG
PRINTED BY: rogerw on 05/28/04 12:10 PM

 **Consultants, Inc.**
A Tetra Tech Company