

Township 3 South, Range 1 East, W.M.

Portions of Sections 16 & 17

RECEIVED

NOV 29 1988

WATER RESOURCES
SALEM, OREGON

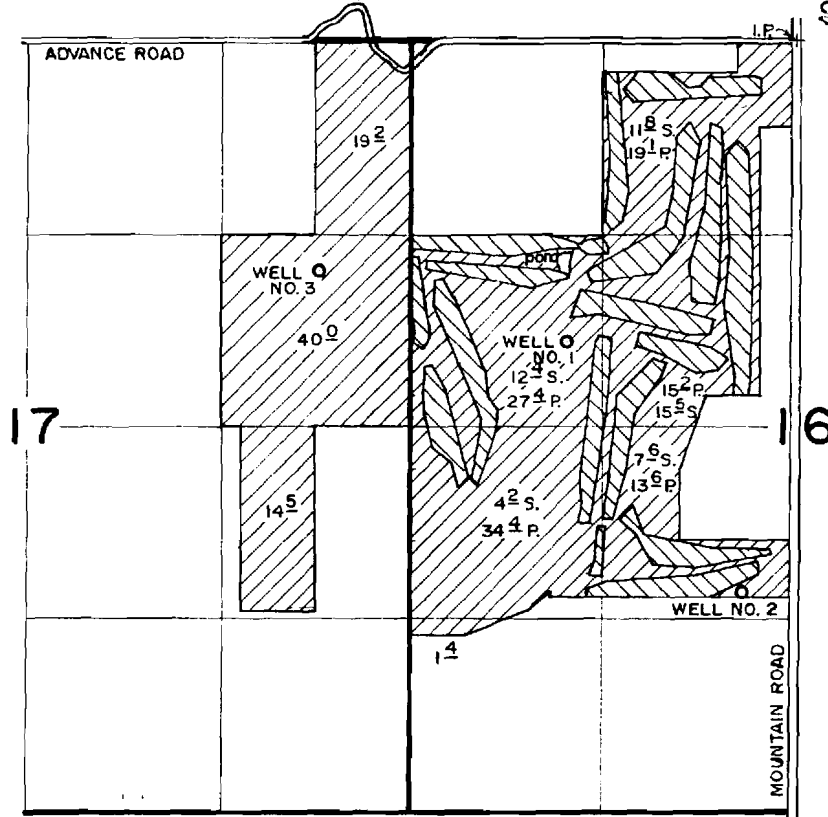

WELLS LOCATED: NO. 1, 2050' S. & 1560' W.; ALL FROM N. 1/4 COR. SEC. 16
NO. 2, 3780' S. & 360' W.
NO. 3, 1585' S. & 3280' W.

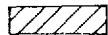
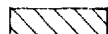
-  Primary, Wells 1, 2 & 3
-  Supplemental, Well 3

Application No. 2-12317
Permit No. G-11529-
G-13217

Application Map
for
SANDELIE GOLF CLUB, INC.

Donald R. Busch
STATE OF OREGON

THIS MAP WAS PREPARED FOR THE PURPOSE OF IDENTIFYING THE LOCATION OF A WATER RIGHT ONLY AND IS NOT INTENDED TO PROVIDE LEGAL DIMENSIONS OR LOCATION OF PROPERTY OWNERSHIP LINES.