

# T.10S. R.2W. Sec. 12 & 13

**RECEIVED**  
 DEC 17 2003  
 WATER RESOURCES DEPT  
 SALEM, OR

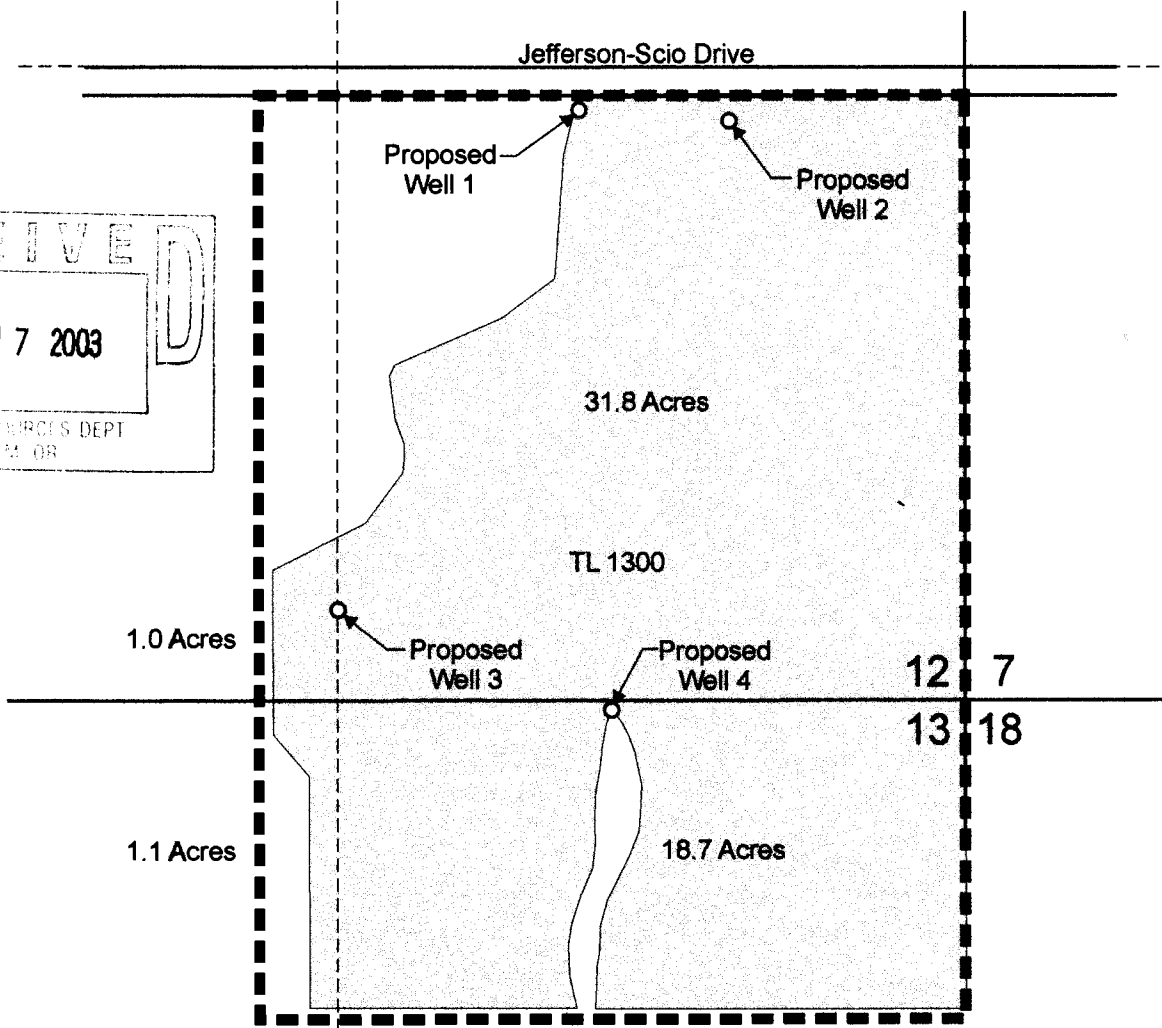

Proposed Well 1 is located 1,230 feet north and 810 feet west from the SE corner of Section 12  
 Proposed Well 2 is located 1,210 feet north and 500 feet west from the SE corner of Section 12  
 Proposed Well 3 is located 190 feet north and 1,320 feet west from the SE corner of Section 12  
 Proposed Well 4 is located 20 feet south and 740 feet west from the SE corner of Section 12

 Area (52.6 Acres) to be irrigated.

App. NO 616158  
 Permit NO.

Scale: 1" = 400'

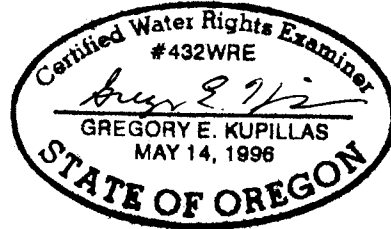
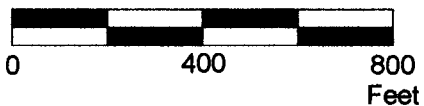

EXPIRATION DATE: 6/30/05



This map was prepared for the purpose of identifying the location of a water right only and is not intended to provide legal dimensions or location of property ownership lines.

## Water Right Application Map

Steve Eskeldson  
 T.10S. R.2W. Sec. 12 and 13, Tax Lot 1300

Pacific Hydro-Geology Inc.