

RECEIVED
JUL 11 2003
WATER RESOURCES DEPT
SALEM, OREGON

Section 21 NEW NE 1/4
GRASS CAP.
S 12 W 1954 FT NEW WELL SITE
FLOWERS

THOS REBWA

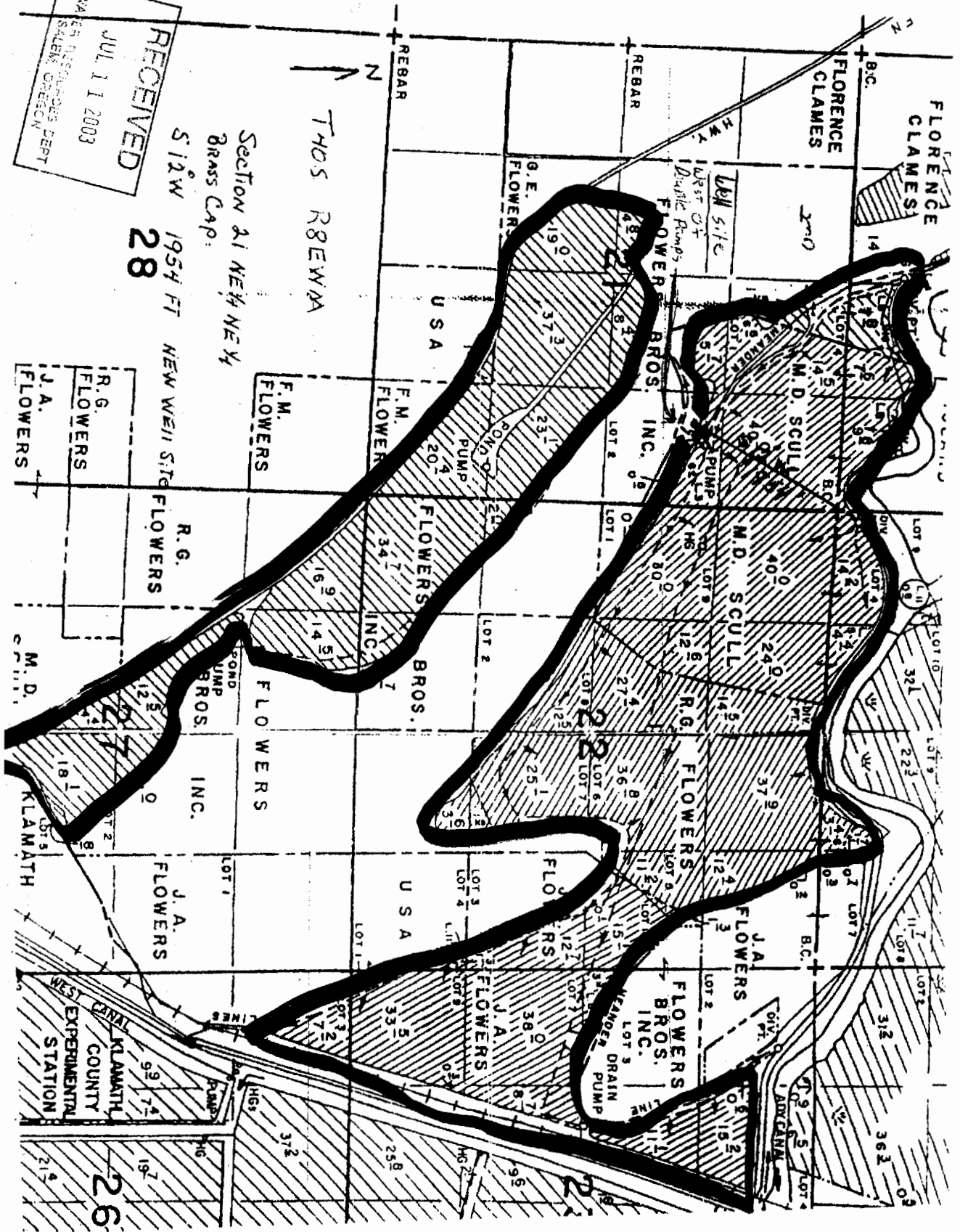

R.G. FLOWERS
J.A. FLOWERS

R.G. FLOWERS

F.M. FLOWERS

F.M. FLOWER

USA

FLOWERS BROS. INC.

M.D. SCULL

M.D. SCULL

R.G. FLOWERS

J.A. FLOWERS

J.A. FLOWERS

M.D. SCULL

KLAMATH COUNTY EXPERIMENTAL STATION

26

RECEIVED
APR 08 2003
WATER RESOURCES DEPT
SALEM, OREGON