

T6S., R.1W. & 2W., W.M.

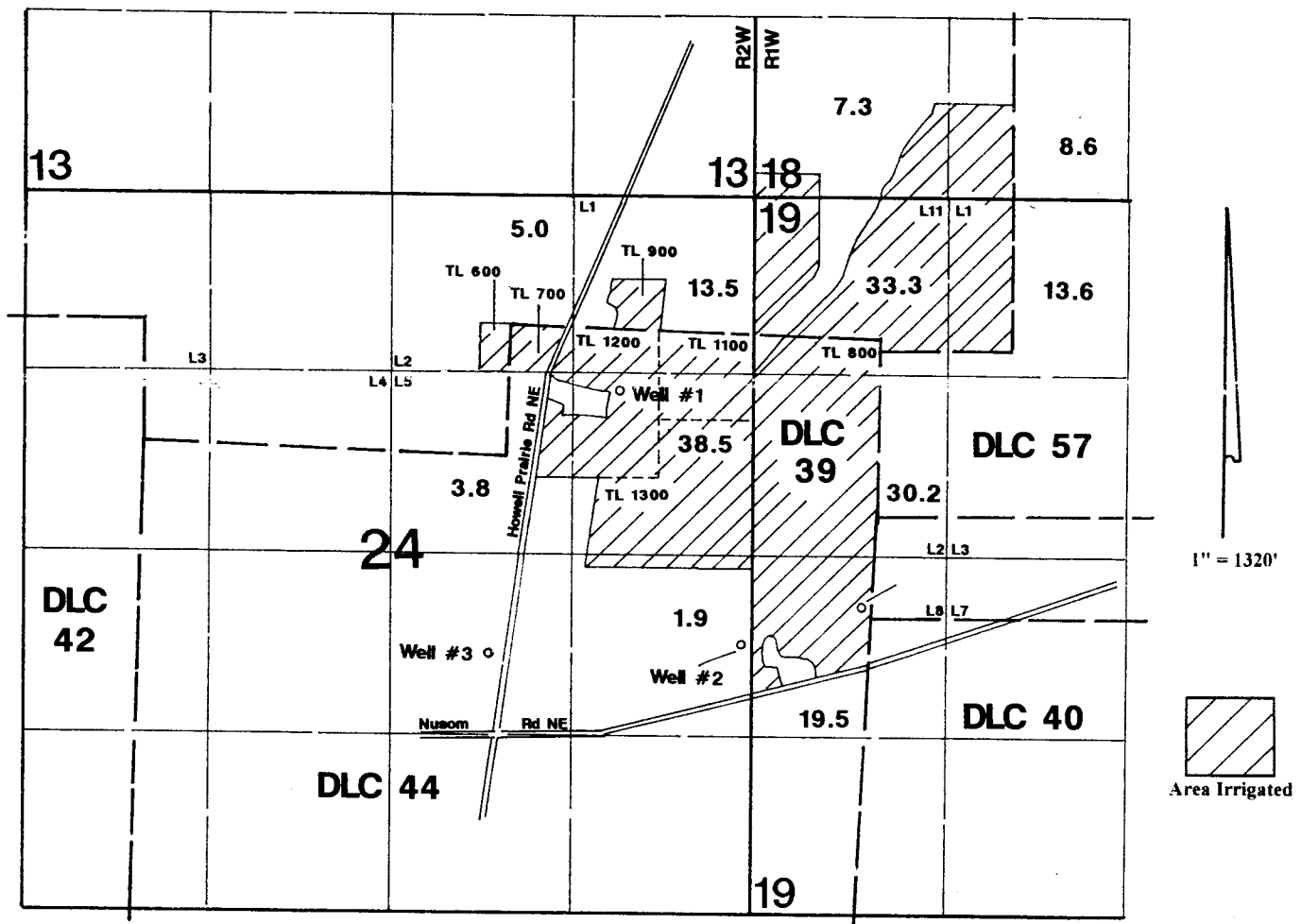

Well #1 is located 1450' S & 950' W from the NE corner of Section 24.
 Well #2 is located 660' S & 80' W from the E-1/4 corner of Section 24.
 Well #3 is located 693' S & 1848' W from the E-1/4 corner of Section 24.

Application Map

Carl Jensen Jr.

Application #: G-16203 Permit #:

RECEIVED

NOV 10 2004

WATER RESOURCES DEPT
 SALEM, OREGON

This Map Was Prepared For The Purpose Of Identifying The Location Of A Water Right Only And Is Not Intended To Provide Legal Dimensions Or Location Of Property Ownership Lines.

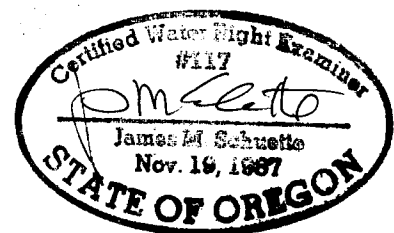

(Revised 11-10-04)