

APPLICATION: G-16160

T.9S. R.1E. Section 15

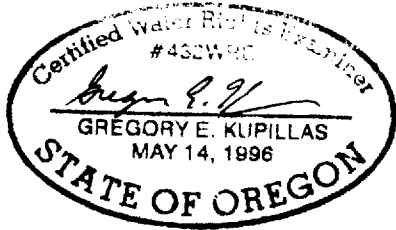

EXPIRATION DATE: 6/30/05

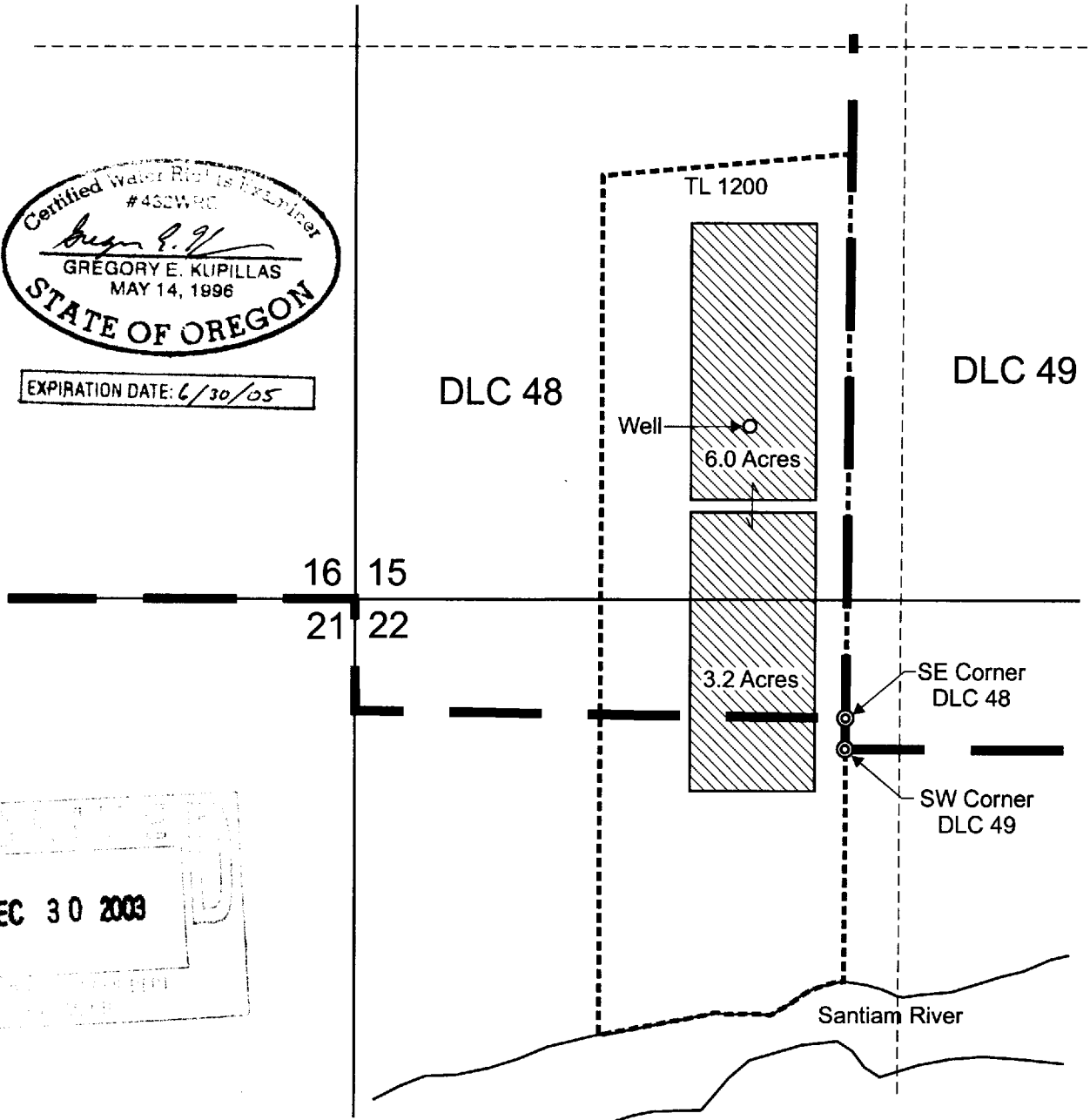

DEC 30 2003

Well (no log available) is located 420 feet north and 950 feet east from the SW corner of Section 15.

Greenhouses (9.2 Acres) to be irrigated.

Scale: 1" = 400'

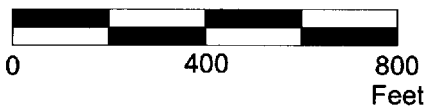

This map was prepared for the purpose of identifying the location of a water right only and is not intended to provide legal dimensions or location of property ownership lines.



Water Right Application Map

Heritage Seedlings
T.9S. R.1E. Sec. 15C and 22B, Tax Lot 1200

Pacific Hydro-Geology Inc.