

RECEIVED

APR 20 2005

WATER RESOURCES DEPT  
SALEM, OREGON

# T.3S., R.2W., W.M

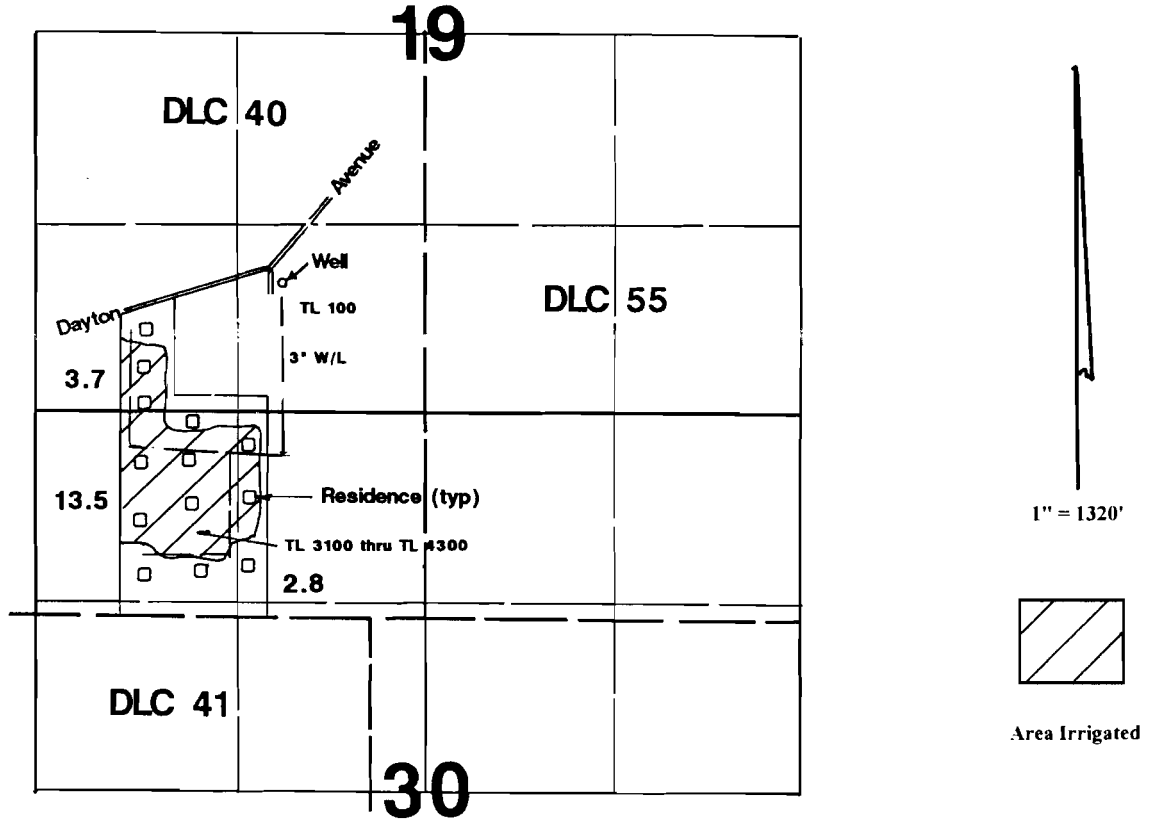

Well is located 850'N & 1700'E from the SW corner of Section 19.

## Application Map

# Hidden Meadows Water Assoc., Inc.

Application #: G-15247 Permit #:

This Map Was Prepared For The Purpose Of Identifying The Location Of A Water Right Only And Is Not Intended To Provide Legal Dimensions Or Location Of Property Ownership Lines.

