

T. 4S. R. 1W., W.M.

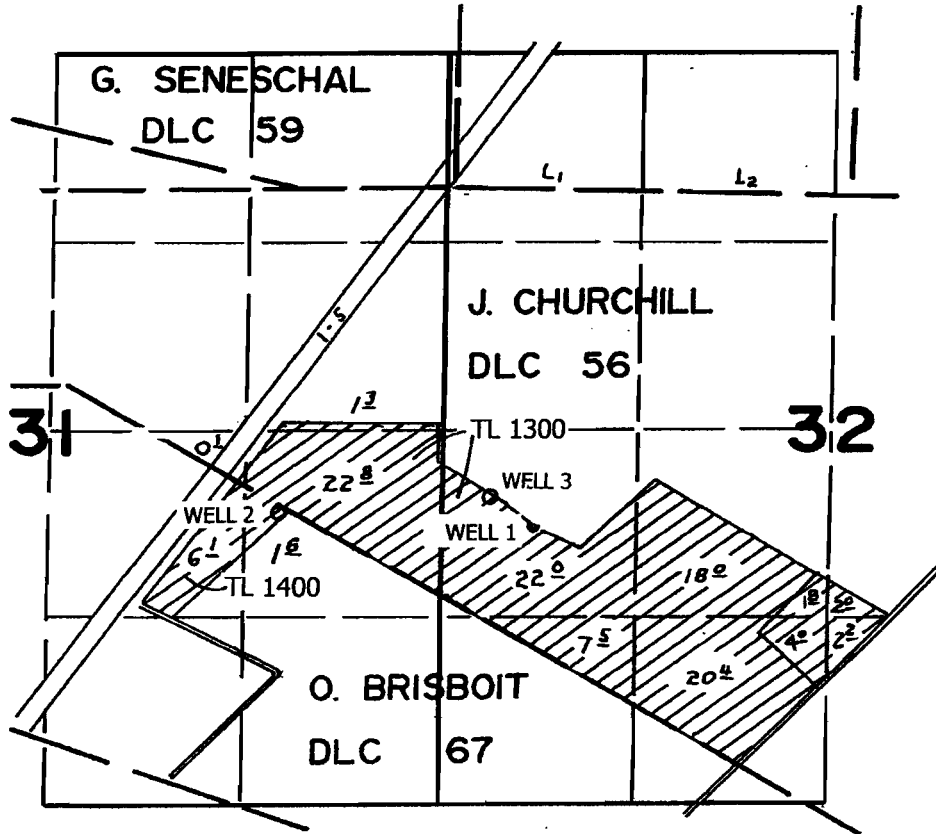

WELL 1: 690' south & 620' east
 WELL 2: 590' south & 1070' west
 WELL 3: 450' south & 340' east
 all from the West 1/4 corner section 32

Application Map for:

BIZON NURSERY

RECEIVED

JUL 19 2004

WATER RESOURCES DEPT
 SALEM, OREGON

Application #:

Permit #:

Don Knauer Consulting
 P.O. Box 5416
 Salem, OR 97304

Scale 4" = 1 mile