

**T 36 S, R 24 E, WM
Section 34**

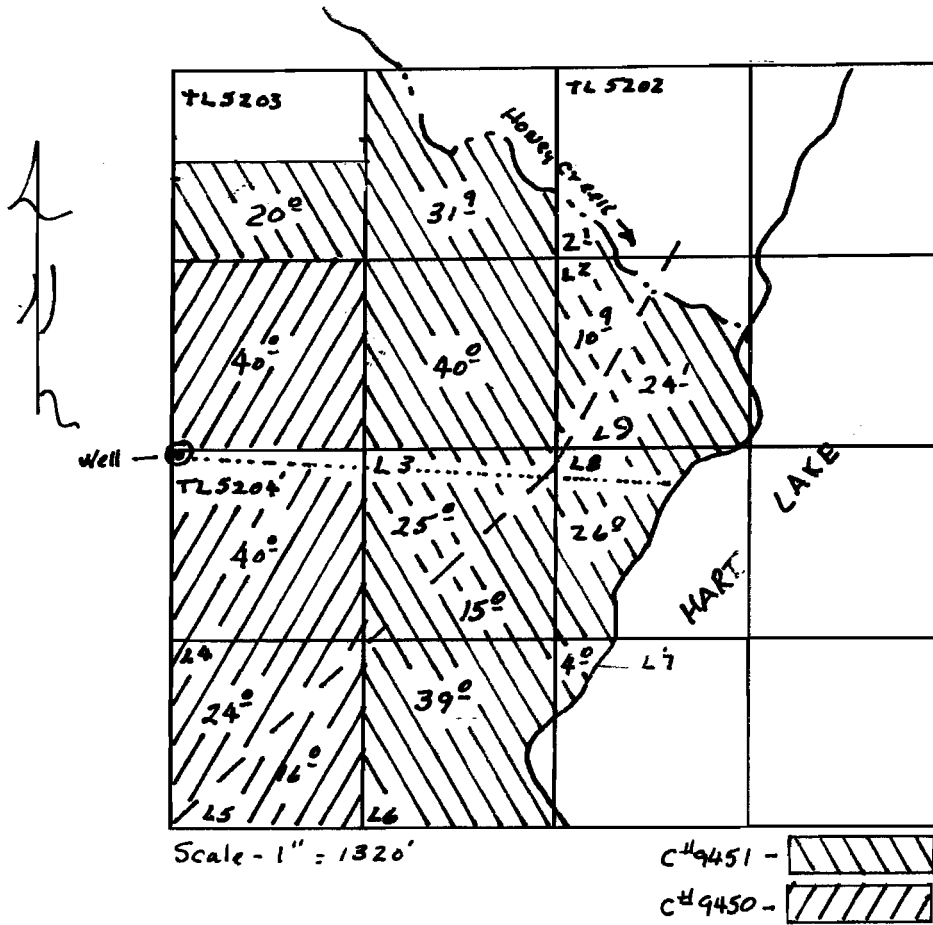

**Well located: NW 1/4 SW 1/4, Section 34, T 36 S, R 24 E,
50' South & 10 E from the W 1/4 Corner,
Section 34.**

RECEIVED
FEB 01 2005
WATER RESOURCES DEPT
SALEM, OREGON

app # G 16380