

Application Map
for
Glenn Butler



RECEIVED

MAR 18 2005

WATER RESOURCES DEPT
SALEM, OREGON

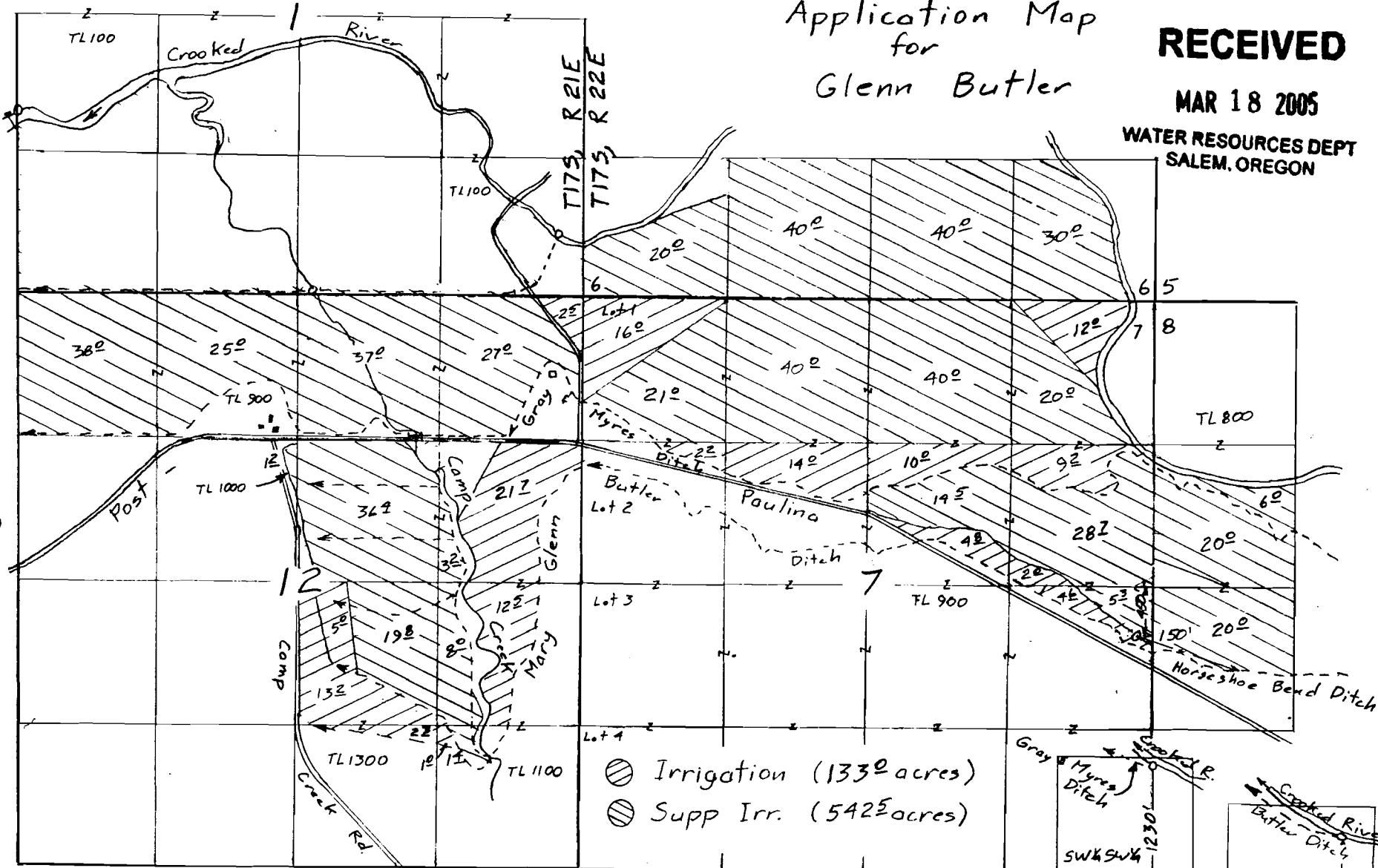
Scale
1"=1320'
(4"=1 mile)



-  Irrigation (1330 acres)
-  Supp Irr. (5425 acres)

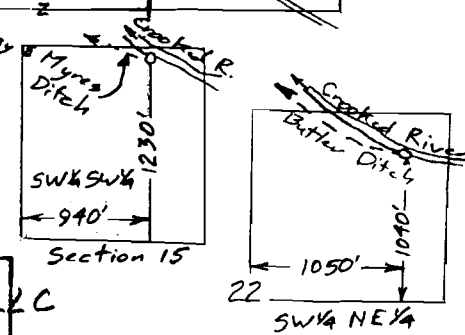

App G-16212

This map is for the purpose of locating a water right only and has no intent to provide legal dimensions or the location of property lines.

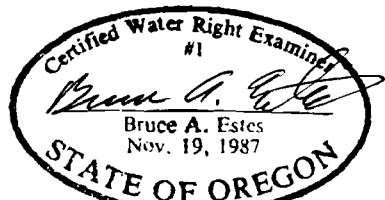

Renewal Dec 31, 2005

ESTES SURVEYS, LLC

PO Box 17519 60382 Arnold Rd
Salem, OR 97305-7519 Bend, OR 97702
(503) 585-7593 (541) 382-7391

Amended June 26, 2004