

WORKING COPY

Map for: Michelbook Country Club

Location:

The SE 1/4 of the NW 1/4, the NW 1/4 of the SW 1/4, the SW 1/4 of the SW 1/4, the SE 1/4 of the SW 1/4 Section 17, T. 4 S., R. 4 W., WM., Yamhill County, OR

RECEIVED

JAN 20 2005

WATER RESOURCES DEPT
SALEM, OREGON

Tax Lot: 4417 - 1400

Date : 20 Aug. 2004

Application No. _____



RECEIVED

MAR 10 2005

WATER RESOURCES DEPT
SALEM, OREGON

17

LEGEND:

-  = Property line
-  = Section line & "40" lines
-  = Proposed Well with Priority Number

I certify that the information I have provided in this application is an accurate representation of the proposed water use and is true and correct to the best of my knowledge. This map is to be used for the purpose of identifying the location of water right only and is not intended to provide legal dimensions or locations of property ownership lines.

Matt Dunckel

Matt Dunckel, CWRE
3765 Riverside Drive
McMinnville, Oregon 97128
Phone : 503-472-7904
Fax: 503-472-0367
Email: dunckel@viclink.com



Scale: 1" = 660'

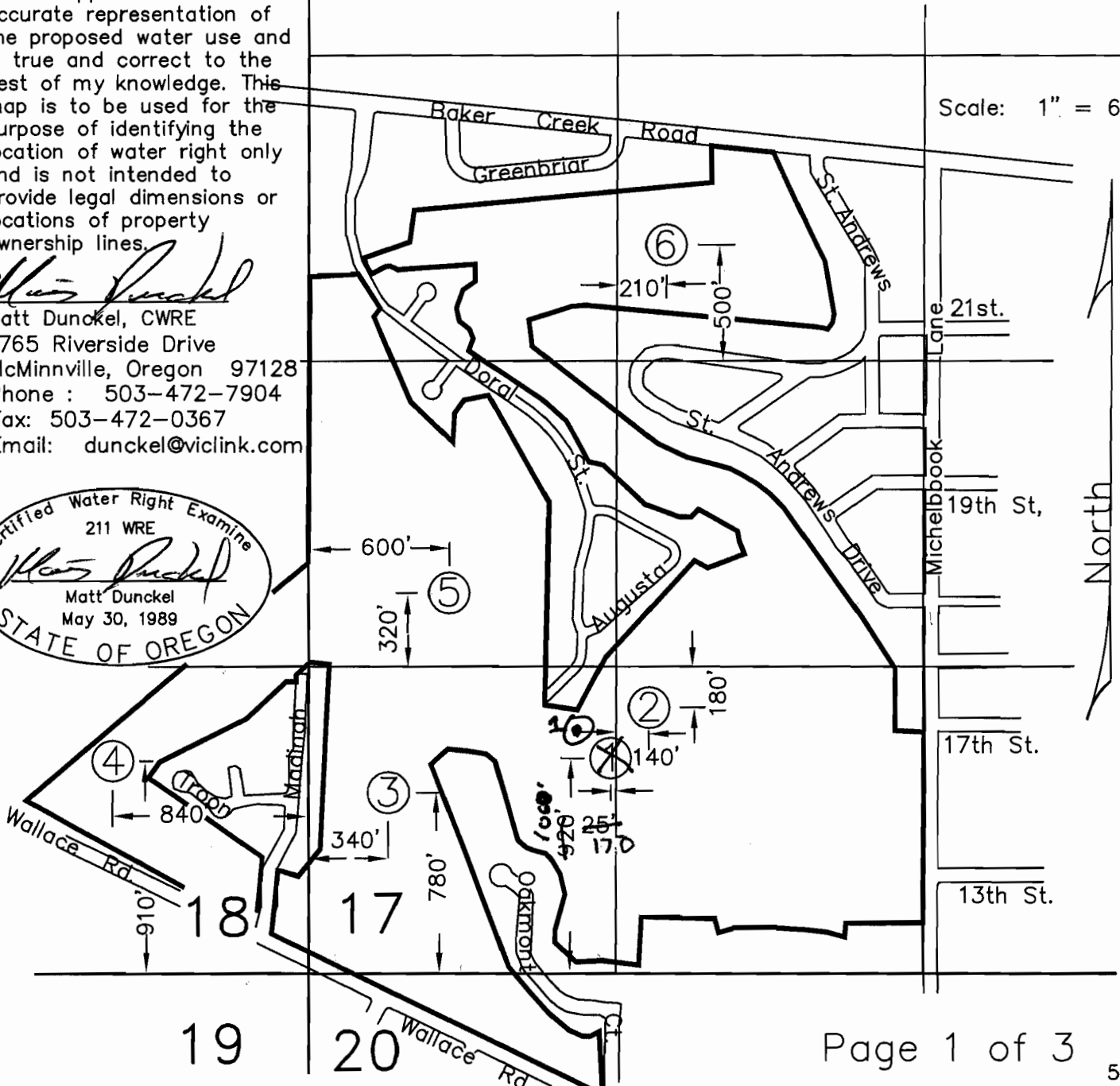

Map for: Michelbook Country Club

Location:





The SE 1/4 of the NW 1/4, the NW 1/4 of the SW 1/4, the SW 1/4 of the SW 1/4, the SE 1/4 of the SW 1/4 Section 17, T. 4 S., R. 4 W., WM., Yamhill County, OR

Tax Lot: 4417 - 1400

Date : 20 Feb. 2005

Application No. _____

LEGEND:

-  = Property line
-  = D.L.C. line
-  = Section line
-  = "40" line

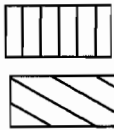

- = area of new water rights being applied for under this application
- = area of existing water rights under Application G-11038, R-63048 & 630149, Permit No. G-10202, R-8344 & 46419 in the name of MICHELBOOK ESTATES, INC.

Scale: 1" = 660'

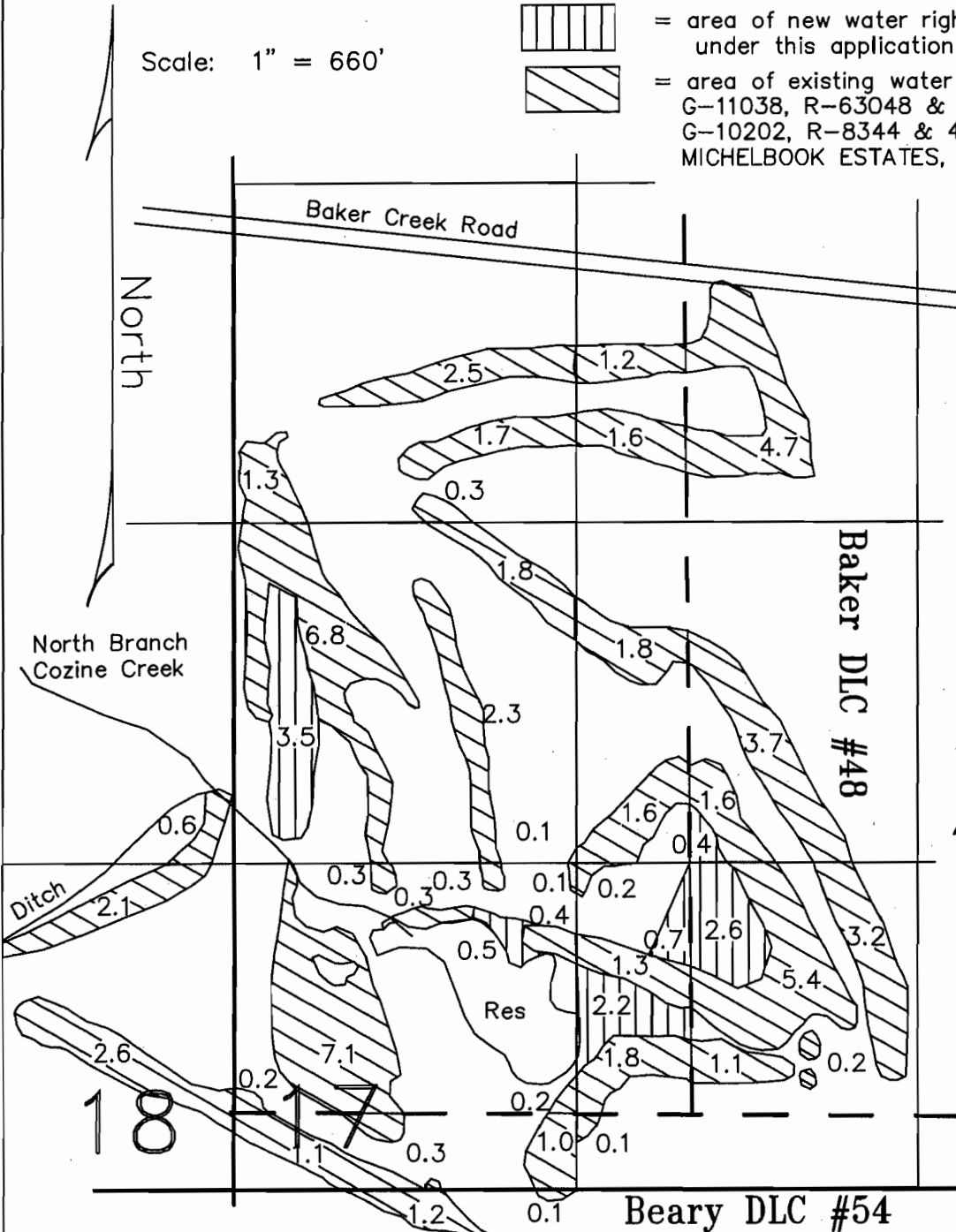
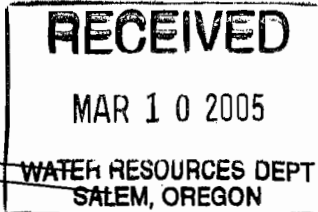

I certify that the information I have provided in this application is an accurate representation of the proposed water use and is true and correct to the best of my knowledge. This map is to be used for the purpose of identifying the location of water right only and is not intended to provide legal dimensions or locations of property ownership lines.

Matt Dunckel

Matt Dunckel
3765 Riverside Drive
McMinnville, Oregon 97128
Phone : 472-7904



19 app no 8-16410