

SOUTHERN PORTION of SECTION 18, T3S, R1E Willamette Meridian CLACKAMAS COUNTY, OREGON

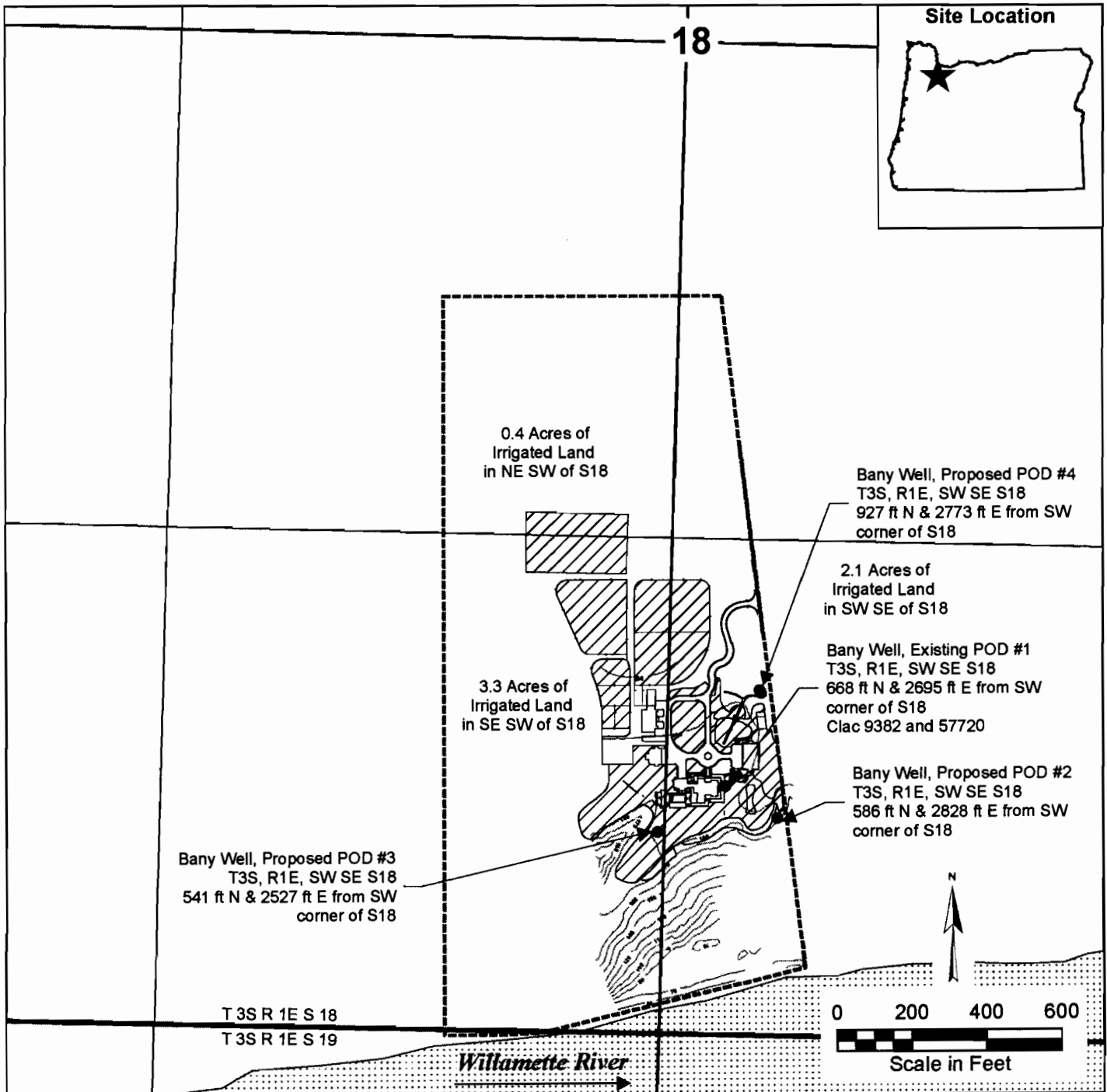

- Legend**
- Property Boundary
T3S, R1E, S18, Taxlot 03100
 - Irrigated Land and 1/4 1/4 section irrigated acreage
 - Willamette River
 - Paved Road

APPLICATION NUMBER: G-16556
IN THE NAME OF: Dave Bany
 5442 SW Kruse Way
 Wilsonville, OR 97070

Exhibit A
 Water Rights Application Map
 Bany Property
 October 2005

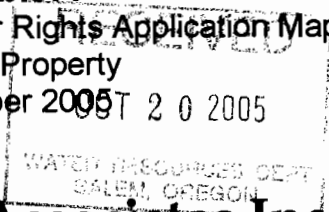

THIS MAP WAS PREPARED FOR THE PURPOSE OF IDENTIFYING THE LOCATION OF THE WATER RIGHTS ONLY, AND NOT INTENDED TO PROVIDE LEGAL DIMENSIONS OR THE LOCATION OF PROPERTY OWNERSHIP LINES.