

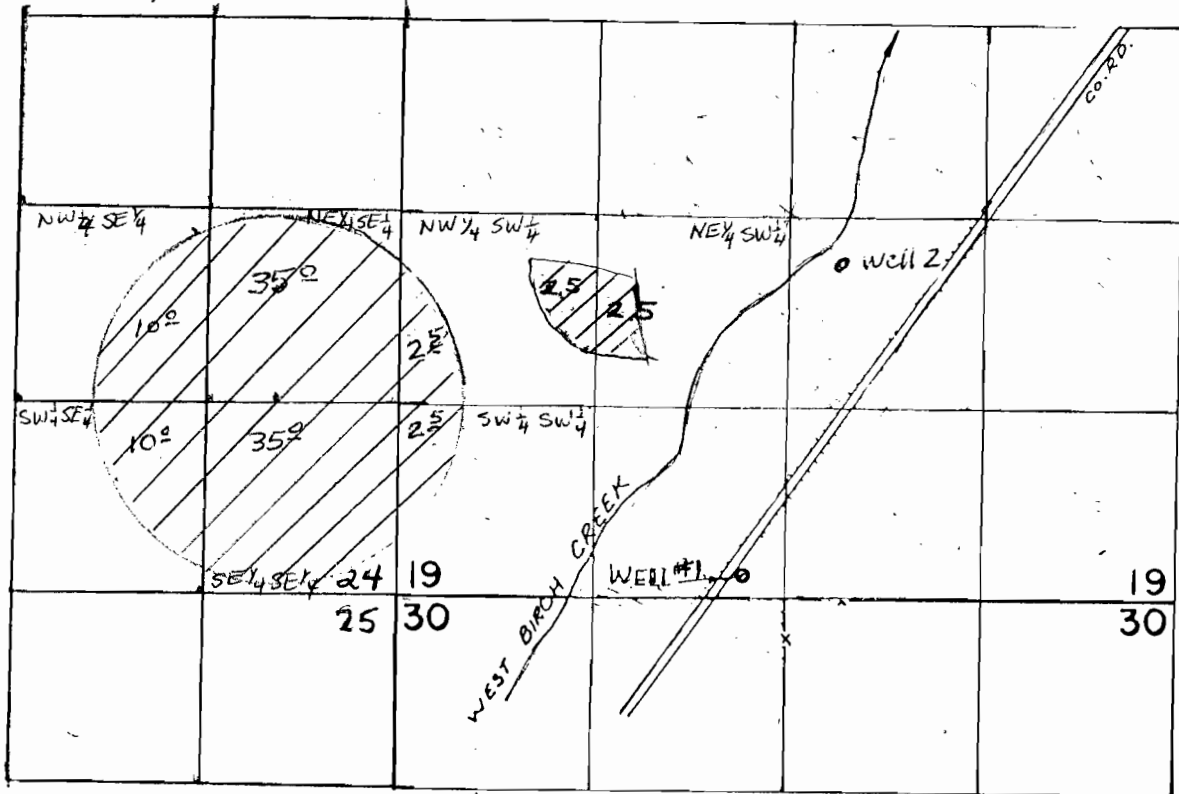

T.1S.R.32E.W.M.

1" = 1320'

T.1S, R.31E



WELL #1 LOC: 170' N. & 300' W FROM S 1/4 COR. SEC. 19
 Well #2 LOC: 2300' N + 500' W from S 1/4 Sec. 19
 EAST

Proposed Irrigation 
 Section 24, T.1S, 31E

10^o acres = NW 1/4 SE 1/4
 35^o acres = NE 1/4 SE 1/4
 10^o acres = SW 1/4 SE 1/4
 35^o acres = SE 1/4 SE 1/4

Section 19, T.1S, 32E

2.5 acres = NE 1/4 SW 1/4
 5.0 acres = NW 1/4 SW 1/4
 2.5 acres = SW 1/4 SW 1/4

app no G-16575

RECEIVED

NOV 30 2005

WATER RESOURCES DEPT
 SALEM, OREGON