

RECEIVED

DEC 30 2005

WATER RESOURCES DEPT
SALEM, OREGON

T 3 S, R 5 W, WM

YAMHILL COUNTY

TAX LOT:
3 5 12 800

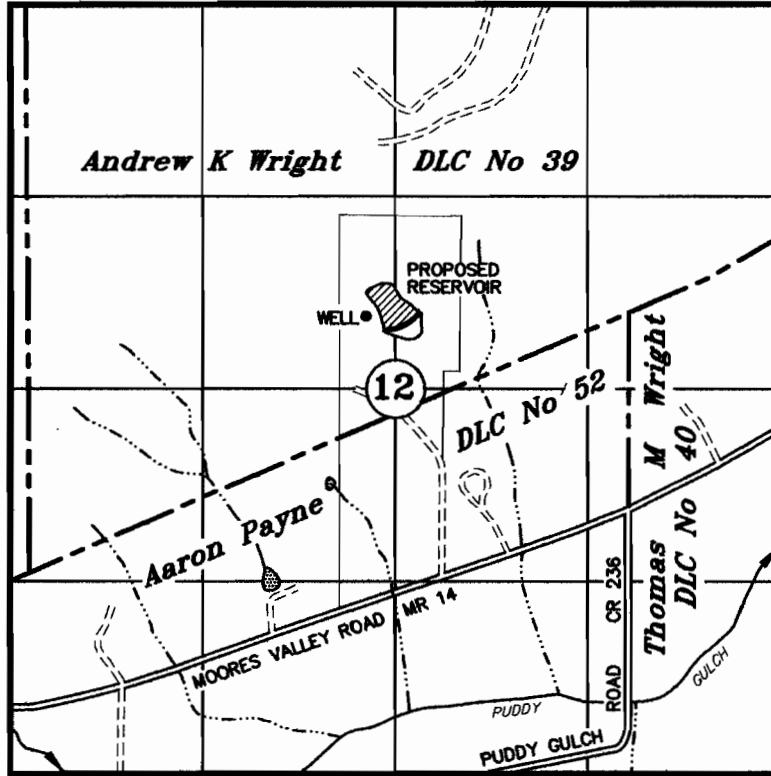

WELL: 25' N AND 1800' W OF THE NE CORNER AARON PAYNE DLC 52

APPLICATION TO APPROPRIATE GROUNDWATER

UNDER

Application No. G-16590

Permit No. _____

IN THE NAME OF

Gary & Doris Hasson

December 28, 2005

SCALE: 1" = 1320'



NOTE: This map is not intended to provide legal dimensions or locations of property ownership lines.

EXPIRES 12-31-07