

RECEIVED

FEB 06 2006

T.4S. R.2W. Sec. 31, 32 & 33, W.M.

WATER RESOURCES DEPT.
SALEM, OREGON

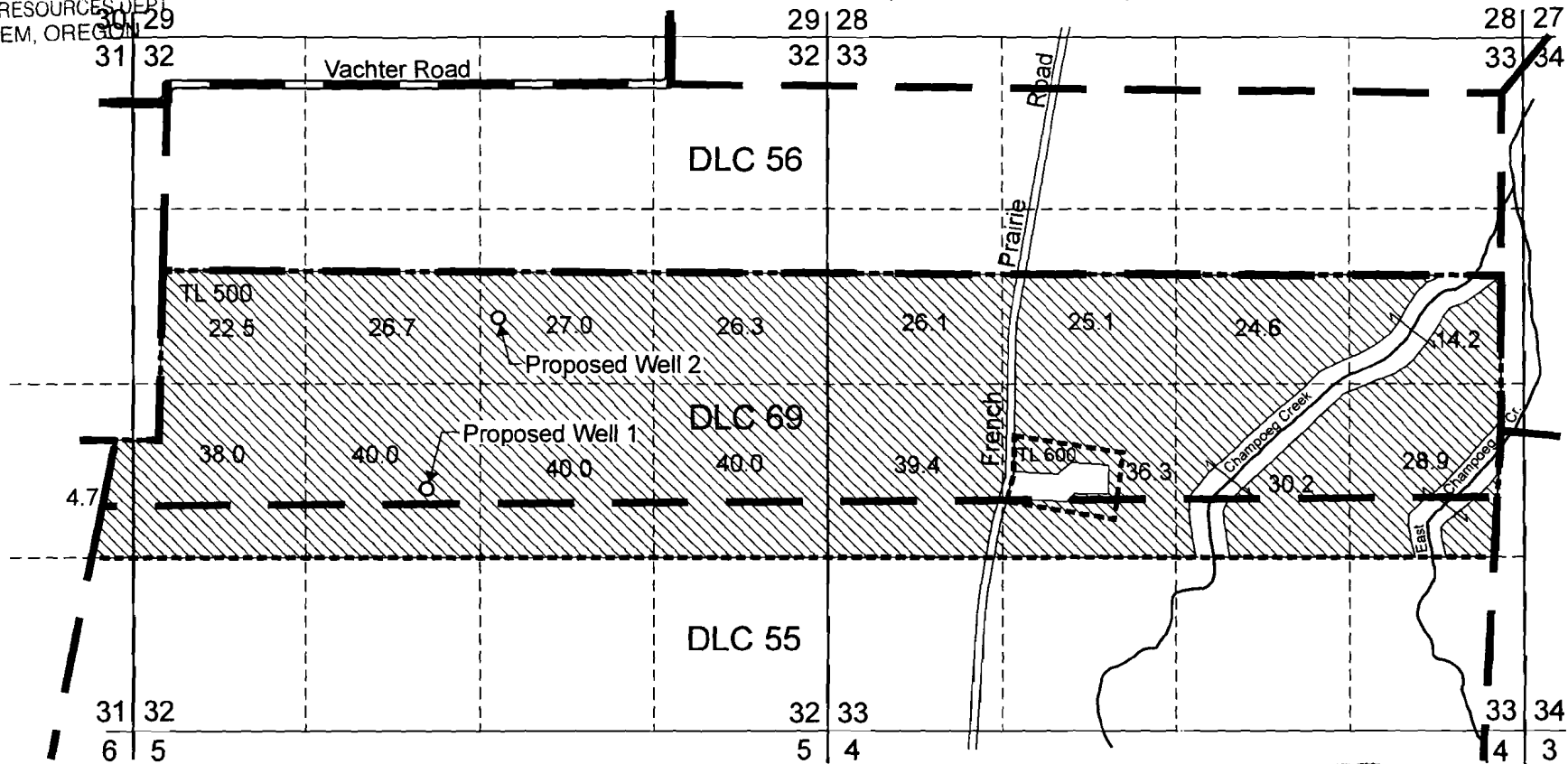

Proposed Well 1 is located 1,840 feet north and 2,240 feet east from the SW corner, Section 32.
Proposed Well 2 is located 3,140 feet north and 2,780 feet east from the SW corner, Section 32.

 Area (490.0 Acres) to be covered for nursery operations.

Scale: 1" = 1,320'

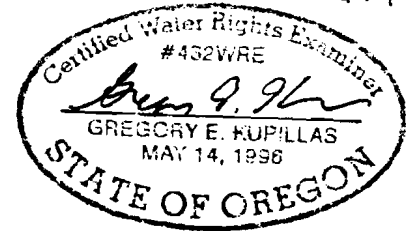
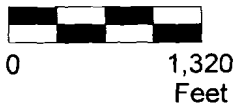

EXPIRATION DATE: 6/30/07

This map was prepared for the purpose of identifying the location of a water right only and is not intended to provide legal dimensions or location of property ownership lines.

Pacific Hydro-Geology Inc.

Water Right Application Map

Pohlschneider Farms
T.4S. R.2W. Sec. 31, 32, and 33, W.M.

Revised 2/2006

PohlschneiderAppRvysd.cdr