

T4S R1W W.M.
T5S R1W W.M.

RECEIVED

JUL 01 2005

WATER RESOURCES DEPT
SALEM, OREGON

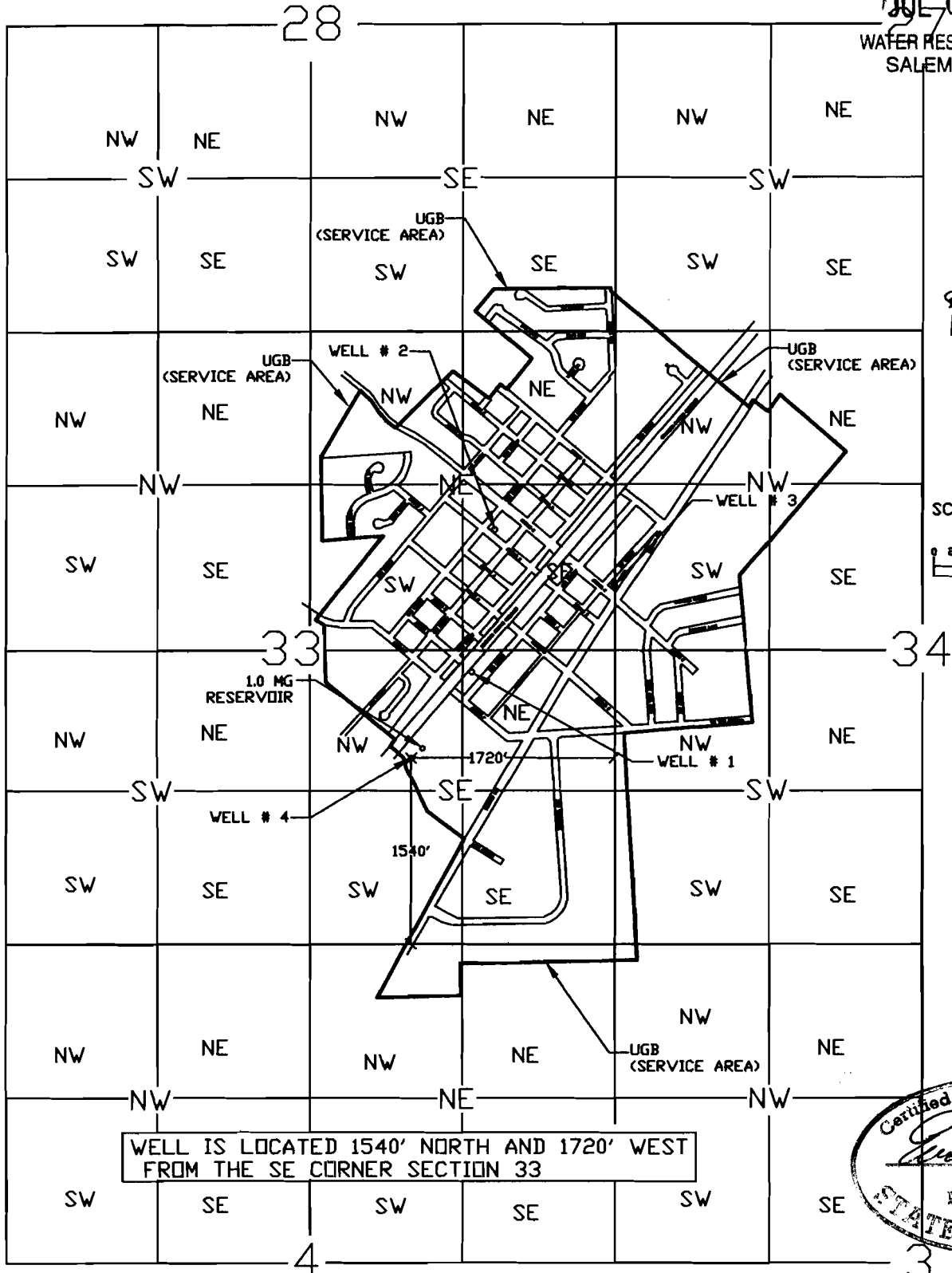

WELL IS LOCATED 1540' NORTH AND 1720' WEST FROM THE SE CORNER SECTION 33

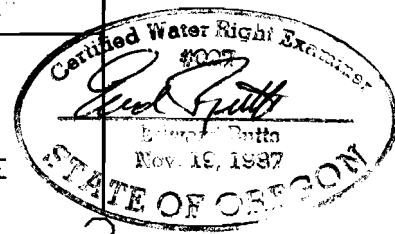

THIS MAP WAS PREPARED FOR THE PURPOSE OF IDENTIFYING THE LOCATION OF A WATER RIGHT ONLY AND IS NOT INTENDED TO PROVIDE LEGAL DIMENSIONS OR LOCATION OF PROPERTY OWNERSHIP LINES.

APPLICATION MAP FOR
CITY OF HUBBARD
JULY 1, 2005

APPLICATION G-16491 PERMIT NO. _____