

T. 27 S.,
R. 36 E.,
W.M.

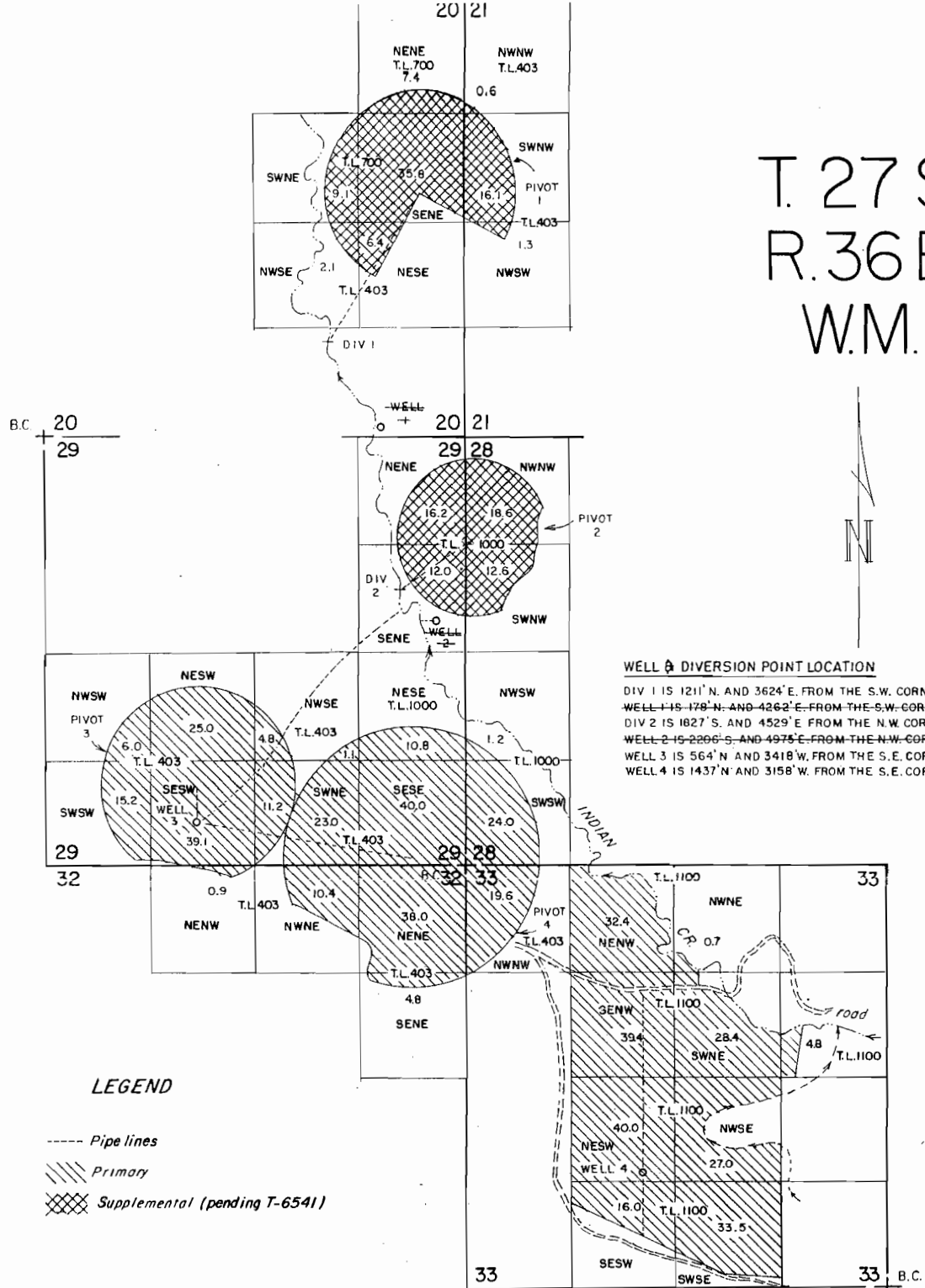

WELL & DIVERSION POINT LOCATION
 DIV 1 IS 1211' N. AND 3624' E. FROM THE S.W. CORNER OF SEC. 20.
 WELL 1 IS 178' N. AND 4262' E. FROM THE S.W. CORNER OF SEC. 20.
 DIV 2 IS 1827' S. AND 4529' E. FROM THE N.W. CORNER OF SEC. 29.
 WELL 2 IS 2266' S. AND 4975' E. FROM THE N.W. CORNER OF SEC. 29.
 WELL 3 IS 564' N. AND 3418' W. FROM THE S.E. CORNER OF SEC. 29.
 WELL 4 IS 1437' N. AND 3158' W. FROM THE S.E. CORNER OF SEC. 33.

LEGEND

- Pipe lines
- //// Primary
- XXXX Supplemental (pending T-6541)

WELL 1 & 2 are to be deleted.
 WELL 3- Pivots 1-4
 WELL 4- wheel lines in Sec. 33

THE PURPOSE OF THIS MAP IS TO IDENTIFY THE LOCATION OF THE WATER RIGHT. IT IS NOT INTENDED TO PROVIDE INFORMATION RELATIVE TO THE LOCATION OF PROPERTY OWNERSHIP.

	TREE TOP RANCHES, LLP WATER RIGHT APPLICATION MAP		
	Scale: 4" = 1 MILE	Date: JAN 2006	Job: 1248-06
	Dsn:	M. A. PALMER & SONS, INC. ENGINEERING & SURVEYING 254 N. Alder - Box 61 Burns, Oregon 97720	Sht. No.
	Drm: CHRIS		of 1
Ckd:			

RECEIVED
 FEB 17 2006
 WATER RESOURCES DEPT
 SALEM, OREGON

appno G-16620