

APPLICATION MAP IN THE NAME OF

Nibler Family LLC

T 5 S R 2 W, W.M.
Portion of Section 9

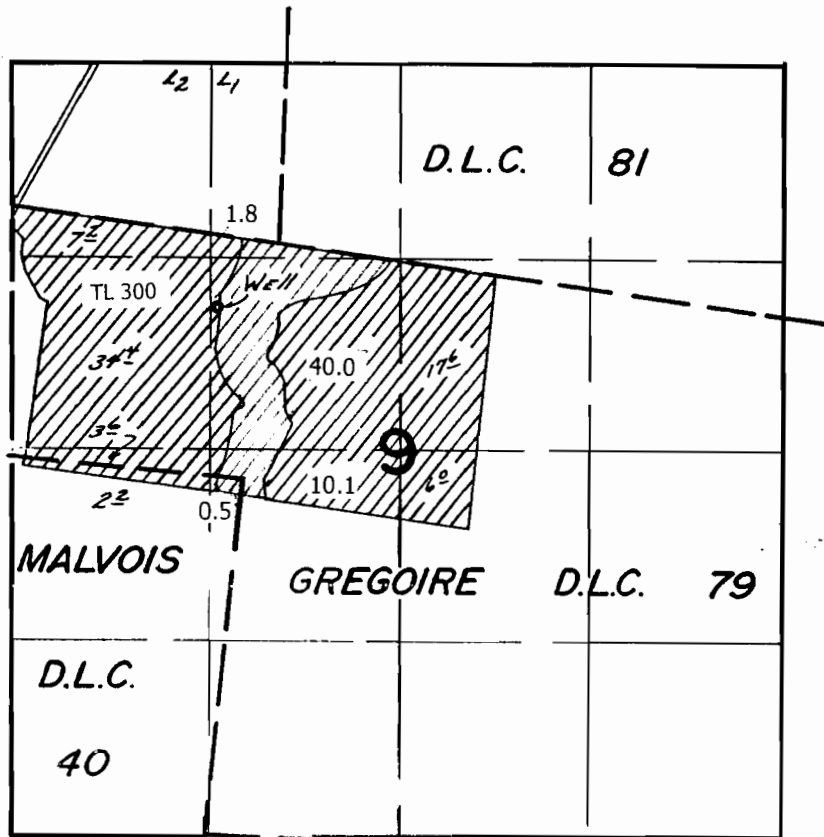
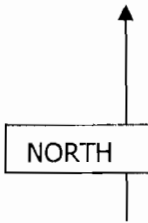

Well Loc. - 1670' S & 1380' E from NW Cor. Sec. 9

scale 1" = 1320'

RECEIVED

NOV 18 2005

WATER RESOURCES DEPT
SALEM, OREGON

Don Knauer Consulting
PO Box 5416
Salem, OR 97304
503-585-8474

app no G-116568

123