

T.4S. R.2E. Sec. 32 & 33, and T.5S. R.2E. Sec. 4 & 5, W.M.

RECEIVED

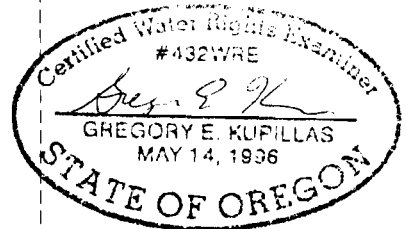
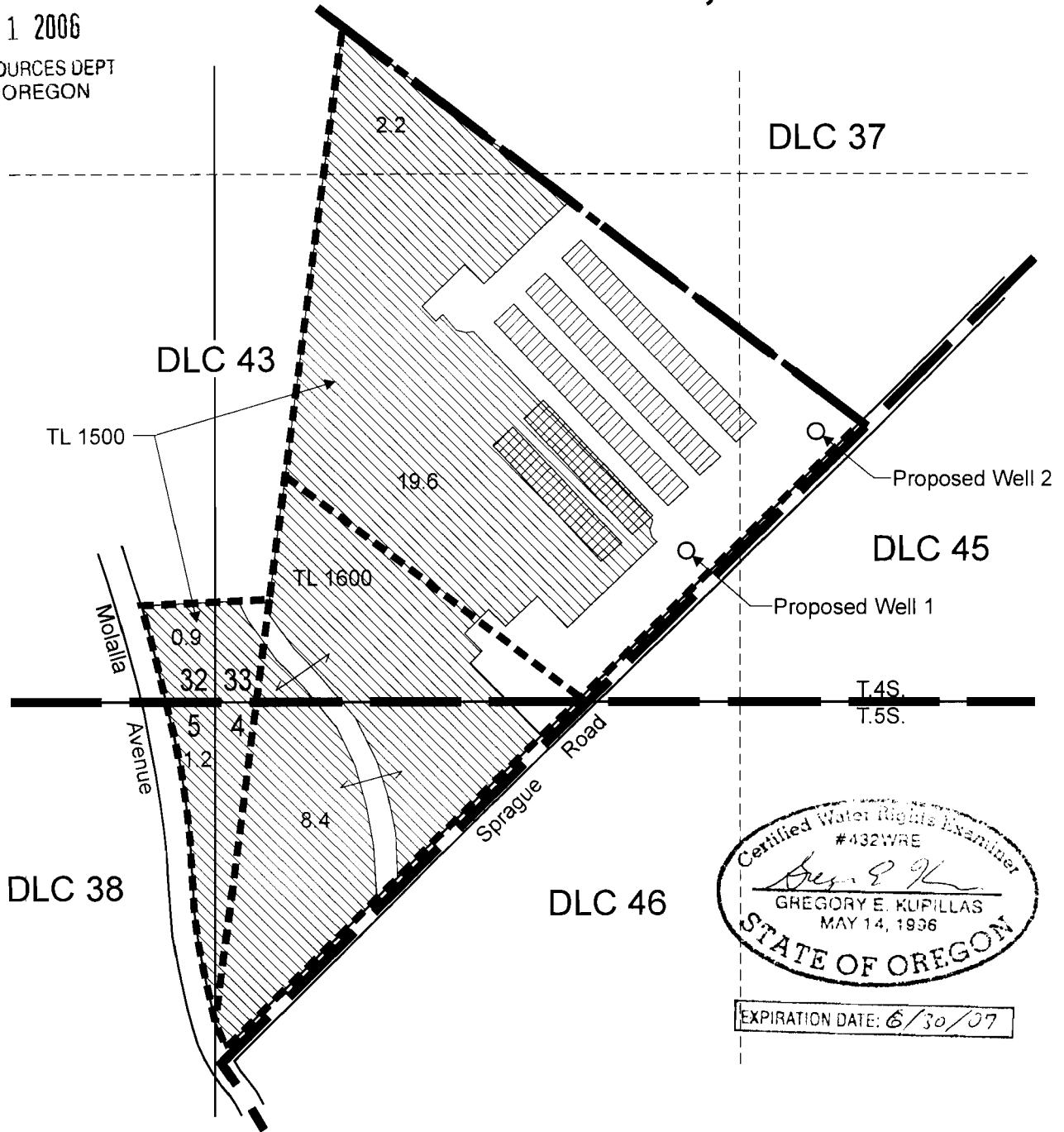

SEP 21 2006

WATER RESOURCES DEPT
SALEM, OREGON



EXPIRATION DATE: 6/30/07

Proposed Well 1 is located 380 feet north and 1,190 feet east from the SW corner of Section 33.
Proposed Well 2 is located 680 feet north and 1,510 feet east from the SW corner of Section 33.

-  Area (32.3 Acres) to be covered under nursery operations.
-  Proposed Commercial Use
-  Tax lot boundary

Scale: 1" = 400'



This map was prepared for the purpose of identifying the location of a water right only and is not intended to provide legal dimensions or location of property ownership lines.



Water Right Application Map

Tuan Tiet
Tax Lots 4 2E 33 1500 and 4 2E 33 1600

Pacific Hydro-Geology Inc.

9/2006

TietAppMap.cdr

appncg-16738