

TOWNSHIP 26 NORTH/SOUTH

RECEIVED

JAN 24 2006

WATER RESOURCES DEPT
SALEM, OREGON

RANGE 33 EAST/WEST

SECTION 35

TAX LOT 7700



NORTH ARROW

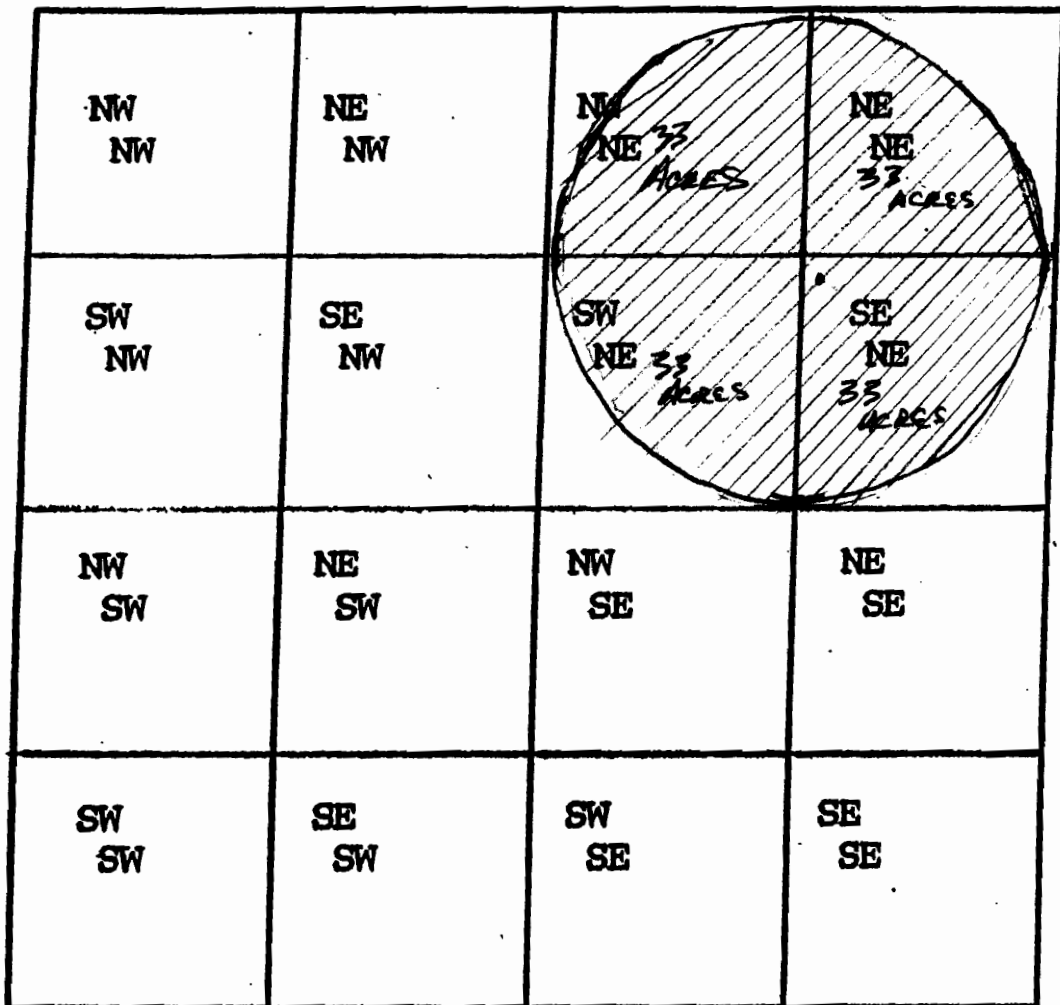

- WELL LOCATION -
IS 60' SOUTH & 60' EAST OF
CENTER ON N.E. 1/4

1 INCH = 1000 FEET

T. 26 & 27 S., R. 33 E., W.M.

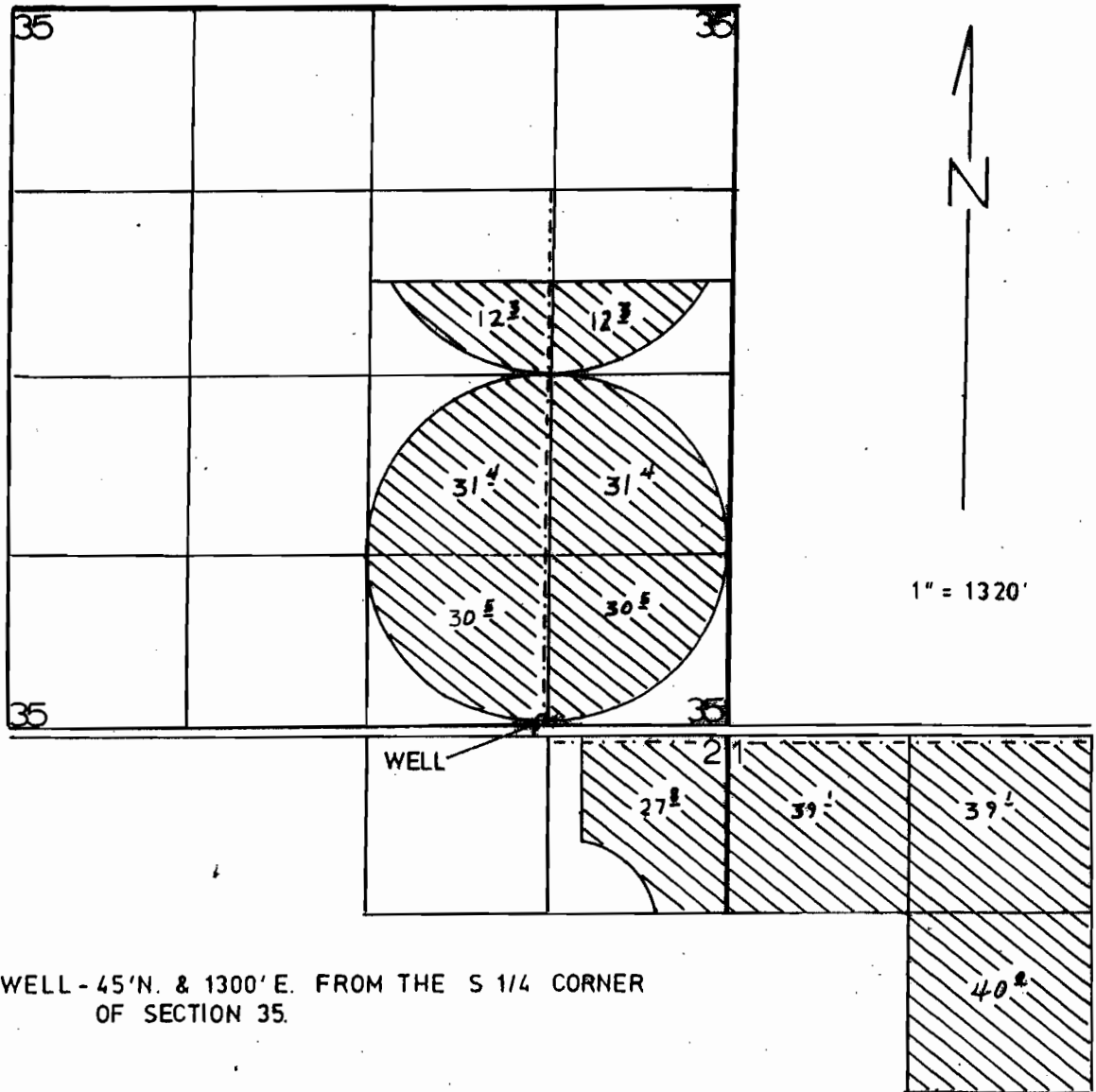

WELL - 45' N. & 1300' E. FROM THE S 1/4 CORNER
OF SECTION 35.

FINAL PROOF SURVEY
UNDER

Application No. G-9182 Permit No. G-8527
IN NAME OF

certificate 82697

FRED KREGER AND WALTER KREGER

Surveyed AUGUST 6, 1993, by I. MILLER

T. 26 S., R. 33 E., W.M.

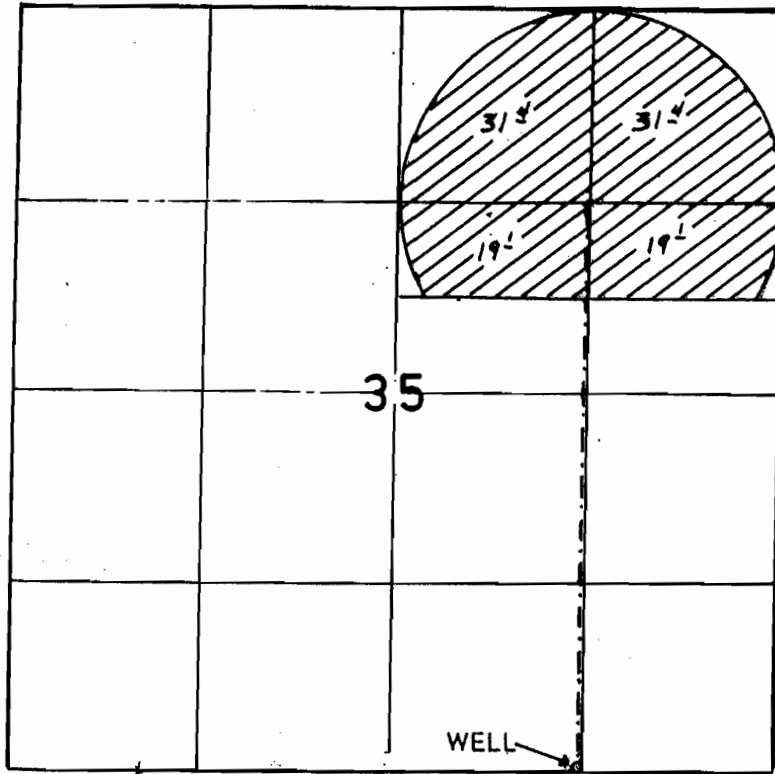

WELL - 45' N. & 1300' E. FROM THE S 1/4 COR. SECTION 35.

FINAL PROOF SURVEY

UNDER

Application No. G-10013 Permit No. G-9160
IN NAME OF

certificate 82698

FRED KREGER

Surveyed AUGUST 6, 1993, by L. MILLER