

T.6S. R.1E. Sec. 27, 33 & 34, W.M.

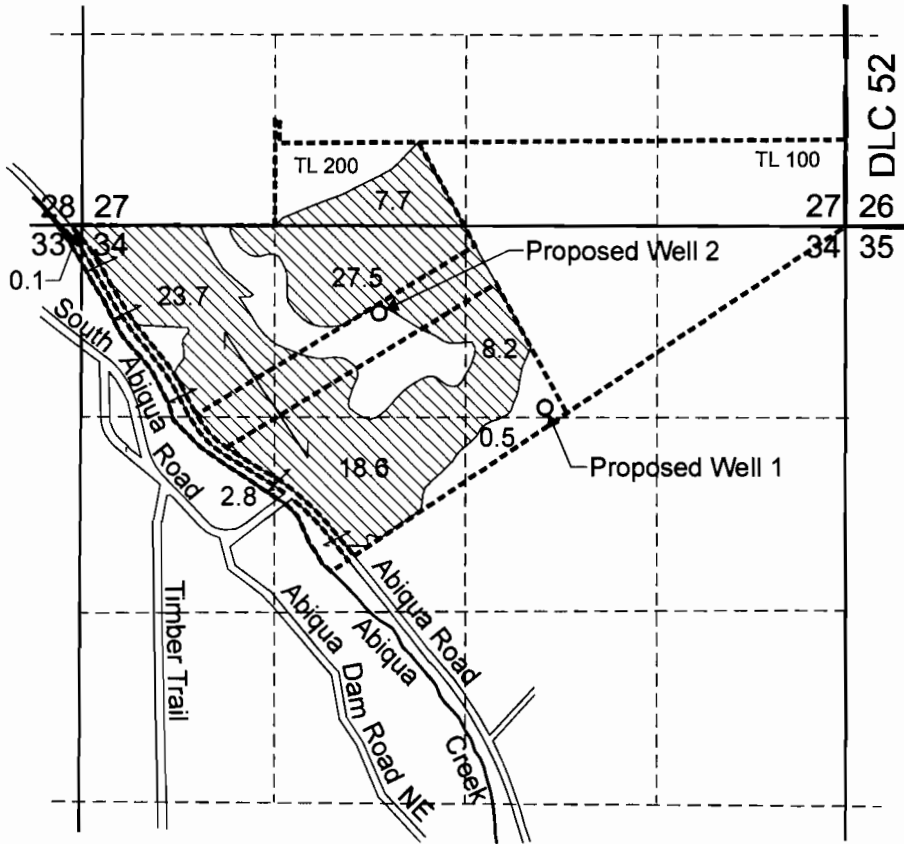

Proposed Well 1 is located 1,250 feet south and 2,060 feet west from the NE corner of Section 34.
 Proposed Well 2 is located 600 feet south and 2,050 feet east from the NW corner of Section 34.

Area (89.1 Acres) to be irrigated.

Tax lot boundary

RECEIVED

AUG 25 2005

WATER RESOURCES DEPT
 SALEM, OREGON

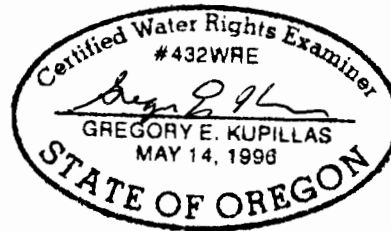

EXPIRATION DATE: 6/19/05

Scale: 1" = 1,320'

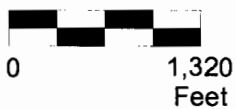

This map was prepared for the purpose of identifying the location of a water right only and is not intended to provide legal dimensions or location of property ownership lines.



Water Right Application Map

Paul Kraemer
 T.6S. R.1E. Sec. 27, 33, and 34, W.M.

Pacific Hydro-Geology Inc.

5/2005

PKraemerHmGWApp.cdr

app NOG-16518