

RECEIVED

AUG 16 2006

WATER RESOURCES DEPT
SALEM, OREGON

T.8S. R.2W. Section 10

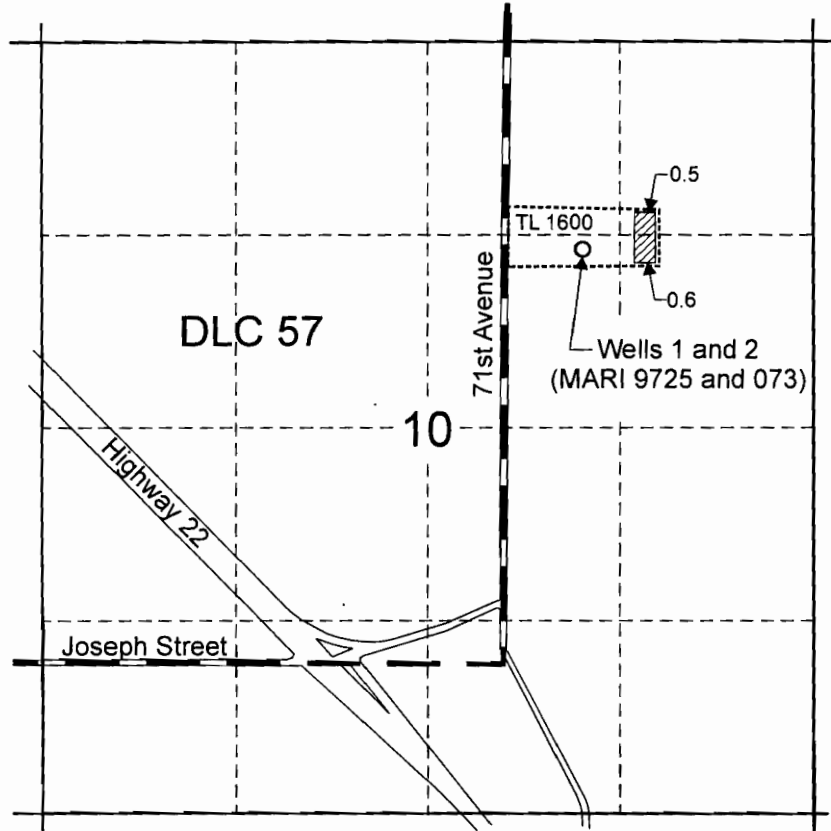

Well 1 (MARI 9725), is located 2,830 feet north and 550 feet east from the SE corner of DLC 57.
 Well 2 (MARI 073), is located 2,838 feet north and 550 feet east from the SE corner of DLC 57.

 Area (1.1 Acres) proposed for supplemental irrigation

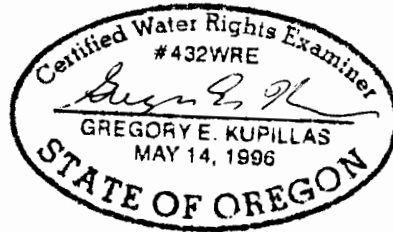

EXPIRATION DATE: 6/30/07

Scale: 1" = 1,320'

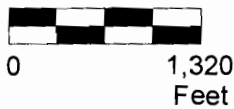

This map was prepared for the purpose of identifying the location of a water right only and is not intended to provide legal dimensions or location of property ownership lines.



Water Right Application Map

Larry Manning
Tax Lot 8 2W 10A 1600

Pacific Hydro-Geology Inc.

06/2006

ManningAppMap.cdr

app no G-16709